

# QUICK RELEASE TRUNK KIT



P/N 2884046-XXX

## BEFORE YOU BEGIN

Read these instructions and check to be sure all parts and tools are accounted for. Please retain these installation instructions for future reference and parts ordering information.

## APPLICATION

Verify accessory fitment at [www.indianmotorcycle.com](http://www.indianmotorcycle.com).

### IMPORTANT

This kit is not compatible with the Pinnacle Solo Luggage Rack Kit PN 2883403-XXX

## REQUIRED SOLD SEPARATELY

The Indian Motorcycle® Quick Release Trunk Kit contains parts for installation of the Indian Motorcycle® Quick Release Trunk Kit only. Installation of the following addition kit is also required (sold separately):

- *Trunk Frame Kit*, P/N 2884048-XXX
- *Trunk Base Kit*, P/N 2889605-XXX
- *Trunk Backrest Pad Kit*, P/N 2880284-XXX, 2881009-XXX, 2889056-XXX

## TRUNK BASE KIT, P/N 2889605-XXX

### NOTICE

XXX = Indian Motorcycle® color code (For example: 463= Black)

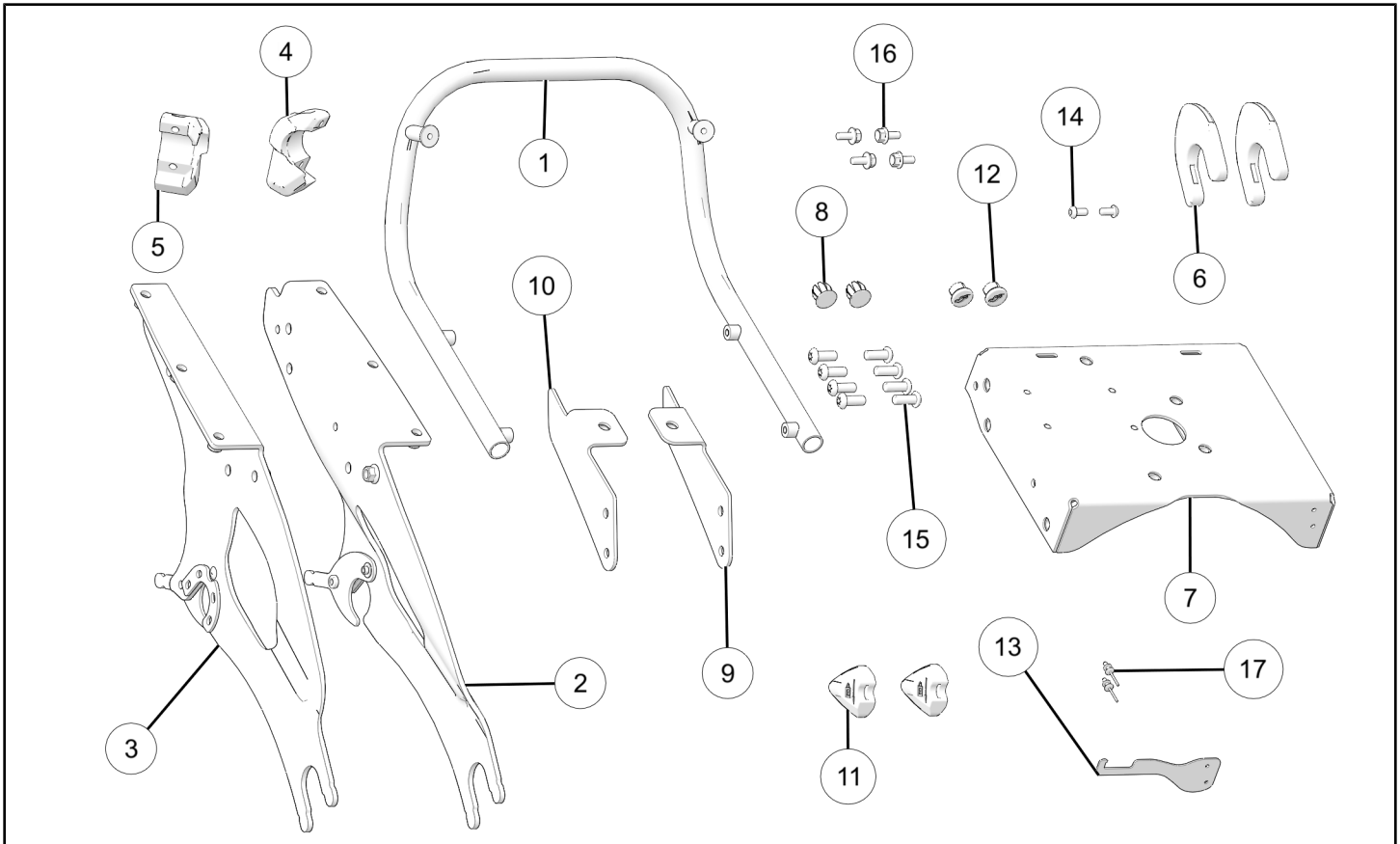

REF	QTY	PART DESCRIPTION	P/N AVAILABLE SEPARATELY
1	1	Weld-Bumper, Trunk	1023874
2	1	Side Plate, Left	5141919
3	1	Side Plate, Right	5141920
4	1	Bracket-Perch, Clamp, Left	1914129
5	1	Bracket-Perch, Clamp, Right	1914130
6	2	Isolator, Front	5418029
7	1	Support-Trunk, Center	5139657-463
8	2	Cap-Tubing, 3/4 in OD x 5/8 in ID	n/a
9	1	Bracket-Trunk, Left (not used)	n/a
10	1	Bracket-Trunk, Right (not used)	n/a
11	2	Grip-Lock Lever	5414785
12	2	Plug-Pass Backrest	n/a
13	1	Retainer, Wire	5815220
14	2	Screw, Hex Button Head, M6 x 1.0 x12 mm	7519000
15	8	Screw, Torx®, M8 x 1.25 x 20 mm	7520127
16	4	Screw, Hex Flanged, M6 x 1.0 x14 mm	7520143
17	2	Rivet	7621235

## KIT CONTENTS

### NOTICE

XXX = Indian Motorcycle® color code (For example: 266 = Black)

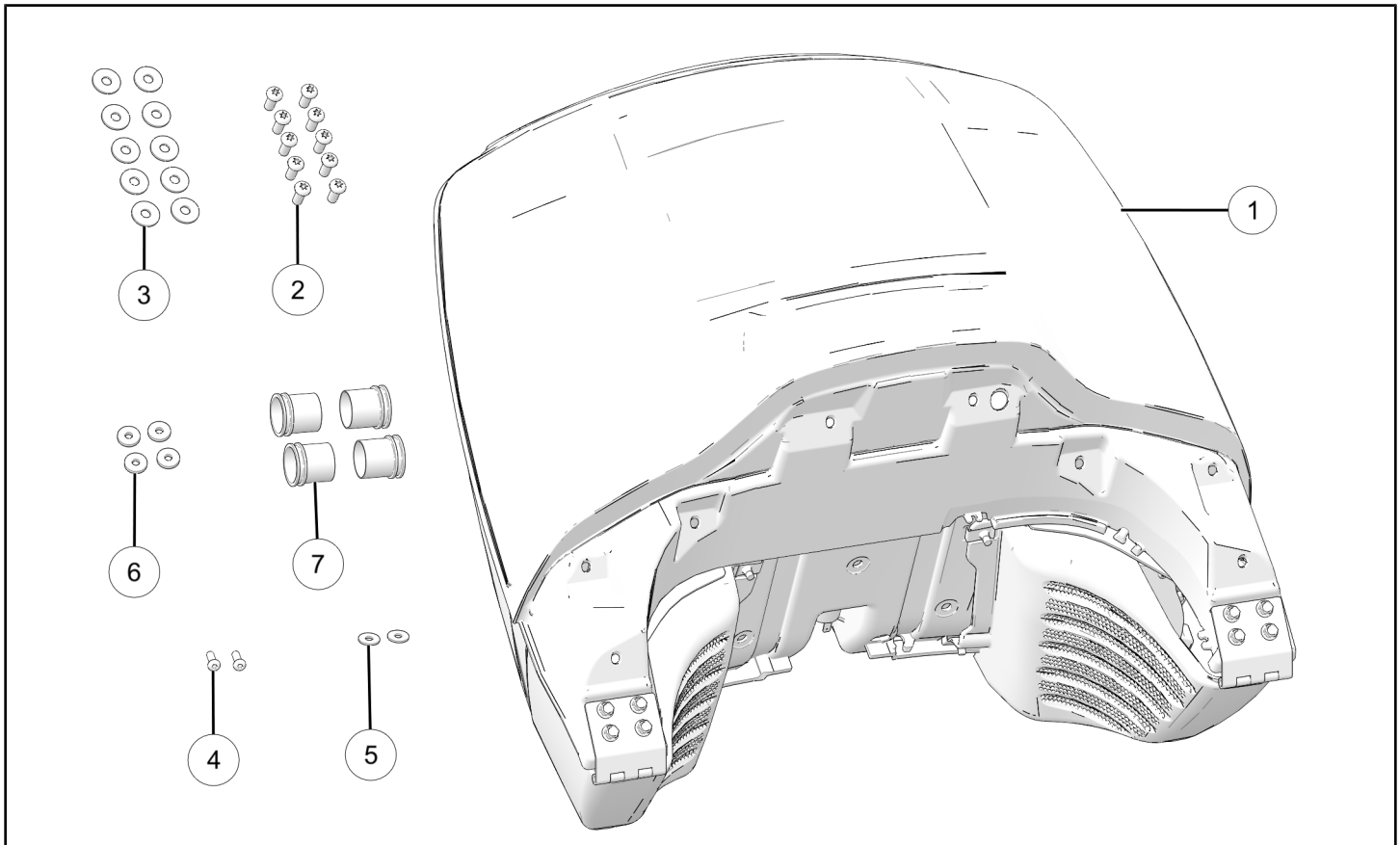

REF	QTY	PART DESCRIPTION	P/N AVAILABLE SEPARATELY
1	1	Assembly, Trunk	n/a
2	10	Screw, Torx® Button Head, M8 x 1.25 x 20 mm	7520127
3	10	Washer, Steel, M8	7556459
4	2	Screw, Hex Head, M6 x 1.0 x 20 mm	7517782
5	2	Washer, 6.4 x 18 x 1.6 mm	7556064
6	4	Washer, Rubber, 6.35 x 19 x 3.2 mm	5814206
7	4	Bushing, Spool, Trunk	5455069

## TOOLS REQUIRED

- Safety Glasses
- Socket Set, Torx® Bit
- Socket Set, Hex Bit, Metric
- Torque Wrench

## IMPORTANT

Your Indian Motorcycle® Quick Release Trunk Kit is exclusively designed for your vehicle. Please read the installation instructions thoroughly before beginning. Installation is easier if the vehicle is clean and free of debris. For your safety, and to ensure a satisfactory installation, perform all installation steps correctly in the sequence shown.

# INSTALLATION INSTRUCTIONS

## VEHICLE PREPARATION

### GENERAL

1. Park vehicle on a flat surface.
2. Make sure kickstand is fully extended and vehicle is stable.
3. Turn key or ignition switch to **OFF** position and remove key. If equipped with keyless fob, remove fob from proximity of vehicle.
4. Install trunk mounting spools from *Trunk Base Kit P/N 2890502* (sold separately).
5. Install *Trunk Frame Kit, P/N 2884048* (sold separately) onto bike.

### FENDER CLOSEOUT REMOVAL (IF EQUIPPED)

1. Lift front edge, then rear edge of fender closeout to remove. Carefully set aside and retain, do not discard.

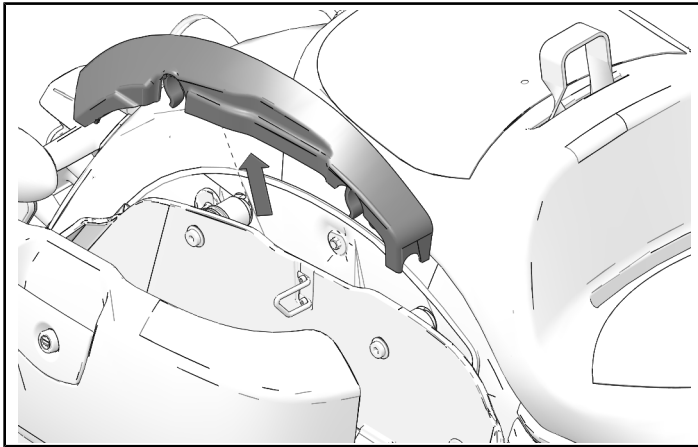

## ALL AIR-COOLED HEAVYWEIGHT BIKES

### SIDE COVER REMOVAL

#### NOTICE

Left side shown; right side similar.

#### CAUTION

Protect painted surfaces with protective cloth during installation.

1. Remove side covers by holding firmly and pulling outward. Carefully set aside.

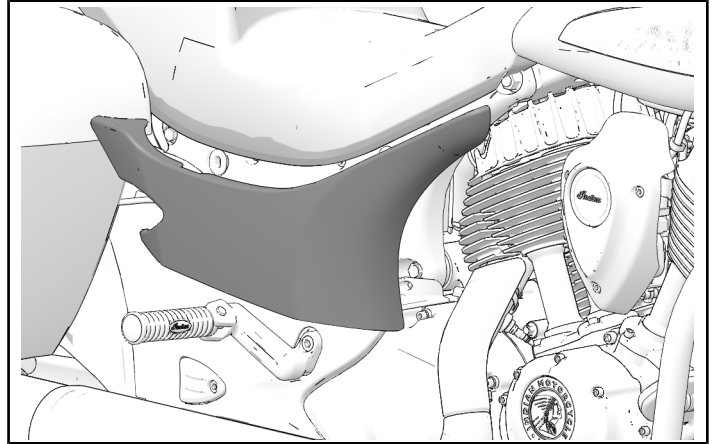

### MOTORCYCLES WITH QUICK RELEASE SADDLEBAGS

#### QUICK RELEASE SADDLEBAG REMOVAL

1. Disconnect one electrical connector on each side for saddlebag wiring.

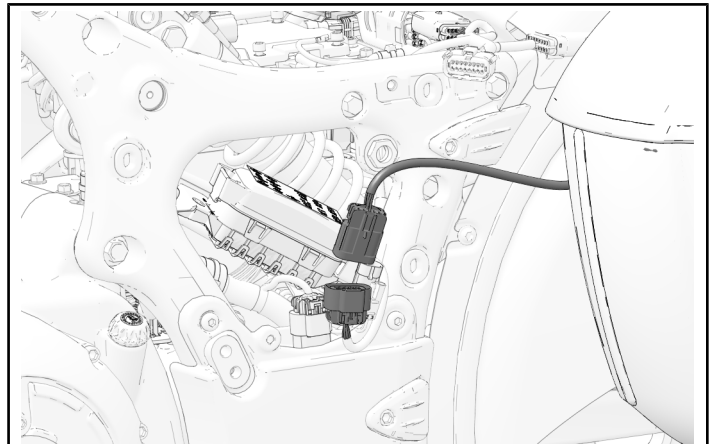

2. Lift open quick release to remove saddlebags and carefully set aside.

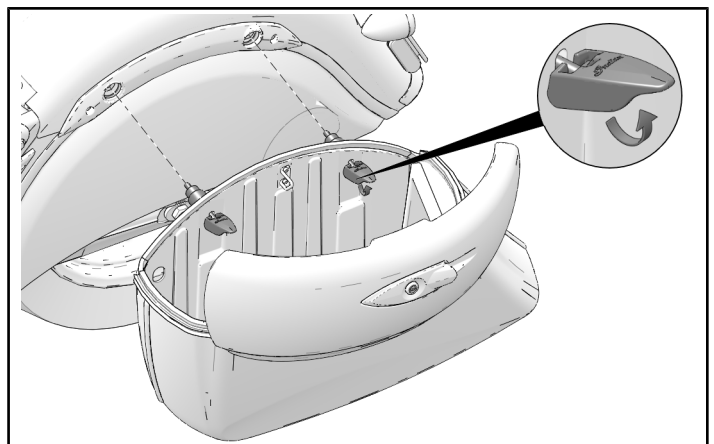

## **BOLT-ON SADDLEBAG REMOVAL**

### **SADDLEBAG REMOVAL**

#### **HARD SADDLEBAGS ONLY**

1. Unlock electric saddlebag lock (if equipped).

#### **NOTICE**

Key provided with motorcycle can also be used in latch release buttons to unlock saddlebag lids.

2. Disconnect saddle bag lock wiring near seat.

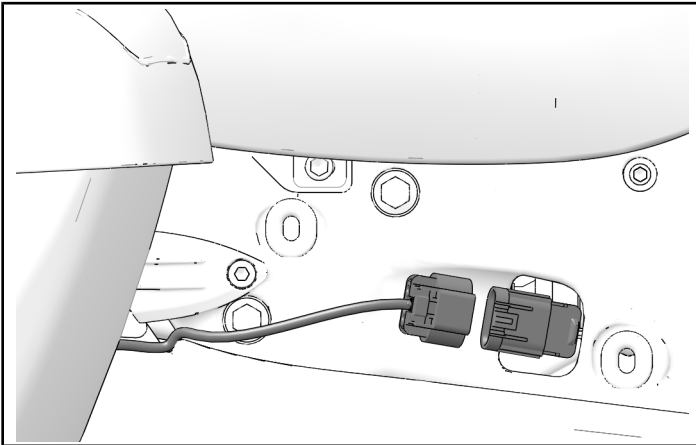

3. Repeat this section for opposite side.

#### **ALL SADDLEBAGS**

1. Open saddlebag.
2. Remove and keep two screws (A).

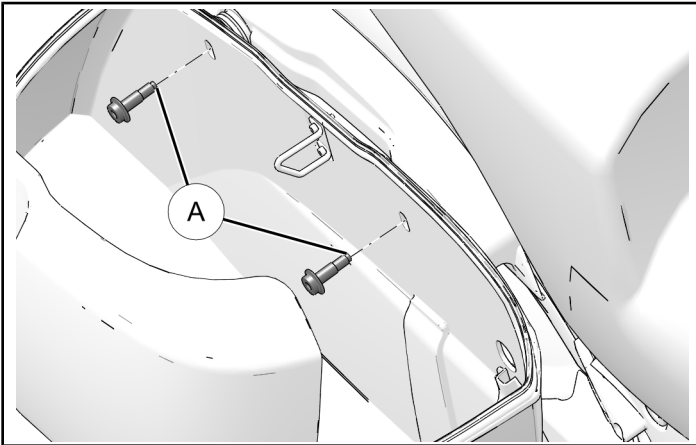

3. Tilt saddlebag away from frame and remove from vehicle.

#### **NOTICE**

Lift leather saddlebags up-and-off spools before tilting off frame.

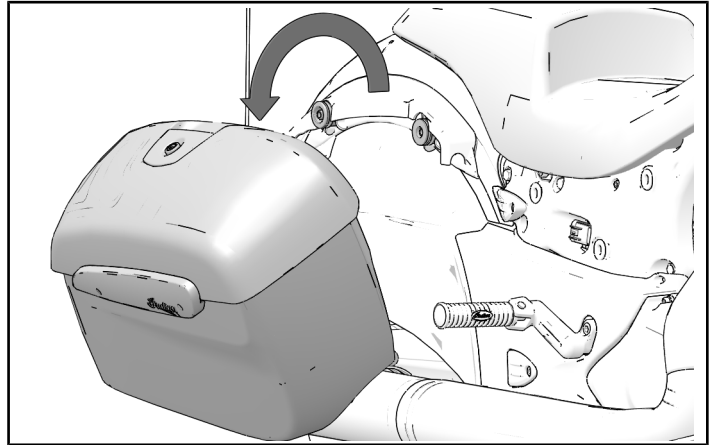

4. Repeat this section for opposite saddlebag.

## **CHALLENGER AND PURSUIT MODELS**

### **SIDE COVER REMOVAL**

#### **NOTICE**

Left side shown; right side similar.

#### **CAUTION**

Protect painted surfaces with protective cloth during installation.

1. Hold front lower corner of the side panel and gently pull away from vehicle to release three grommet pins. Use caution to prevent damage to painted surfaces.

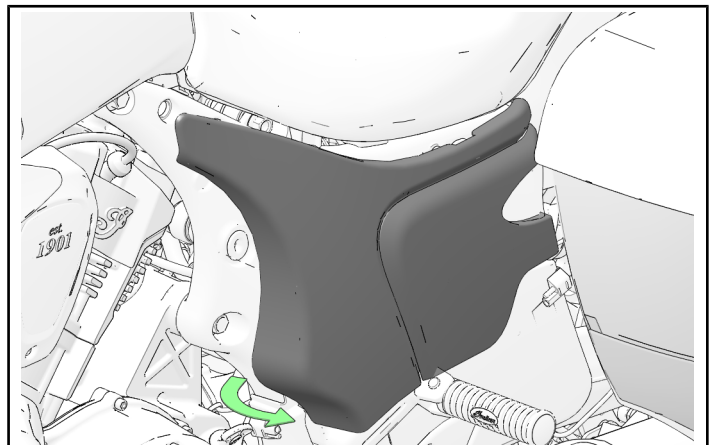

## **RIGHT SIDE PANEL REMOVAL**

1. Hold front edge of right side panel and gently pull away from vehicle to release three grommet pins. Use caution to prevent damage to painted surfaces.

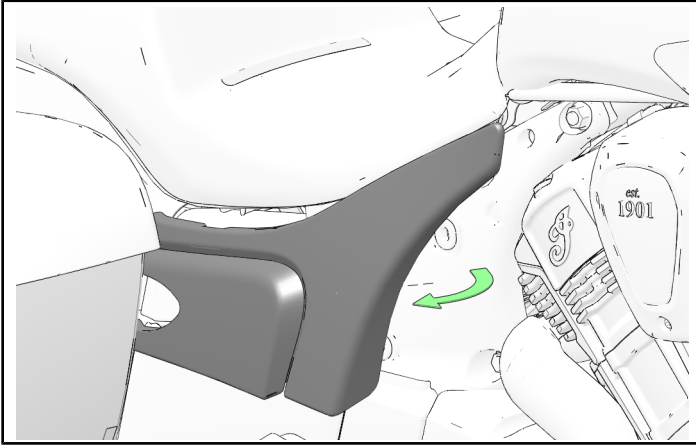

## **SADDLEBAG REMOVAL**

### **HARD SADDLEBAGS ONLY**

1. Unlock electric saddlebag lock (if equipped).

#### ***NOTICE***

Key provided with motorcycle can also be used in latch release buttons to unlock saddlebag lids.

2. Disconnect saddle bag lock wiring near seat.

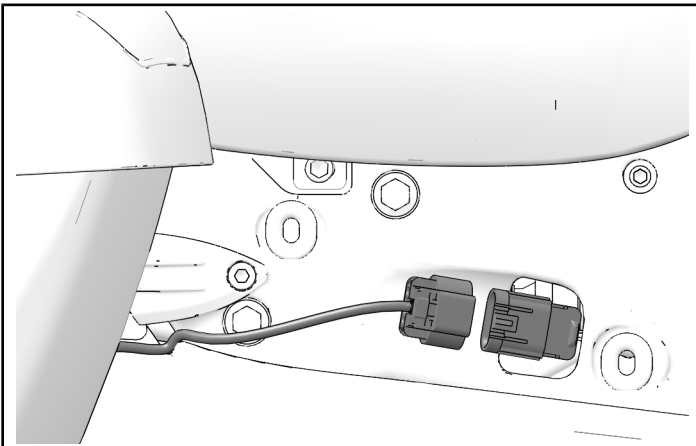

3. Repeat this section for opposite side.

### **ALL SADDLEBAGS**

1. Open saddlebag.

2. Remove and keep two screws (A).

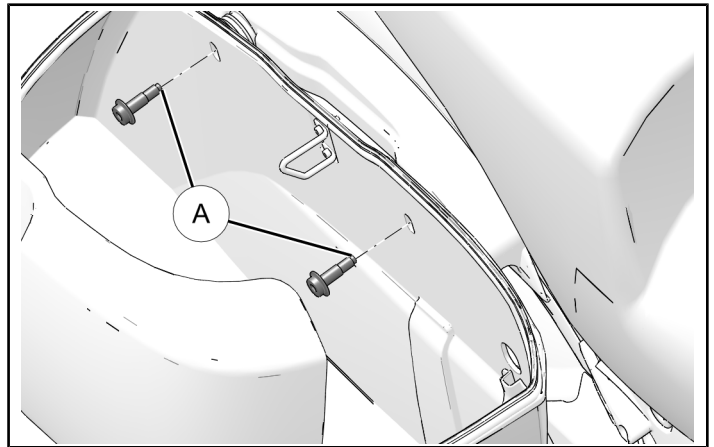

3. Tilt saddlebag away from frame and remove from vehicle.

#### ***NOTICE***

Lift leather saddlebags up-and-off spools before tilting off frame.

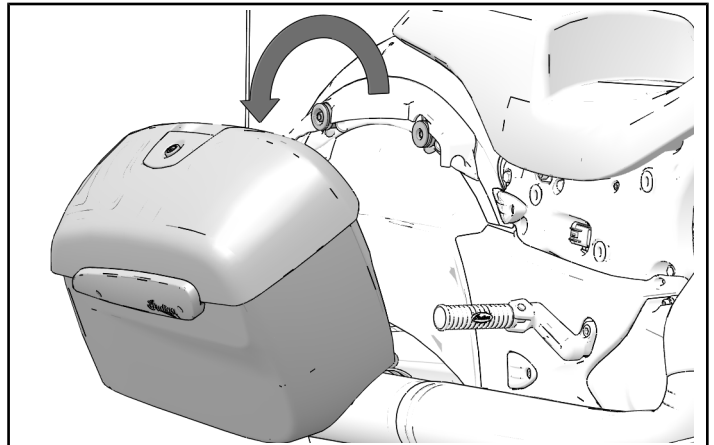

4. Repeat this section for opposite saddlebag.

## ACCESSORY INSTALLATION

### SADDLEBAG SPOOL PLASTIC BUSHING INSTALLATION

(IF NOT ALREADY EQUIPPED)

1. Remove spools from side of fender.

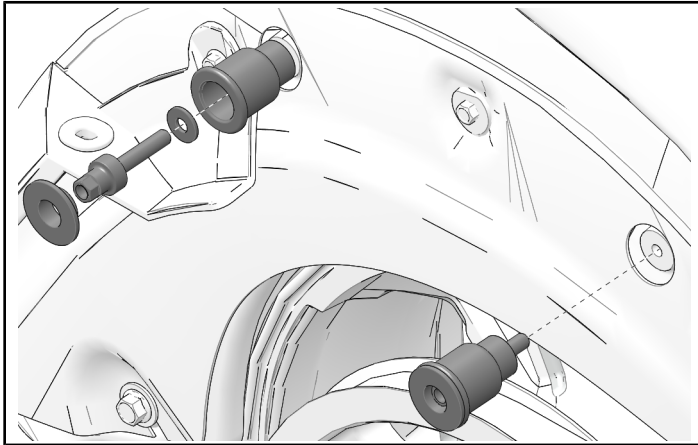

2. Install new trunk spool bushings ⑦ over spools.

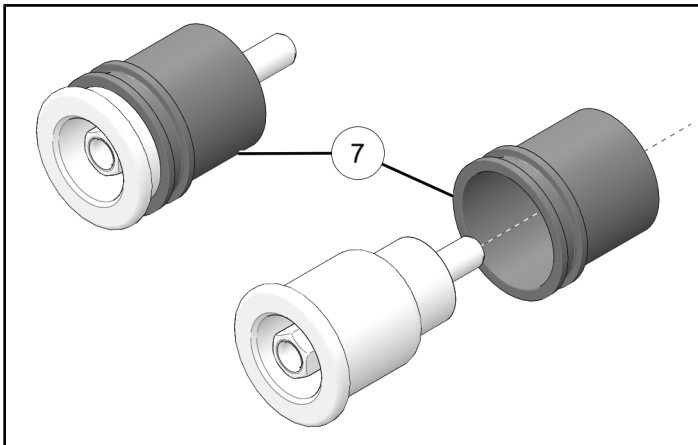

3. Install assembly onto fender and torque screws to specification.

#### TORQUE

Spool Screw:  
**30 ft-lbs (40 N·m)**

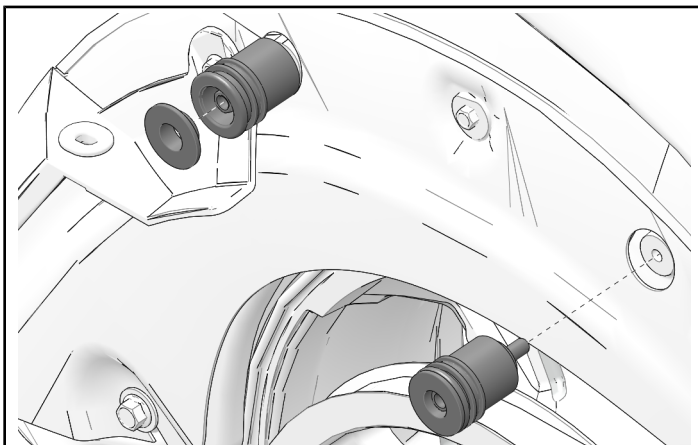

## TRUNK BASE KIT P/N 2889605 ASSEMBLY

1. Place trunk base assembly upside down on a flat surface and loosely install eight screws ⑮ to trunk base assembly.

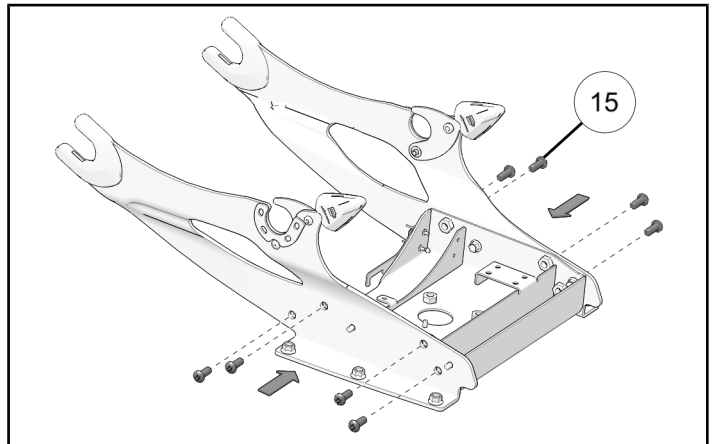

2. Make sure assembly is still on a flat surface. Torque all screws to specification.

#### TORQUE

Bracket Screws ⑮:  
**18 ft-lbs (24.5 N·m)**

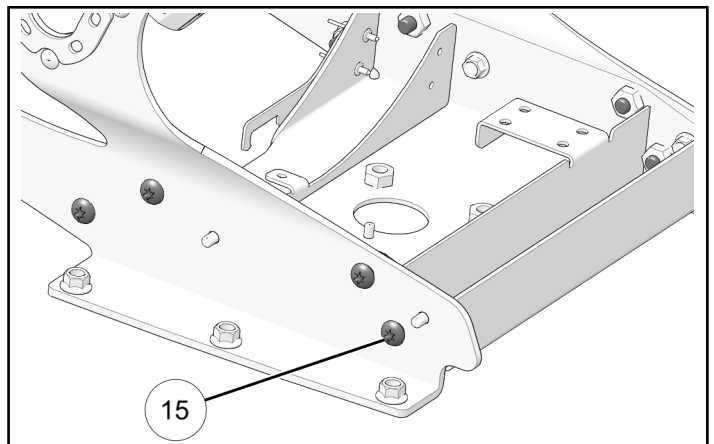

3. Loosely install weld bumper ① to trunk base assembly using screws ⑯.

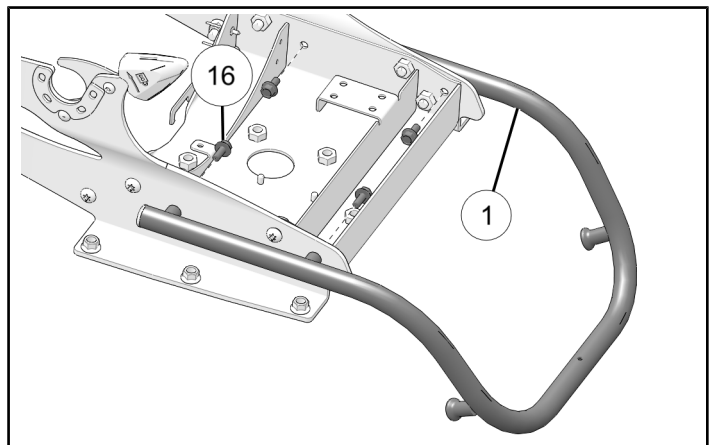

4. Torque all weld bumper screws to specification.

#### TORQUE

Weld Bumper Screws ⑯:  
84 in-lbs (9.5 N·m)

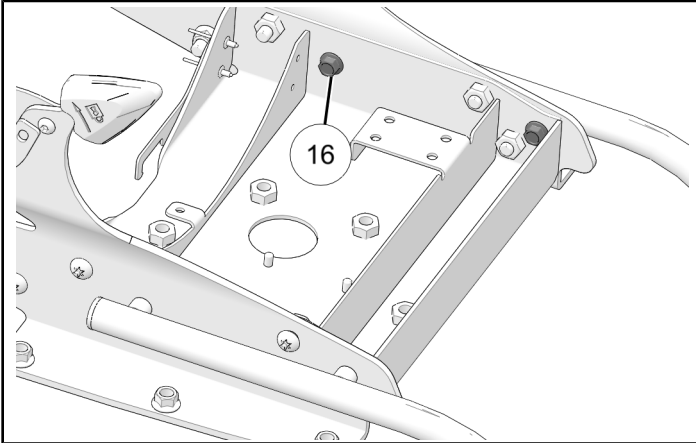

#### TRUNK BASE INSTALLATION

1. Move locking levers into the open position.

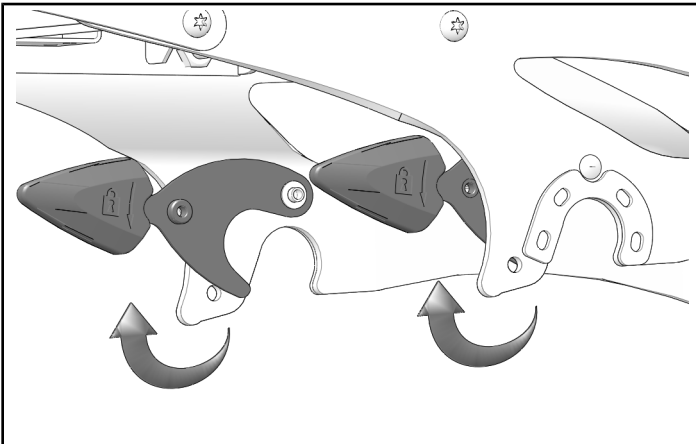

2. Install front feet of trunk base and lower trunk base onto spools.

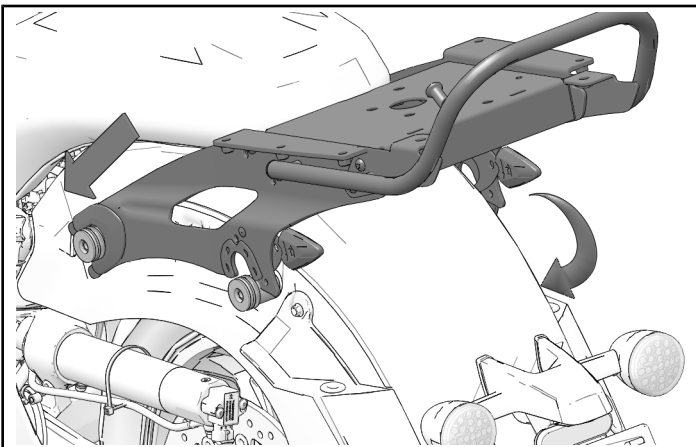

3. Close trunk base locks and install trunk base security screws ⑭. Torque screws to specification.

#### TORQUE

Trunk Base Security Screws: ⑭  
88 in-lbs (10 N·m)

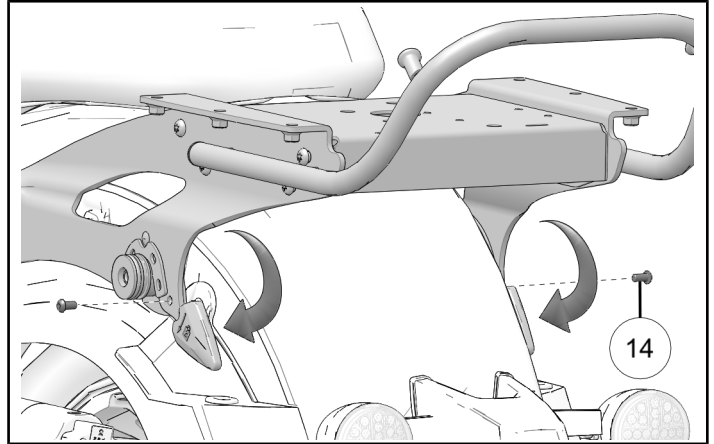

#### PERCH CLAMP INSTALLATION

1. Remove and keep two bolts and remove back side of perch clamp.

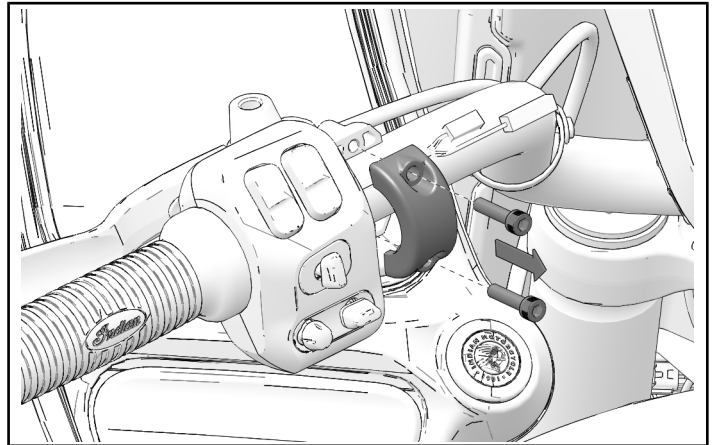



- Loosely install clutch perch clamp ④ using kept bolts.

**IMPORTANT**

Make sure that master cylinder reservoir stays level while installing.

**NOTICE**

Left side shown, right side similar.

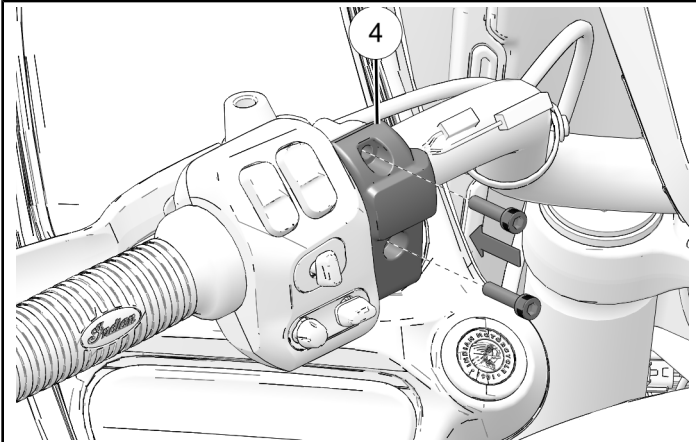

- Torque perch clamp bolts to specification starting with the top bolt.

**TORQUE**

Perch Clamp Bolts:  
97 in-lbs (11 N·m)

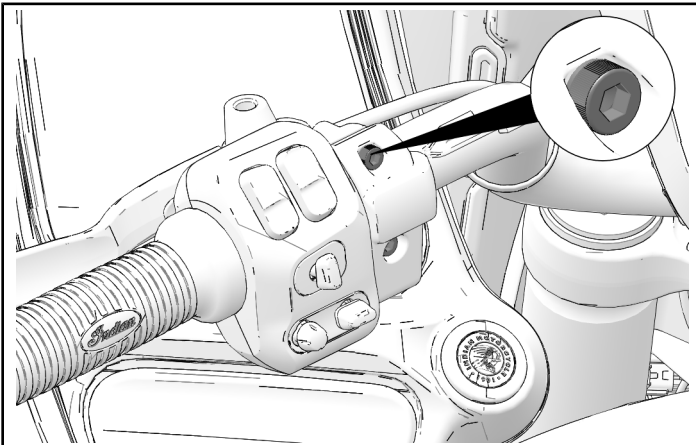

**QUICK RELEASE TRUNK KIT ASSEMBLY**

- Set trunk assembly ① onto frame ①.

**TIP**

Have a second person hold the bin in place for steps 1 and 2.

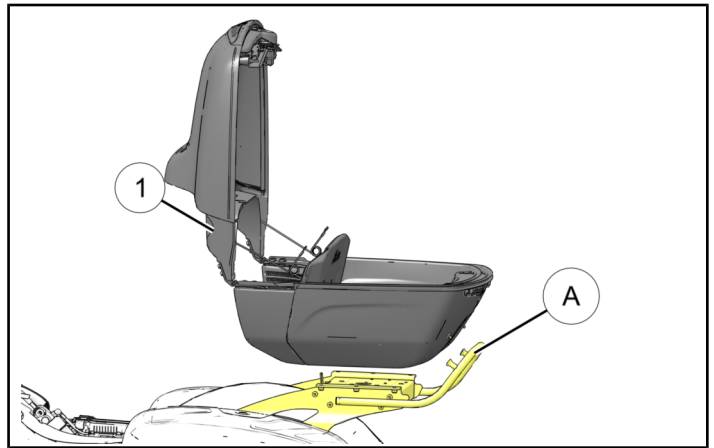

- Loosely install ten screws ② and ten washers ③.

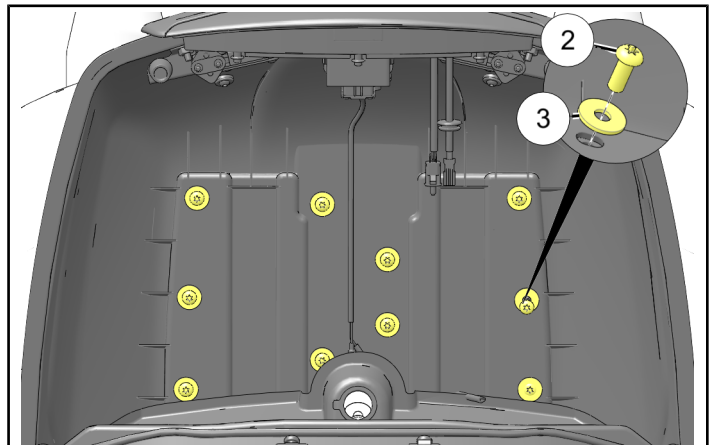

- Install rubber washer ⑥ between post on rear bumper frame ① and lower trunk ①. Loosely install screw ④, steel washer ⑤, and rubber washer ⑥.

**DO NOT** torque screws at this time.

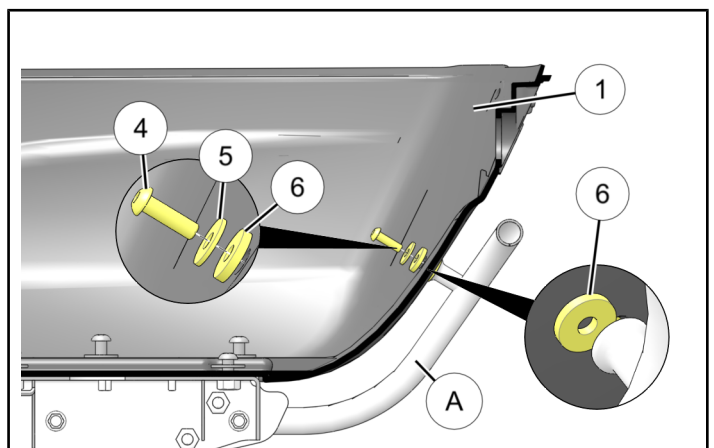

- Repeat previous step for opposite bumper frame post.
- Torque two bumper screws ④ to specification.

### TORQUE

Bumper Screws ④:  
**12 in-lbs (1.5 N·m)**

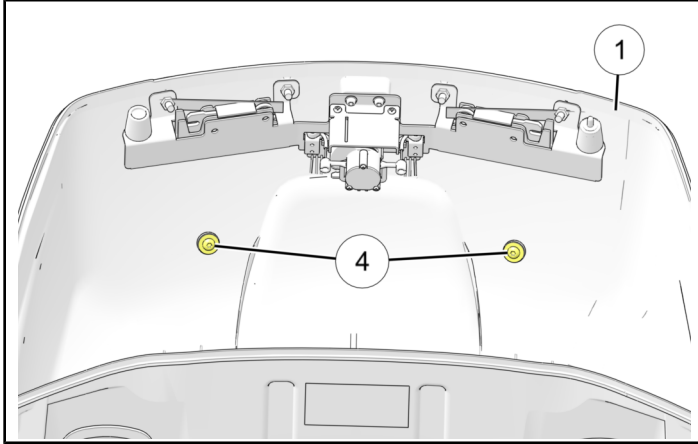

- Torque ten screws ② in base to specification in sequence shown.

### TORQUE

Base Screws ②:  
**13 ft-lbs (17.5 N·m)**

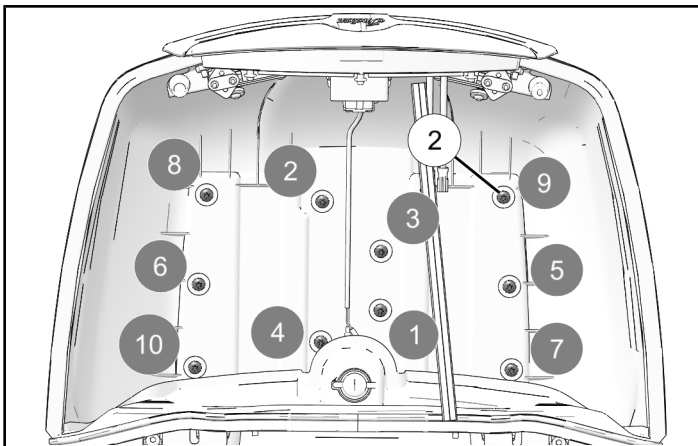

## VEHICLE REASSEMBLY

### ALL AIR-COOLED HEAVYWEIGHT BIKES

#### QUICK RELEASE SADDLEBAG INSTALLATION

- Install saddlebag into place. Close quick release lever to attach saddlebags.

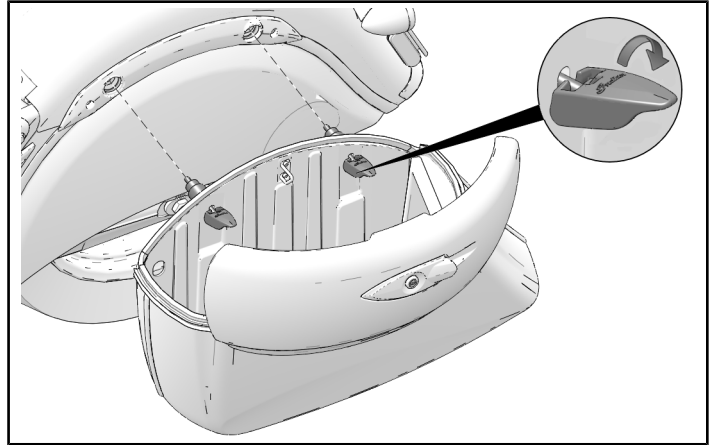

- Connect one electrical connector on each side for saddlebag wiring.

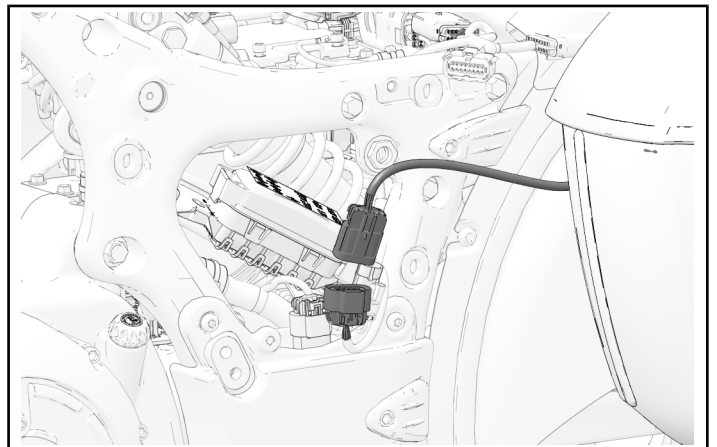

#### SADDLEBAG INSTALLATION

##### ALL SADDLEBAGS

- Set saddlebag in place.

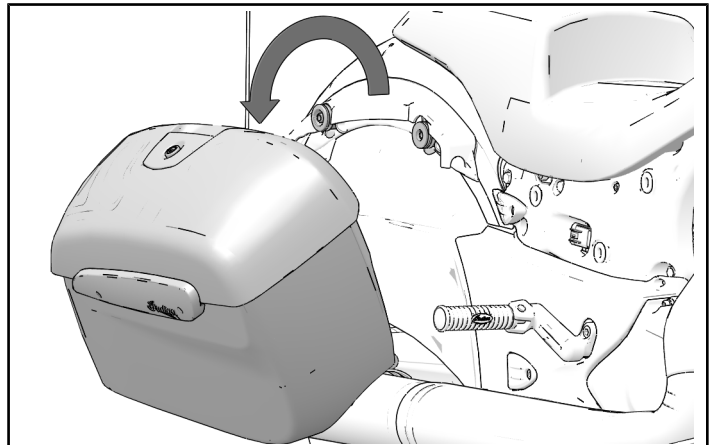

2. Open saddlebag.
3. Install two retained screws (A). Torque screws to specification.

### TORQUE

Saddlebag Screws (A):  
18 ft-lbs (24 N·m)

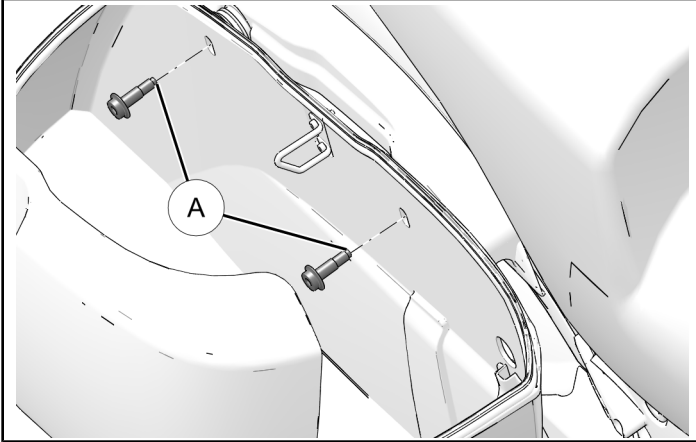

4. Repeat this section for opposite saddlebag.

### HARD SADDLEBAGS ONLY:

1. Connect saddle bag lock wiring near seat.

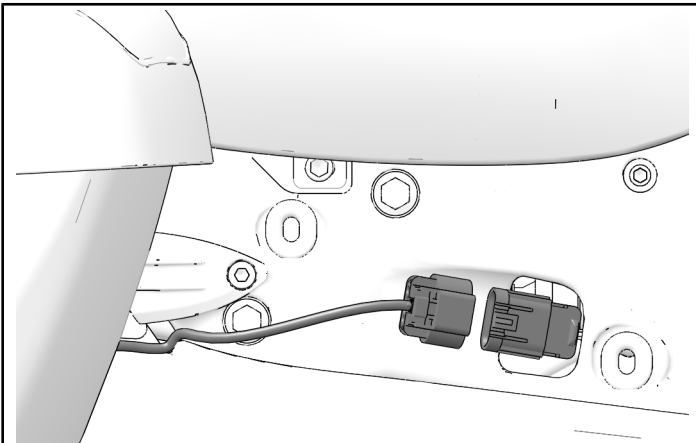

2. Repeat this section for opposite side.

### SIDE COVER INSTALLATION

1. Install side covers by aligning pins with rubber grommets and pressing into place.

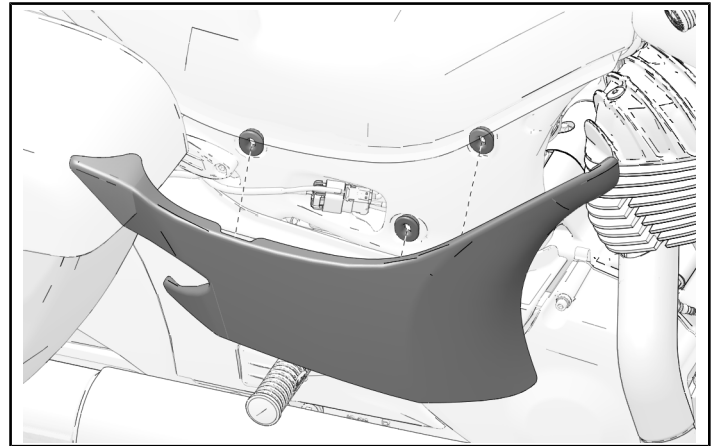

### CHALLENGER AND PURSUIT MODELS

#### SADDLEBAG INSTALLATION

##### ALL SADDLEBAGS

1. Set saddlebag in place.

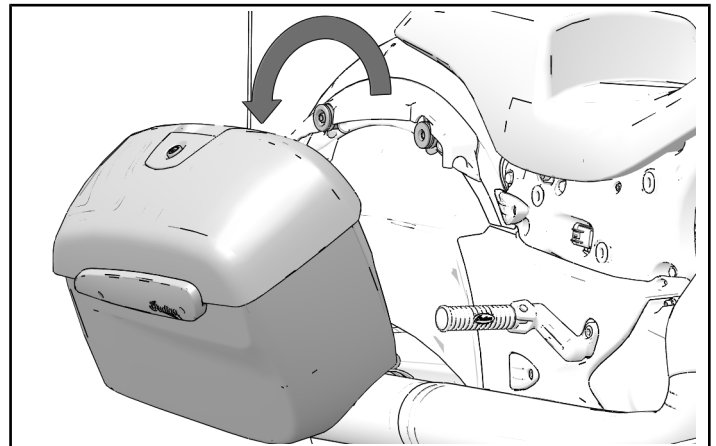

2. Open saddlebag.

3. Install two retained screws (A). Torque screws to specification.

### TORQUE

Saddlebag Screws (A):  
18 ft-lbs (24 N·m)

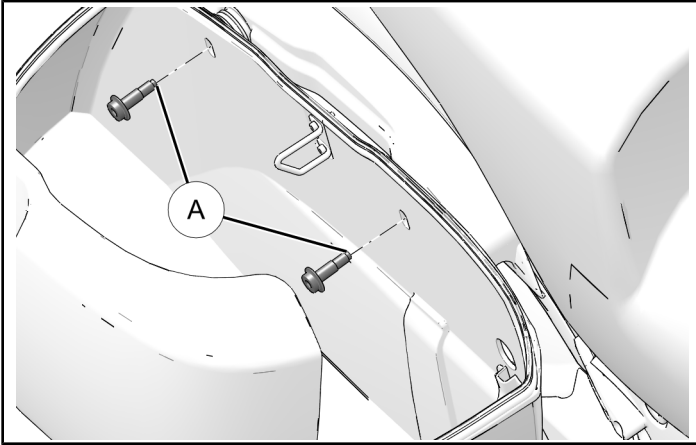

4. Repeat this section for opposite saddlebag.

### HARD SADDLEBAGS ONLY:

1. Connect saddle bag lock wiring near seat.

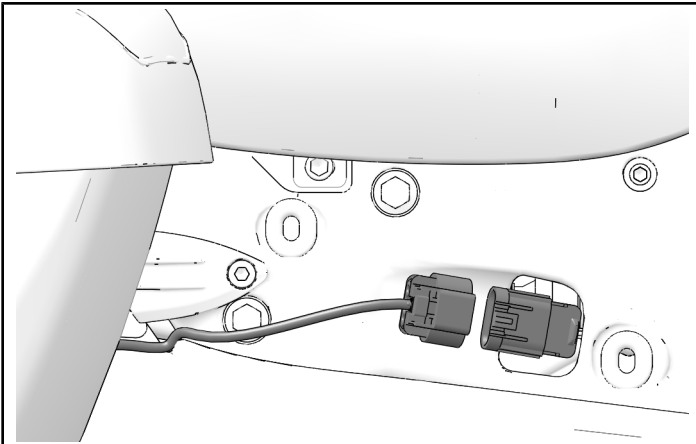

### INSTRUCTION FEEDBACK FORM

A feedback form has been created for the installer to provide any comments, questions or concerns about the installation instructions. The form is viewable on mobile devices by scanning the QR code or by clicking [HERE](#) if viewing on a PC.



2. Repeat this section for opposite side.

### SIDE COVER INSTALLATION

#### NOTICE

Left side shown; right side similar.

1. Attach the panel by aligning the three grommet pins and pushing it in. Use caution to prevent damage to painted surfaces.

