

NOISE REDUCTION KIT



P/N 2883489

APPLICATION

Verify accessory fitment at Polaris.com.

BEFORE YOU BEGIN

Read these instructions and check to be sure all parts and tools are accounted for. Please retain these installation instructions for future reference and parts ordering information.

KIT CONTENTS

This Kit includes:

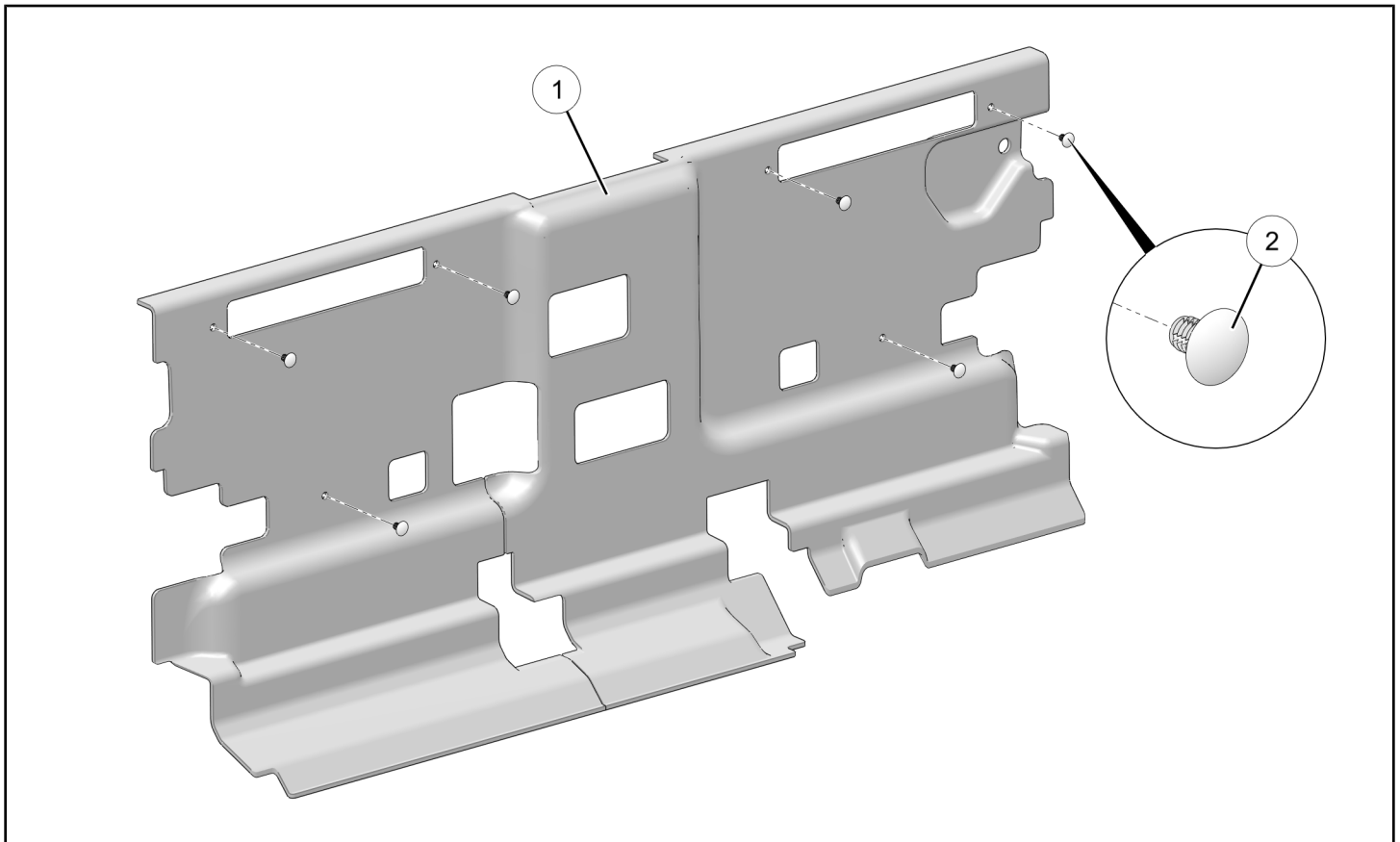

REF	QTY	PART DESCRIPTION	PART NUMBER
1	1	Panel, Rear Inner	5814644
2	6	Push Dart	7670088
	1	Instructions	9928733

TOOLS REQUIRED

- Safety Glasses
- Pliers, Push Pin Rivet
- Screwdriver Set, Torx®

IMPORTANT

Your Noise Reduction Kit is exclusively designed for your vehicle. Please read the installation instructions thoroughly before beginning. Installation is easier if the vehicle is clean and free of debris. For your safety, and to ensure a satisfactory installation, perform all installation steps correctly in the sequence shown.

ASSEMBLY TIME

Approximately 40 minutes

NOTE

Additional time may be required to accommodate other accessories.

INSTALLATION INSTRUCTIONS

1. Shift vehicle transmission into "PARK". Turn ignition switch to "OFF" position and remove key.
2. Gain access.
 - a. Raise vehicle bed.
 - b. Remove rear window panel (if installed).
 - c. **SLIDING DRIVER SEAT:** Slide seat to full forward position.
NON-SLIDING DRIVER SEAT: Remove driver side seat bottom.
- d. Remove upper rear fender on LH side of vehicle by removing two screws (A) from bolster bar upper mounting bracket, one push pin rivet (B) from lower front interior of fender, and two push pin rivets (C) from rear side of fender.

Push bolster bar slightly inboard, then lift and remove fender. Retain screws and rivets.

Repeat for RH fender.

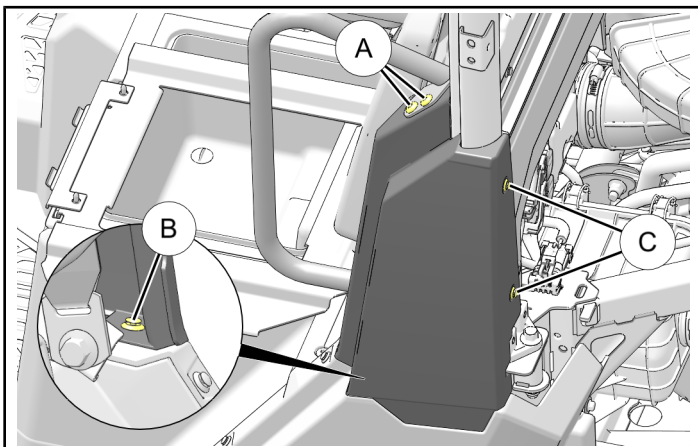

- e. Remove seven push pin rivets (D) from upper edge of close-off panel.

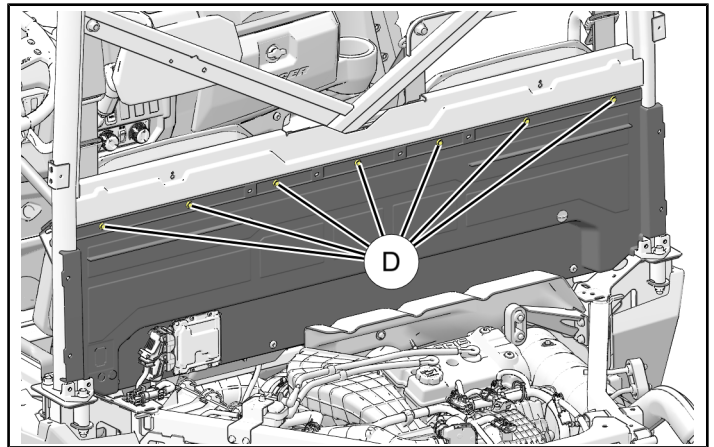

- f. While pulling upper edge of close-off panel slightly rearward, remove and retain screws securing seat back to ROPS structure.
 - i. **SLIDING DRIVER SEAT:** Remove four screws (E) from passenger seat back.
 - ii. **NON-SLIDING DRIVER SEAT:** Remove four screws (E) and two screws (F) from seat back.

NOTE

Close-off panel hidden for clarity.

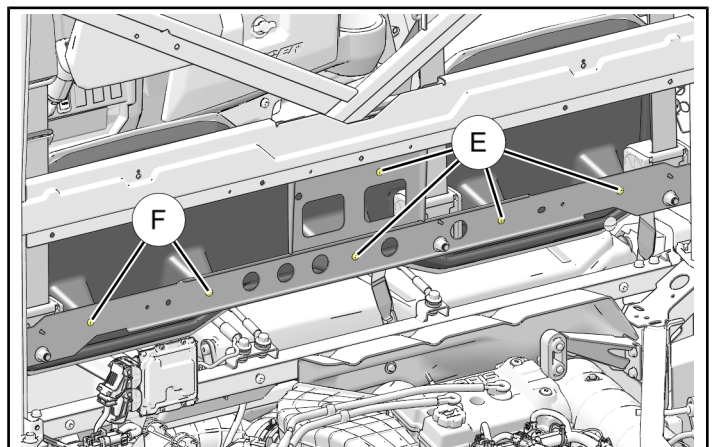

- g. Lift seat back up and forward to disengage tabs ⑥ from ROPS cross-member.

NOTE

Single piece (driver and passenger) seat back shown; split (passenger only) seat back similar. Seat belts hidden for clarity.

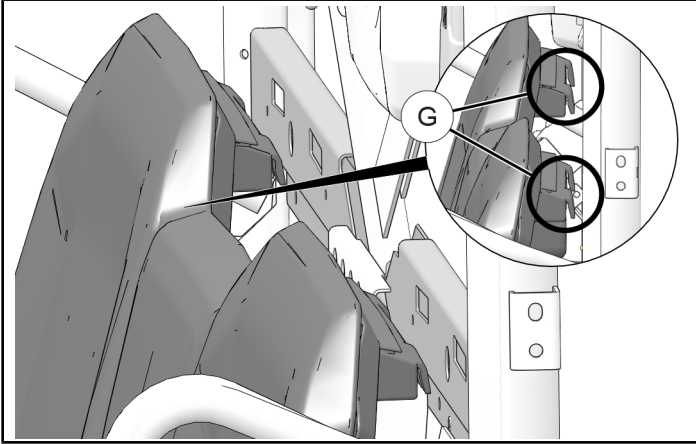

3. Install rear panel ① using six push darts ②.

IMPORTANT

Do NOT remove seat belt mounting fasteners. Panel is pre-cut to allow installation around seat belt components.

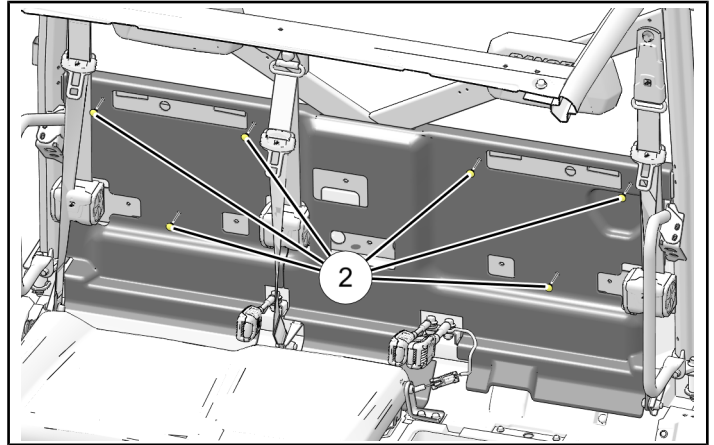

4. Restore access. Torque two bolster bar screws ① to specification. See Step 2d.

TORQUE

6 ± 1 ft. lbs. (8 ± 1 Nm)

FEEDBACK FORM

A feedback form has been created for the installer to provide any comments, questions or concerns about the installation instructions. The form is viewable on mobile devices by scanning the QR code or by clicking [HERE](#) if viewing on a PC.

FEEDBACK FORM

