

# CREW REAR PREMIUM DOOR KIT



P/N 2883437; 2884276; 2889625

## BEFORE YOU BEGIN

Read these instructions and check to be sure all parts and tools are accounted for. Please retain these installation instructions for future reference and parts ordering information.

## APPLICATION

Verify accessory fitment at [Polaris.com](http://Polaris.com).

## REQUIRED, SOLD SEPARATELY

The CHASSIS-SIDE hinges required to install these REAR doors are not included in this kit. They are included in FRONT Door Kit P/N 2882561, 2882562, 2884275, 2884338 (or equivalent), and are also available in service kit 2208964.

See section **INSTALLATION INSTRUCTIONS**, Step 3, for detail.

## KIT CONTENTS

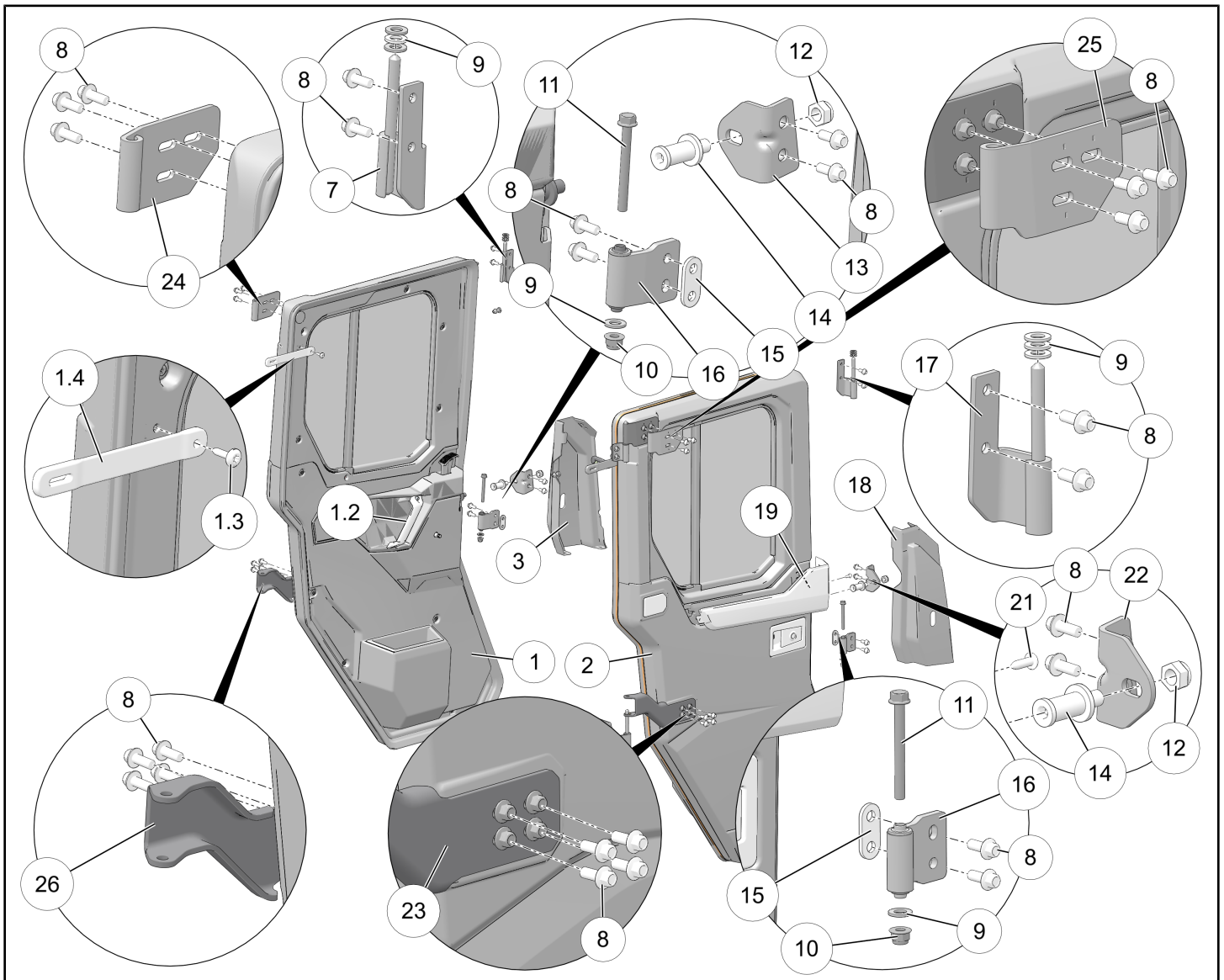

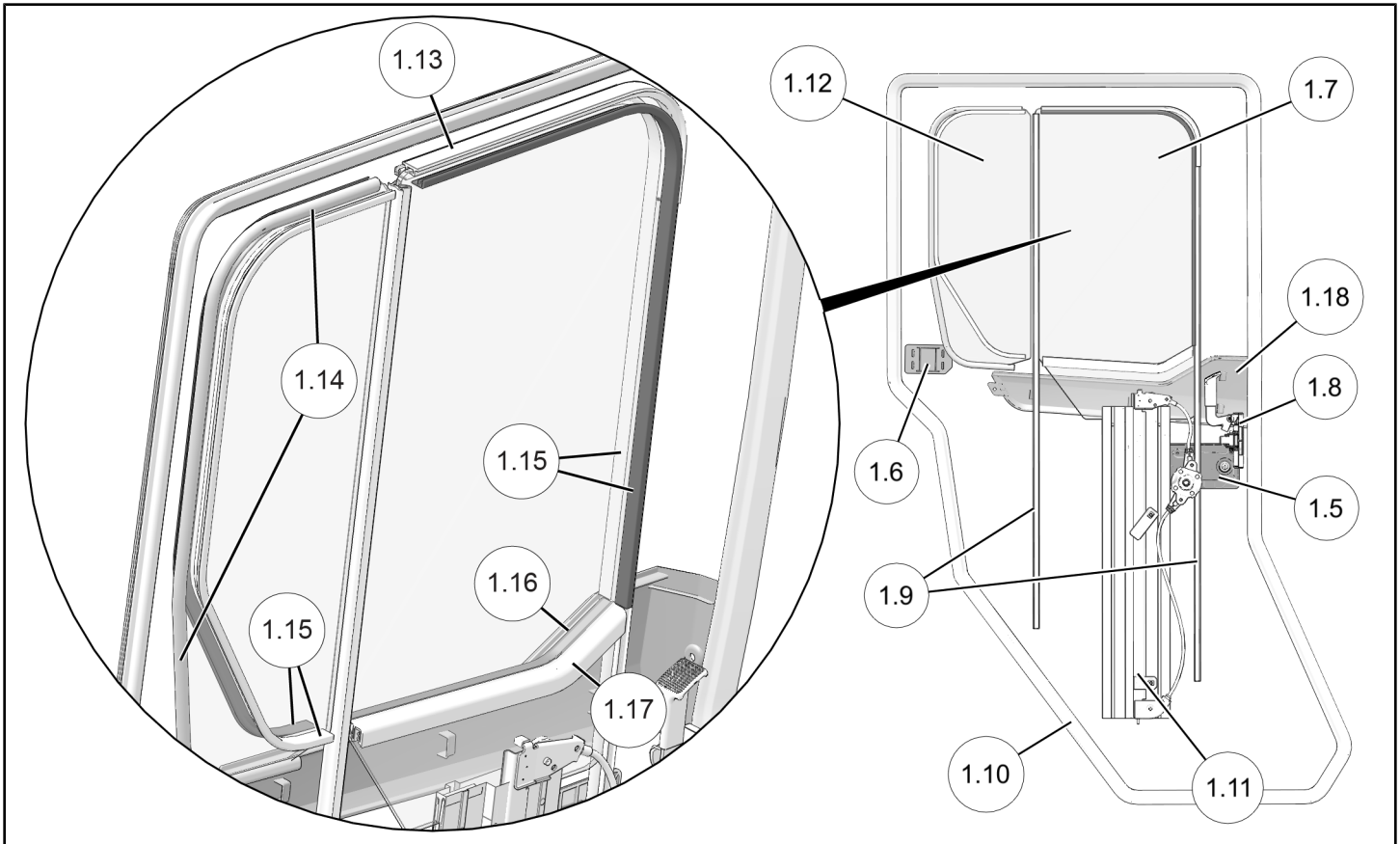

REF	QTY	PART DESCRIPTION	PART NUMBER	IN SERVICE KIT
1	1	Door Assembly, LH (includes parts 1.1–1.18 except as noted)	n/a	n/a
1.1	1	- Crank, Window	n/a	2207712**
1.2	1	- Handle, Grab, LH	n/a	2207851**
1.3	1	- Screw, Torx® Truss Head - M6 X 1.0 X 25	7519650	2205280**
1.4	1	- Strap, Limiter	n/a	
1.5	1	- Latch Assembly, Exterior	n/a	2207716*
1.6	1	- Cover, Hinge	n/a	2207853**
1.7	1	- Glass, Moveable (Front)	n/a	2207855*
1.8	1	- Latch Assembly, Interior, LH	n/a	2207715**
1.9	2	- Seal, Moveable Glass, Front/Rear	n/a	2207852*
1.10	1	- Seal, Door, Full Perimeter	n/a	
1.11	1	- Regulator Assembly, LH	n/a	2207856*
1.12	1	- Glass, Fixed (Rear)	n/a	2207854*
1.13	1	- Seal, Moveable Glass, Upper	n/a	2207852*
1.14	1	- Seal, Fixed Glass, Upper/Rear/Lower	n/a	
1.15	4	- Seal	n/a	
1.16	1	- Seal, Moveable Glass, Lower	n/a	
1.17	1	- Seal, Moveable Glass, Lower	n/a	
1.18	1	- Panel, Accent, LH (Kit PN 2884276–133 only)	5454768–133	n/a
	1	- Panel, Accent, LH (Kit PN 2884276–453 only)	5454768–453	

REF	QTY	PART DESCRIPTION	PART NUMBER	IN SERVICE KIT
2	1	Door Assembly, RH (includes 2.x parts identified below)	n/a	n/a
2.2	1	Handle, Grab, RH (not shown)	n/a	2207851**
2.8	1	Latch Assembly, Interior, RH (not shown)	n/a	2207715**
2.11	1	Regulator Assembly, RH (not shown)	n/a	2207857*
2.18	1 1	Panel, Accent, RH (2884276-133 only) (not shown) Panel, Accent, RH (2884276-453 only) (not shown)	5454769-133 5454769-453	n/a
3	1	Cover, B-Pillar, LH	5454372-070	n/a
4	2	Screw, Torx® Truss Head - M6 X 1.0 X 25	7519650	2205280**
5	2	Spacer	5139193	
6	2	Nut, Hex Flange, Locking - M6 X 1.0	7547339	
7	1	Hinge, Chassis-Side, Upper LH (front door)	n/a	2207849**
8	26	Screw, Hex Flange - M8 X 1.25 X 20	7519936	n/a
9	6	Washer, Nylon - 10.25 X 19.0 X 2.0	5439712	2207849**
10	2	Nut, Hex, Locking - M8 X 1.25	7547480	
11	2	Screw, Hex Flange - M8 X 1.25 X 120	7519818	
12	2	Nut, Hex - M12 X 1.75	7540000	2207850**
13	1	Bracket, Striker, LH	n/a	
14	2	Pin, Striker	n/a	
15	2	Spacer	5265312	2207849**
16	2	Hinge, Chassis-Side, Lower (front door)	n/a	
17	1	Hinge, Chassis-Side, Upper RH (front door)	n/a	
18	1	Cover, B-Pillar, RH	5454373-070	n/a
19	1	Panel, Accent, RH (2883437, 2889625 only)	5454769-070	n/a
20	1	Panel, Accent, LH (2883437, 2889625 only) (not shown)	5454768-070	n/a
21	2	Screw, Torx® Truss Head, High/Low - #14 X 3/4	7519045	n/a
22	1	Bracket, Striker, RH	n/a	2207850**
23	1	Hinge, Door-Side, Lower LH	n/a	2208964**
24	1	Hinge, Door-Side, Upper LH	n/a	
25	1	Hinge, Door-Side, Upper RH	n/a	
26	1	Hinge, Door-Side, Lower RH	n/a	

\* Service kit contains parts and hardware required for ONE side of vehicle.

\*\* Service kit contains parts and hardware required for BOTH sides of vehicle.

## TOOLS REQUIRED

- Safety Glasses
- Pliers, Push Pin Rivet
- Screwdriver Set, Torx®
- Socket Set, Hex Bit, Metric
- Socket Set, Metric
- Socket Set, Torx® Bit
- Torque Wrench
- Wrench Set, Metric

## CONSUMABLES REQUIRED

- Gloves, Chemical Resistant
- Grease, Polaris All Season (or equivalent)

## IMPORTANT

Your Crew Rear Premium Door Kit is exclusively designed for your vehicle. Please read the installation instructions thoroughly before beginning. Installation is easier if the vehicle is clean and free of debris. For your safety, and to ensure a satisfactory installation, perform all installation steps correctly in the sequence shown.

## INSTALLATION INSTRUCTIONS

### IMPORTANT

Polaris recommends completing Steps 1–3 of this Crew Rear Door Kit **PRIOR TO** installing the corresponding Front Door Kit. Installation of FRONT door hinges on **crew** vehicles is different from installation on **non-crew** vehicles.

### NOTICE

Polaris recommends two people install this kit.

1. Shift vehicle transmission into PARK. Turn ignition switch to OFF position and remove key.
2. Open vehicle bed.

## FRONT DOOR CHASSIS-SIDE HINGE INSTALLATION

### IMPORTANT

The chassis-side hinges included in this Crew REAR Door Kit will be used for the FRONT doors. Conversely, the chassis-side hinges included in the FRONT Door Kit (sold separately) will be used for the Crew REAR doors.

Swapping hinges is required to accommodate different hinge mounting structure in crew and non-crew vehicles.

As a result, do NOT follow hinge installation instructions included in the Front Door Kit. Follow these instructions instead.

1. Identify upper LH chassis-side hinge ⑦. Notice differences from upper RH chassis-side hinge ⑰.

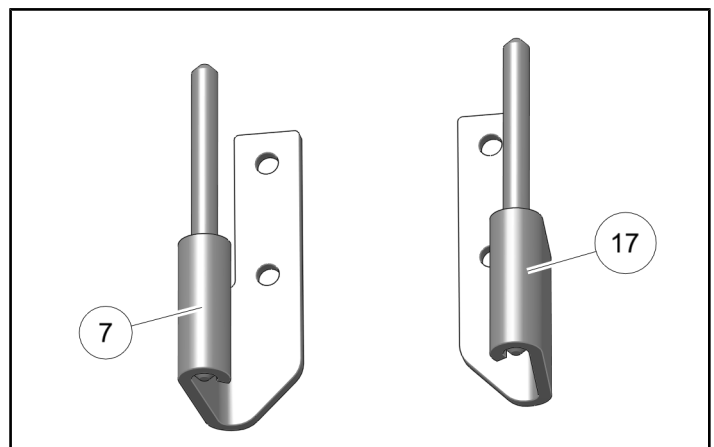

2. Install upper LH chassis-side hinge ⑦ to B-pillar fitting using two screws ⑧. Partially tighten screws (but still loose enough to allow hinge adjustment). Install nylon washer ⑨ to hinge pin.

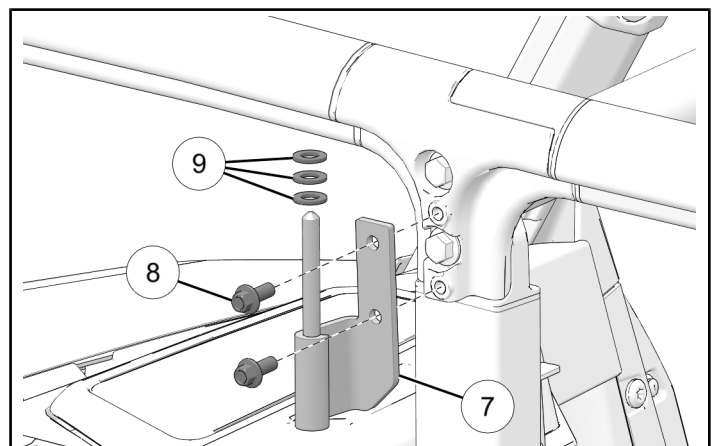

- Remove two screws (A) from top of existing B-pillar cover. Retain screws.

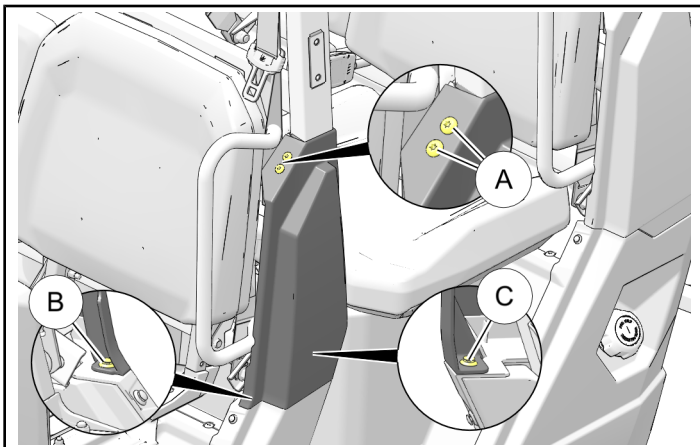

- Remove two push pin rivets from bottom interior of B-pillar cover (front rivet (B) and rear rivet (C)), then remove cover. Retain rivets.
- Install new LH B-pillar cover (3) using retained screws (A), and push-pin rivets (B) and (C).

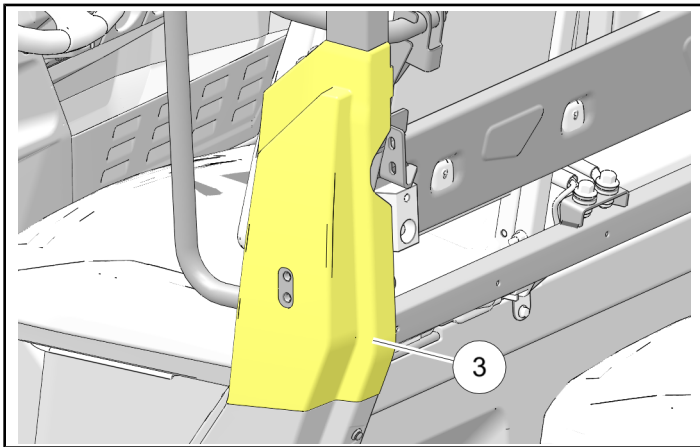

- Install spacer (15) and lower chassis-side hinge (16) to B-pillar fitting using two screws (8). Tighten screws.

#### NOTICE

Lower chassis-side hinge (16) is identical for LH/RH.

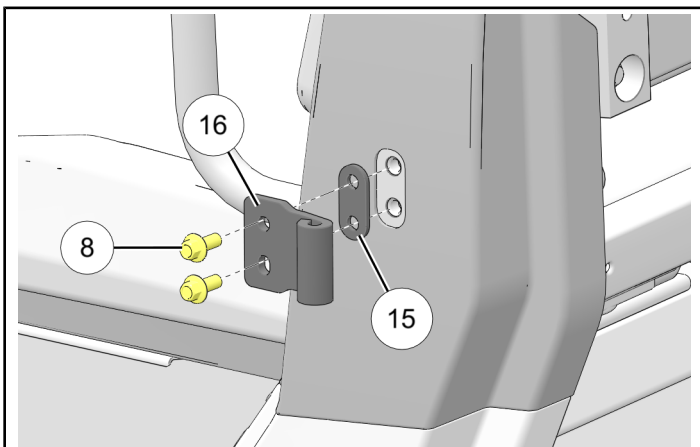

- Grease screw (11) and pin on upper chassis-side hinge (7) with Polaris All Season Grease (or equivalent).

#### WARNING

Follow all chemical manufacturer instructions and safety precautions. Failure to comply may result in severe injury or death.

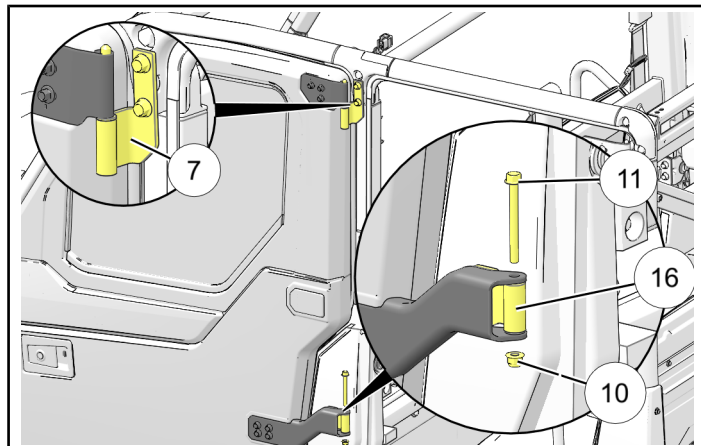

- Hang front door assembly on upper chassis-side hinge (7). Align door with lower chassis-side hinge (16), insert nylon washer (9) between chassis and door-side hinges as shown, then install screw (11). Secure with nut (10). Torque to specification.

#### TORQUE

8 ft-lbs (11 N·m)

- Continue with front door installation per instructions included with Front Door Kit.

When door adjustment is complete, ensure all chassis-side and door-side hinge screws are torqued to specification.

#### TORQUE

17 ft-lbs (23 N·m)

- Repeat Steps a. through i. for RH front door assembly using RH parts as identified in section **KIT CONTENTS**.

## REAR DOOR HINGE INSTALLATION

#### NOTICE

Repeat Steps 4–10 for RH door assembly (2) using RH parts as identified in section **KIT CONTENTS**.

1. Identify upper LH door-side hinge ②④. Notice differences from upper RH door-side hinge ②⑤.

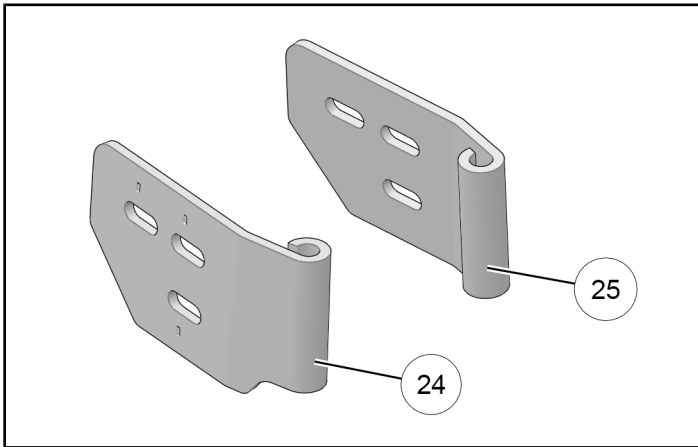

2. Install upper LH door-side hinge ②④ to LH rear door ① using three screws ⑧. Partially tighten screws (but still loose enough to allow hinge adjustment).

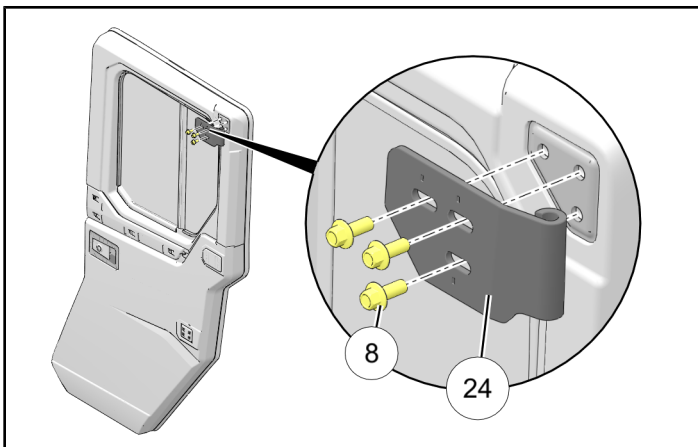

3. Install lower door-side hinge ②③ to LH rear door ① using four screws ⑧. Partially tighten screws (but still loose enough to allow hinge adjustment).

**NOTICE**

Lower door-side hinge ②③ is identical for LH/RH.

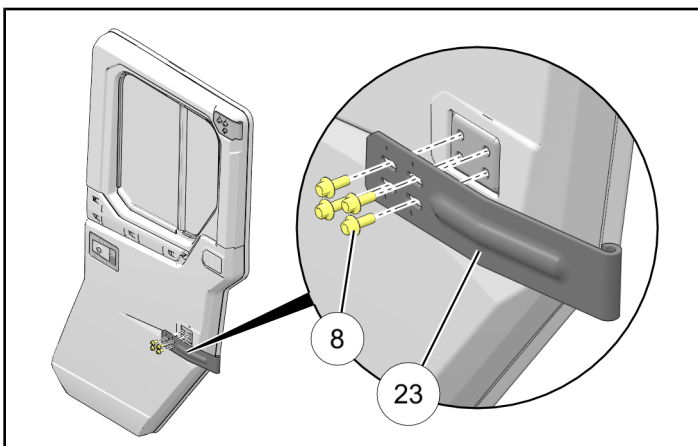

## REAR DOOR CHASSIS-SIDE HINGE INSTALLATION

1. Locate the following items included in the corresponding **FRONT** Door Kit (sold separately):
  - Upper LH chassis-side hinge ②⑥ and RH chassis-side hinge ②⑦

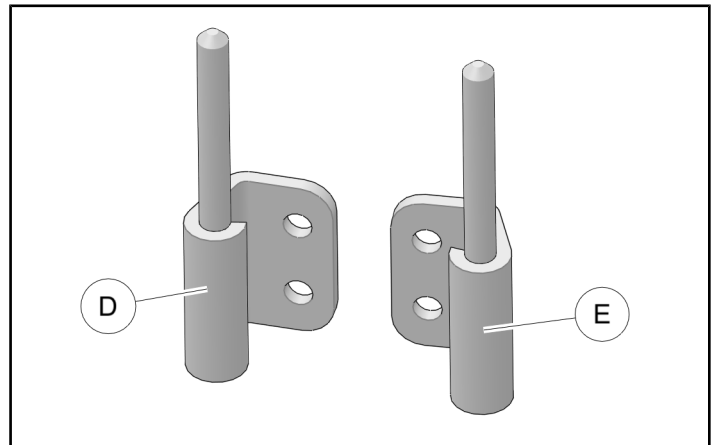

- Lower LH chassis-side hinge ②⑧ and RH chassis-side hinge ②⑨

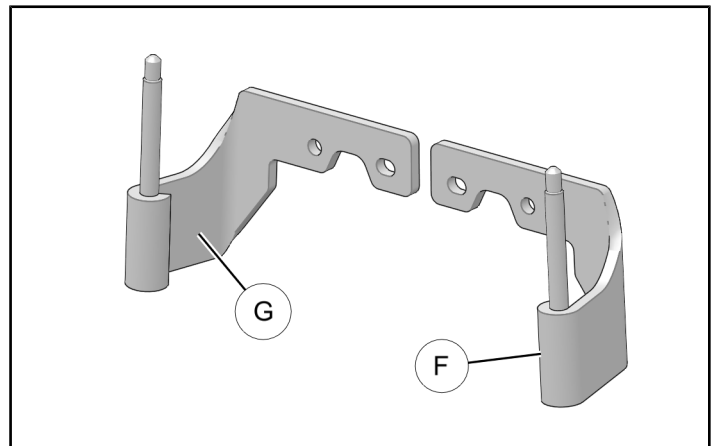

- M8 X 1.25 X 20 hex flange screws ②⑩ (quantity 8)
- Nut plates ②⑪ (quantity 2)

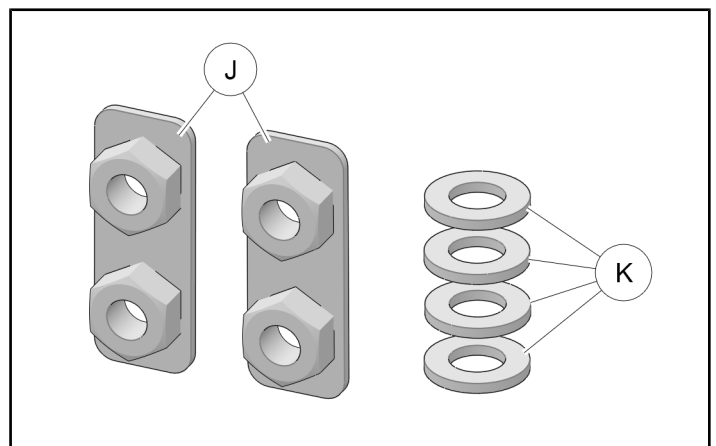

- Nylon washers ②⑫ (quantity 4)



2. Raise vehicle bed.
3. Install lower LH chassis-side hinge (F) to chassis fitting using two screws (H). Tighten screws. Install nylon washer (K) to hinge pin.

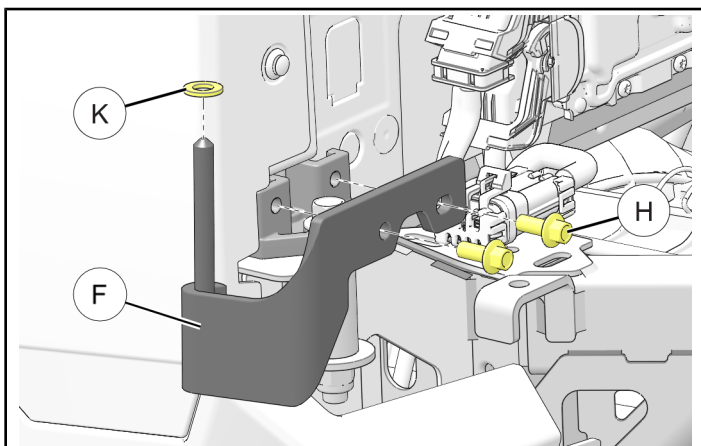

4. Install upper LH chassis-side hinge (D) to C-pillar fitting using two screws (H) and nut plate (J). Partially tighten screws (but still loose enough to allow hinge adjustment). Install nylon washer (K) to hinge pin.

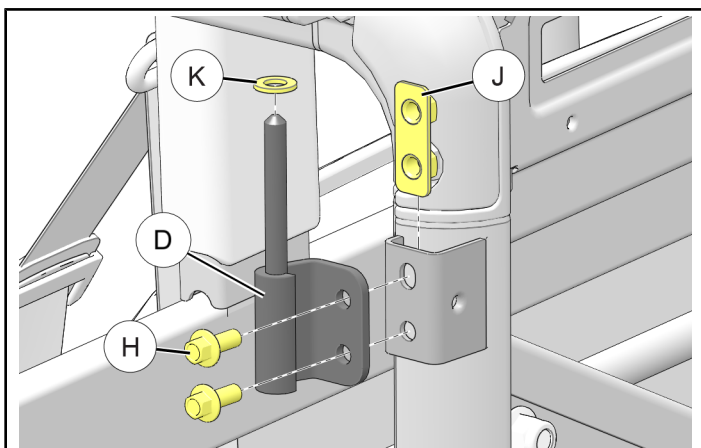

### ⚠ WARNING

Follow all chemical manufacturer instructions and safety precautions. Failure to comply may result in severe injury or death.

## DOOR INSTALLATION

1. Grease pins on upper and lower chassis-side hinges (D) and (F) using Polaris All Season Grease (or equivalent).

2. Hang LH door assembly (1) on lower chassis-side hinge (F) first, then upper chassis-side hinge (D).

### NOTICE

Lower hinge pin is longer than upper hinge pin to aid door installation.

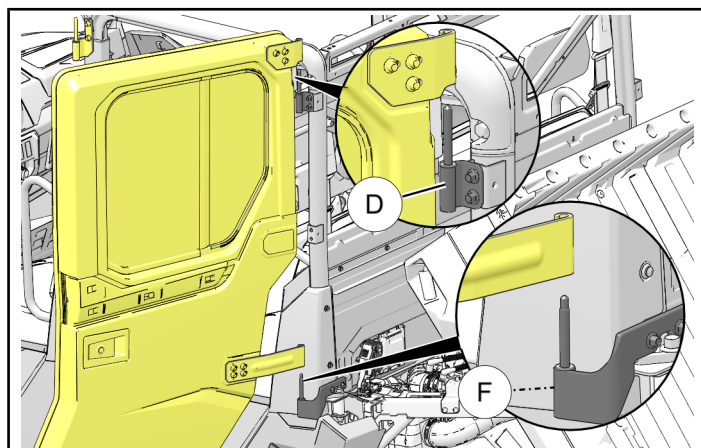

3. Close and push door inwards while centering door in ROPS/chassis opening, then tighten all screws (H) and (8).

### TIP

Have one person hold and center the door, and a second person tighten the screws.

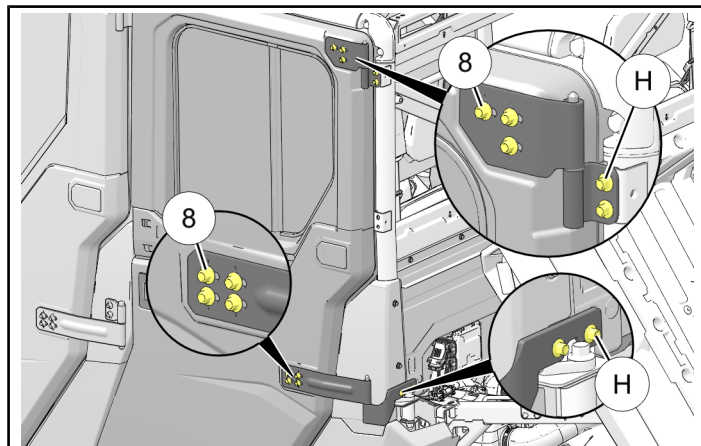

4. Open and close door to ensure door is still centered in ROPS/chassis opening. Adjust as required.
5. Torque all door-side and chassis-side hinge screws (H) and (8) to specification.

### TORQUE

17 ft-lbs (23 N·m)

6. Install the nut ⑳ on the pivot hinge. Torque to specification.

**TORQUE**  
**19 ft-lbs (26 N·m)**

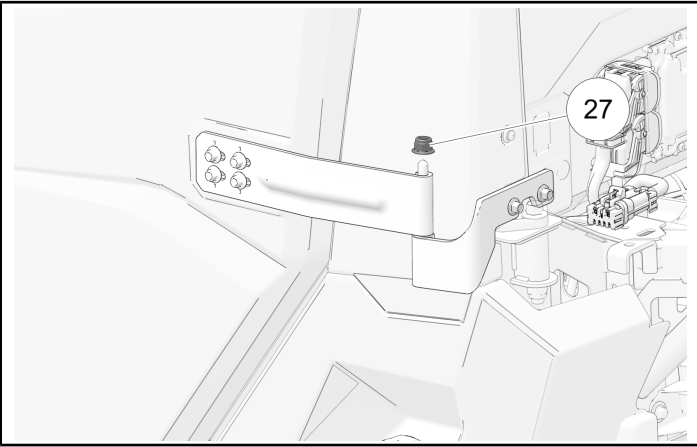

7. Install limiter strap retaining post to ROPS diagonal support using screw ④, spacer ⑤, and nut ⑥. Torque to specification, then secure strap P to post.

**TORQUE**  
**7 ft-lbs (9 N·m)**

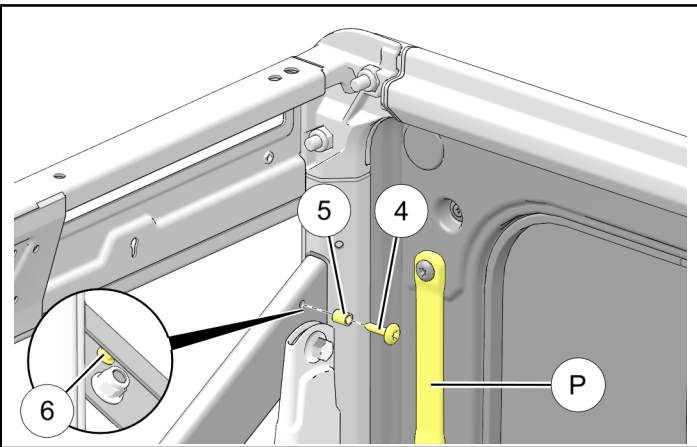

8. If LH accent panel ⑳ is not pre-installed from factory, install LH accent panel ⑳ to door by sliding receptacles in panel over tabs in door. Secure using screw ㉑. Torque to specification.

**TORQUE**  
**18 in-lbs (2 N·m)**

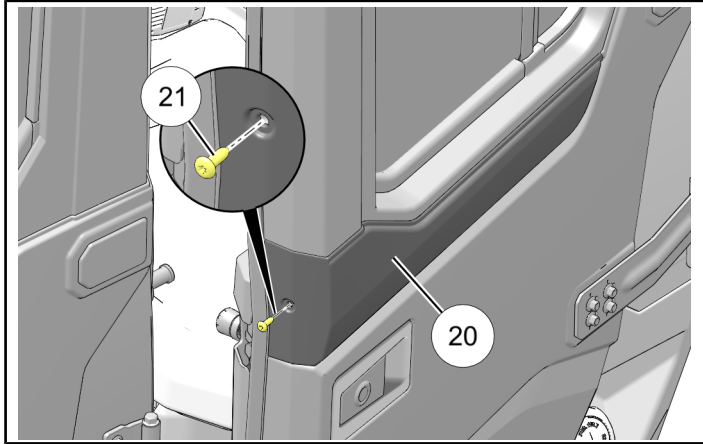

9. Lower vehicle bed.

## STRIKER INSTALLATION

1. Identify LH striker bracket ⑬. Notice differences from RH striker bracket ㉒.

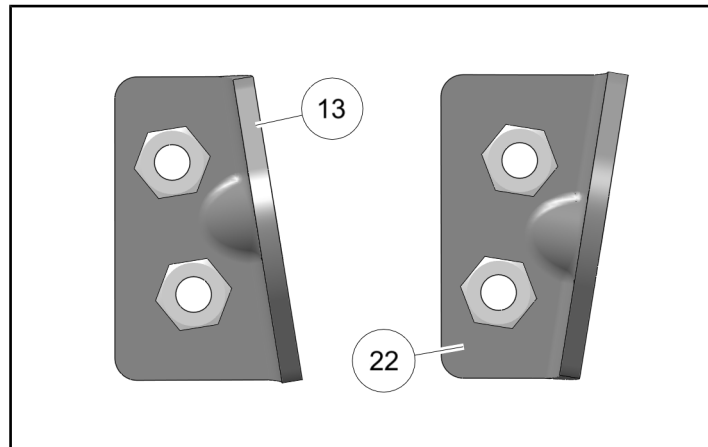



2. Install striker pin ⑭ to LH striker bracket ⑬ using nut ⑫. Center pin in slot, then tighten nut. Final adjustment will occur later.

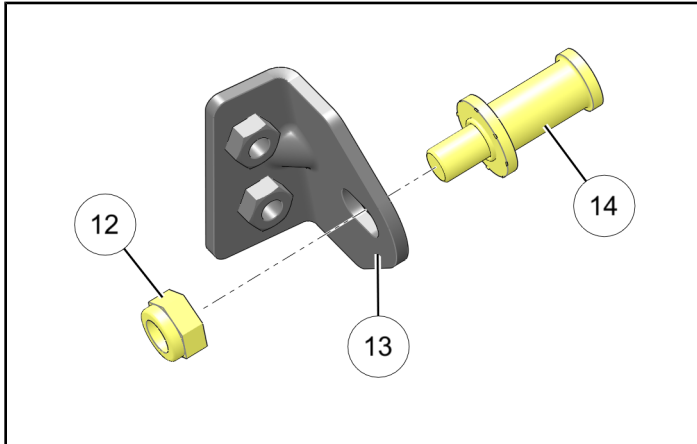

3. Install LH striker bracket ⑬ to chassis using two screws ⑧. Center bracket in slots, then tighten screws. Final adjustment will occur later.

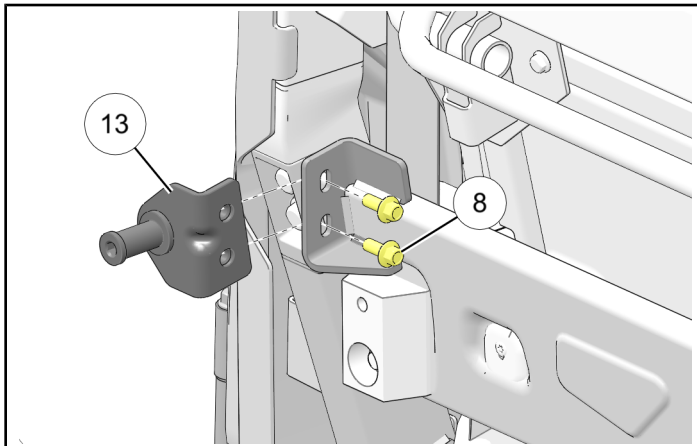

Adjust striker pin ⑭ and/or striker bracket ⑬ to achieve the following:

- a. **HEIGHT (L)**: Pin ⑭ should be centered vertically between upper and lower pawls. To adjust, loosen two screws ⑧, slide striker bracket ⑬ up or down as required, then retighten screws.
- b. **DEPTH (N)**: As required to achieve desired seal compression and door fairing. To adjust, loosen nut ⑫, slide striker pin ⑭ inboard or outboard as required, then retighten nut.

Ensure depth adjustment is made with door at FULL closure as shown (second “click”), not at partial closure (first “click”).

#### NOTE

Nut can be accessed by reaching up from below striker bracket.

Bracket shown partially transparent for clarity.

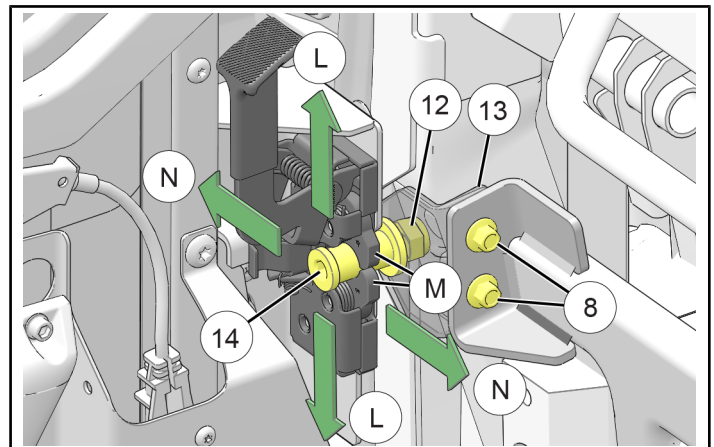

## DOOR STRIKER ADJUSTMENT

1. Open door latch (to ensure upper and lower pawls ⑮ are fully opened), then slowly close door and observe striker pin ⑭ entering latch assembly.

2. Torque striker screws ⑧ to specification.

#### TORQUE

**17 ft-lbs (23 N·m)**

3. Torque striker nut ⑫ to specification.

#### TORQUE

**30 ft-lbs (41 N·m)**

## FEEDBACK FORM

A feedback form has been created for the installer to provide any comments, questions or concerns about the installation instructions. The form is viewable on mobile devices by scanning the QR code or by clicking [HERE](#) if viewing on a PC.

