

PREMIUM DOOR KIT



P/N 2882561; 2882562; 2884275; 2884338; 2889624;
2889626; 2889683

BEFORE YOU BEGIN

Read these instructions and check to be sure all parts and tools are accounted for. Please retain these installation instructions for future reference and parts ordering information.

REQUIRED, SOLD SEPARATELY

This kit only contains parts for installation of the Premium Door Kit. If installing Kit P/Ns 2882562 or 2884338, then prior installation of the Pulse™ Roof 6 Kit, P/N 2882904, is also required (sold separately).

KIT CONTENTS

NOTICE

Kit P/N 2882562 shown; other kits similar except as noted below.

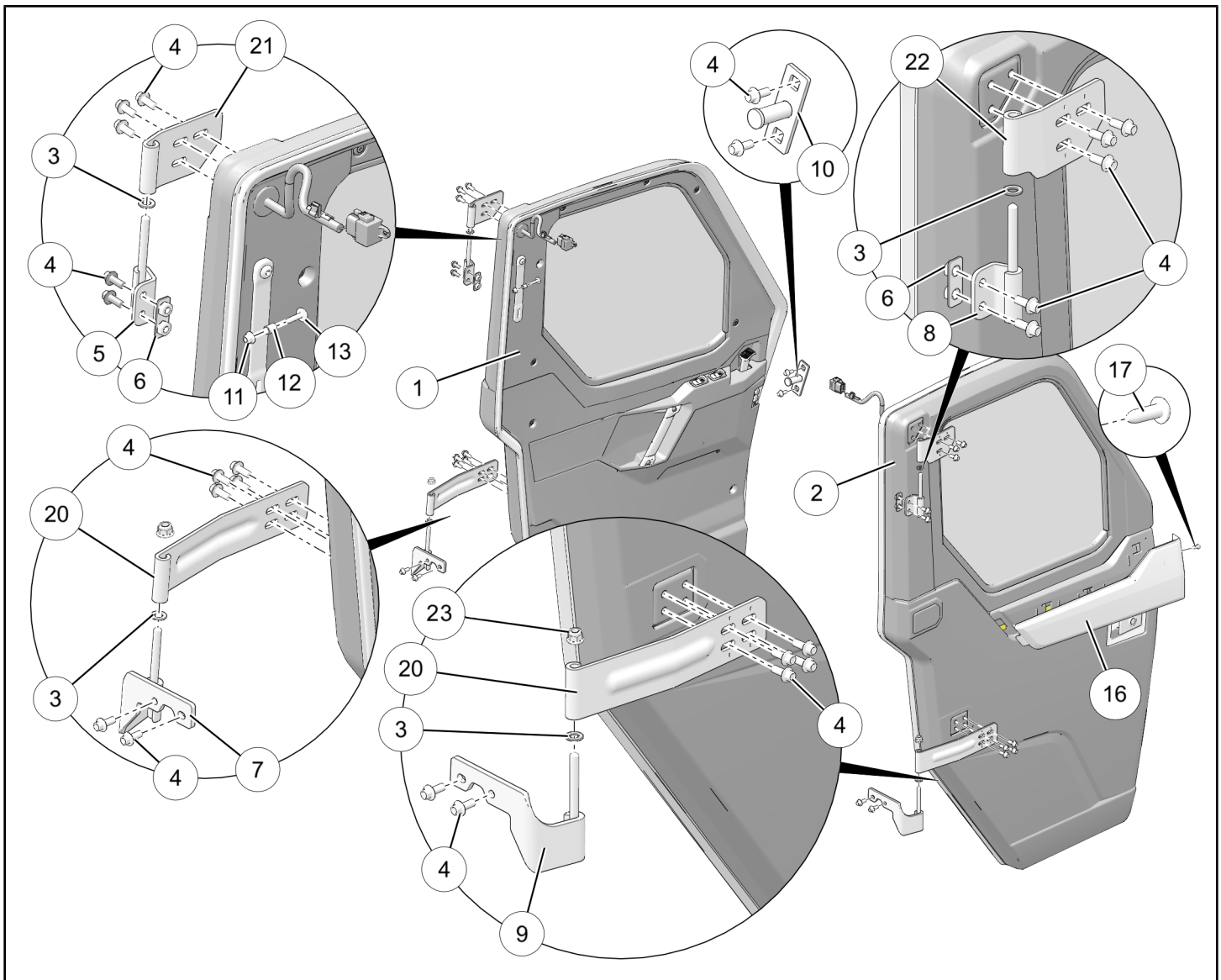

NOTICE

LH door shown (from Kit PN 2882562); other LH and RH doors similar except as noted below.
Interior door panels hidden for clarity.

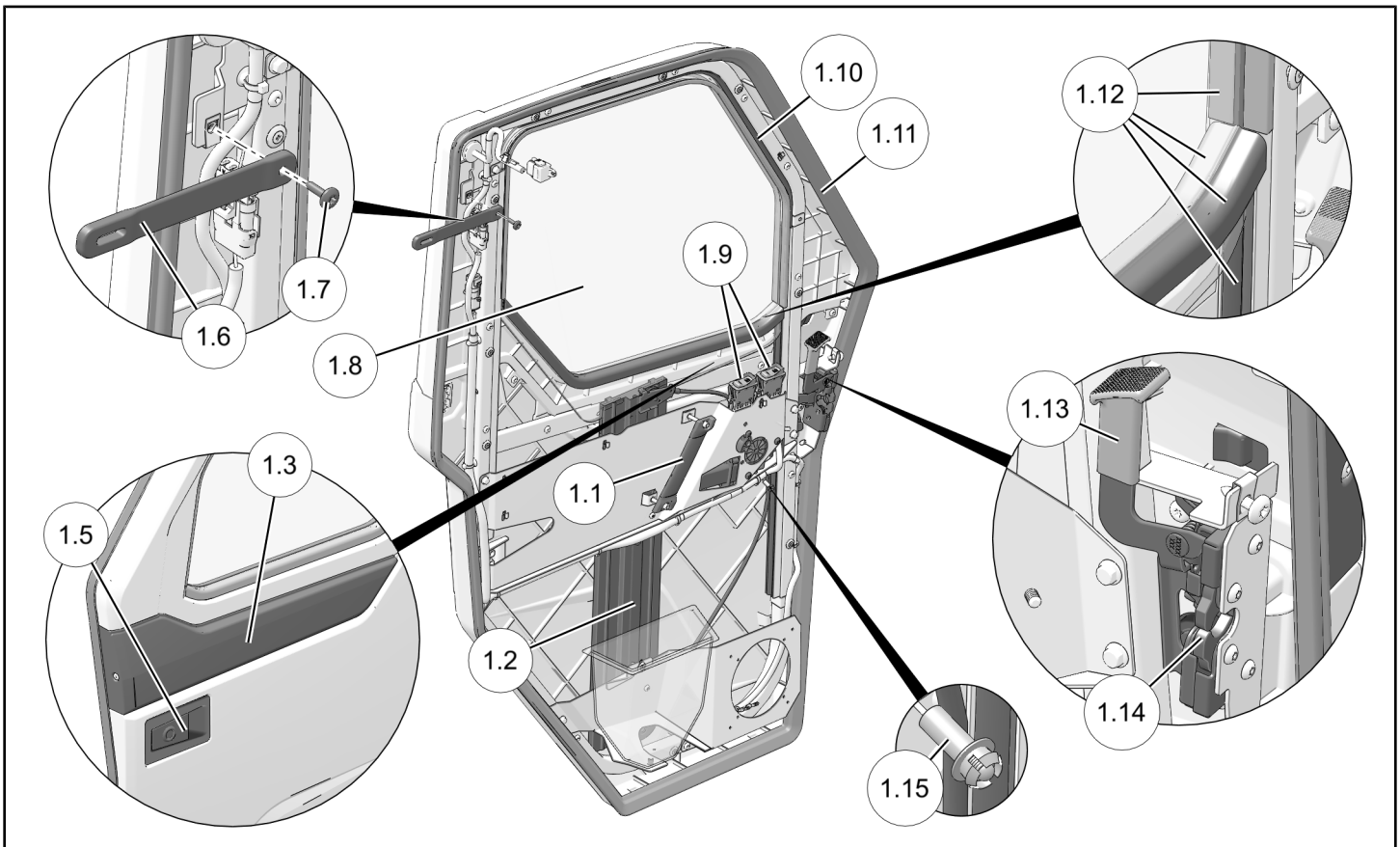

| REF | QTY | PART DESCRIPTION | PART NUMBER | INCLUDED IN SERVICE KIT |
|-----|-----|---|-------------|-------------------------|
| 1 | 1 | Door Assembly, LH (includes items 1.1 through 1.16 except as noted below) | n/a | n/a |
| 1.1 | 1 | - Handle, Grab, LH | n/a | 2207714** |
| 1.2 | 1 | - Regulator Assembly, LH (2882562, 2884338 only) (not shown) | n/a | 2207756* |
| | 1 | - Regulator Assembly, LH (2882561, 2884275 only) (not shown) | | 2207710* |
| 1.3 | 1 | - Panel, Accent, LH (2884275-133 only) | 5453999-133 | n/a |
| | 1 | - Panel, Accent, LH (2884275-453 only) | 5453999-453 | |
| 1.5 | 1 | - Latch Assembly, Exterior (2282561, 2882562, 2884338 only) | n/a | 2207716* |
| | 1 | - Latch Assembly, Exterior (2884275, 2889683 only) | 7082545 | - |
| 1.6 | 1 | - Strap, Limiter | n/a | 2205280** |
| 1.7 | 1 | - Screw, Torx® Truss Head - M6 X 1.0 X 25 | 7519650 | |
| 1.8 | 1 | - Glass | n/a | 2207713* |
| 1.9 | 1-2 | - Switch (2882562, 2884338 only) | n/a | 2207758* |

| REF | QTY | PART DESCRIPTION | PART NUMBER | INCLUDED IN SERVICE KIT |
|------|-----|--|----------------------------|-------------------------|
| 1.10 | 1 | - Seal, Glass Upper | n/a | 2207718* |
| 1.11 | 1 | - Seal, Door, Full Perimeter | n/a | |
| 1.12 | - | - Kit, Glass Seal (contains one each as shown) | n/a | 2883782 |
| 1.13 | 1 | - Handle, Latch | n/a | 2207715** |
| 1.14 | 1 | - Latch Assembly, Interior, LH | n/a | |
| 1.15 | 1 | - LED, Blue (2882562, 2884338 only) | n/a | 2207758* |
| 1.16 | 1 | - Crank, Window (2882561, 2884275 only) (not shown) | n/a | 2207712** |
| 2 | 1 | Door Assembly, RH (includes items 2.1 through 2.3, 2.14; all other parts same as those identified in 1.x above) | n/a | n/a |
| 2.1 | 1 | - Handle, Grab, RH (not shown) | n/a | 2207714** |
| 2.2 | 1 | - Regulator Assembly, RH (2882562, 2884338 only) (not shown) | n/a | 2207757* |
| | 1 | - Regulator Assembly, LH (2882561, 2884275 only) (not shown) | | 2207711* |
| 2.3 | 1 | - Panel, Accent, RH (2884275-133 only) (not shown) | 5454000-133 5454000-453 | - |
| | 1 | - Panel, Accent, RH (2884275-453 only) (not shown) | | - |
| 2.14 | 1 | - Latch Assembly, Interior, RH (not shown) | n/a | 2207715** |
| 3 | 4 | Washer, Nylon - 10.25 X 19.0 X 2.0 | 5439712 | 2207709** |
| 4 | 26 | Screw, Hex Flange - M8 X 1.25 X 20 | 7519936 | 2207708 (qty: 8) |
| 5 | 1 | Hinge, Chassis-Side, Upper LH | n/a | 2207709** |
| 6 | 2 | Nut Plate, Upper Chassis Side Hinge | 5256140 | n/a |
| 7 | 1 | Hinge, Chassis-Side, Lower LH | n/a | 2207709** |
| 8 | 1 | Hinge, Chassis-Side, Upper RH | | |
| 9 | 1 | Hinge, Chassis-Side, Lower RH | | |
| 10 | 2 | Striker | n/a | 2207717* |
| 11 | 2 | Nut, Hex Flange, Locking - M6 X 1.0 | 7547339 | 2205280** |
| 12 | 2 | Spacer | 5139193 | |
| 13 | 2 | Screw, Torx® Truss Head - M6 X 1.0 X 25 | 7519650 | |
| 14 | 1 | Harness, Door Crossover (2882562, 2884338 only) (not shown) | 4017096 | n/a |
| 15 | 1 | Panel, Door Accent, LH (2882561, 2882562, 2884338, 2889624 only) (not shown) | 5453999-070 5453999-453 | n/a |
| | 1 | Panel, Door Accent, LH (2889683 only) (not shown) | | n/a |
| | | | | |

| REF | QTY | PART DESCRIPTION | PART NUMBER | INCLUDED IN SERVICE KIT |
|-----|-----|---|-------------|-------------------------|
| 16 | 1 | Panel, Door Accent, RH (2882561, 2882562, 2884338, 2889624 only) | 5454000-070 | n/a |
| | 1 | Panel, Door Accent, RH (2889683 only) (not shown) | 5454000-453 | n/a |
| 17 | 2 | Screw, Torx® Truss Head, #14 X 3/4 (2882561, 2882562, 2884338 only) | 7519045 | n/a |
| 18 | 1 | Push Dart (2882562, 2884338 only) (not shown) | 7670088 | n/a |
| 19 | 1 | Cab Seal Kit (not shown) | 2883253 | n/a |
| 20 | 2 | Hinge, Door-Side, Lower | n/a | 2207708** |
| 21 | 1 | Hinge, Door-Side, Upper LH | n/a | |
| 22 | 1 | Hinge, Door-Side, Upper RH | n/a | |
| 23 | 2 | Nut-Flange – M8x1.25 | 7547454 | 2207709** |

* Service kit contains parts and hardware required for ONE side of vehicle.

** Service kit contains parts and hardware required for BOTH sides of vehicle.

TOOLS REQUIRED

- Safety Glasses
- Pliers, Push Pin Rivet
- Push Dart (Panel Clip) Tool
- Screwdriver Set, Torx®
- Socket Set, Metric
- Torque Wrench
- Wrench Set, Metric

CONSUMABLES REQUIRED

- Gloves, Chemical Resistant
- Grease, Polaris All Season (or equivalent)

IMPORTANT

Your Premium Door Kit is exclusively designed for your vehicle. Please read the installation instructions thoroughly before beginning. Installation is easier if the vehicle is clean and free of debris. For your safety, and to ensure a satisfactory installation, perform all installation steps correctly in the sequence shown.

HARNESS DETAIL

DOOR CROSSOVER HARNESS ⑭:

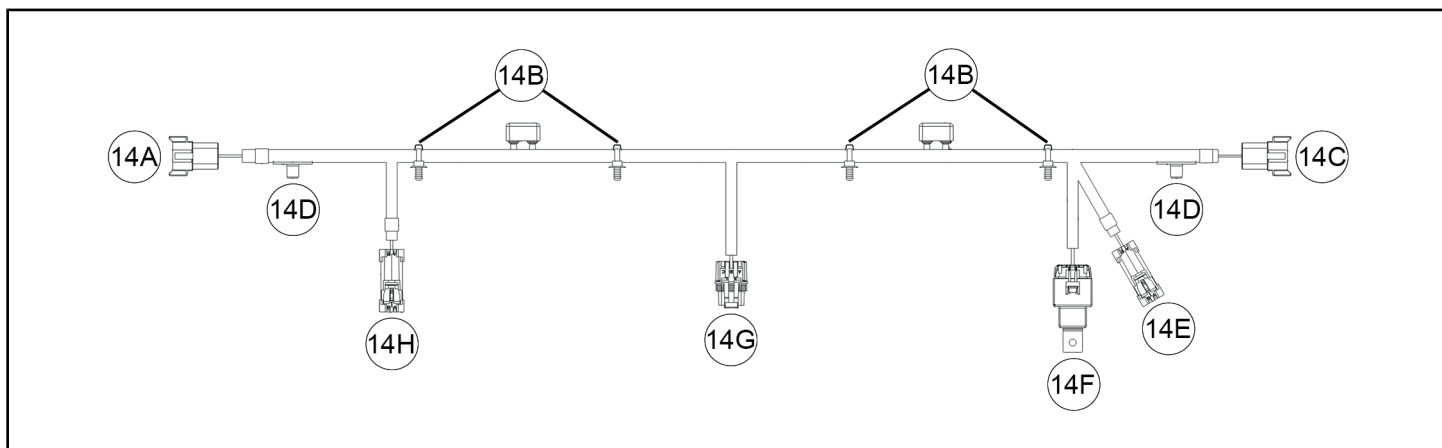

| REF | PART DESCRIPTION | WIRE COLOR | PIN QTY/ GENDER | CONNECTS TO |
|-----|---|------------|--------------------|--|
| 14A | Connector, Window Crossover, LH (identified as: LH DOOR) | - | 8 male | LH door assembly ① |
| 14B | Clip, Routing | - | - | Vehicle structure |
| 14C | Connector, Window Crossover, RH (identified as: RH DOOR) | - | 8 male | RH door assembly ② |
| 14D | Clip, Edge (Spring) | - | - | Vehicle structure |
| 14E | Connector, Door Speaker, RH (with cap) (identified as: RH DOOR SPEAKER) | - | 2 male | OPTIONAL: Door Panel Speaker Kit (PN 2882889 or equivalent) |
| 14F | Relay | - | - | Vehicle structure |
| 14G | Connector, Terminal Block, Accessory Roof | - | 3 female | Pulse™ Roof 6 Kit, PN 2882904 (sold separately) |
| 14H | Connector, Door Speaker, LH (with cap) (identified as: LH DOOR SPEAKER) | - | 2 male | OPTIONAL: Door Panel Speaker Kit (PN 2882889 or equivalent) |

INSTALLATION INSTRUCTIONS

IMPORTANT

If installing doors on a **crew** vehicle, Polaris recommends installation of Crew Rear Door Kit (PN 2883437, 2884276, 2884439, or equivalent) **PRIOR TO** installation of this Front Door Kit. Installation of **FRONT** door hinges on **crew** vehicles is different from installation on **non-crew** vehicles.

NOTICE

Polaris recommends two people assemble and install this kit.

2. Install Cab Seal Kit ⑲ per instructions included with kit.
3. If installing CRANK Window Door Kit, then proceed to Step 4.
If installing POWER Window Door Kit, then remove rear roof liner (if installed) as follows:

NOTICE

Front roof liner can remain installed.

- a. Remove rear (roof mounted) speakers, if installed.

1. Shift vehicle transmission into "PARK". Turn ignition switch to "OFF" position and remove key.

- b. Remove seven push darts **(A)**, two from rear edge and five from front edge. Retain push darts.

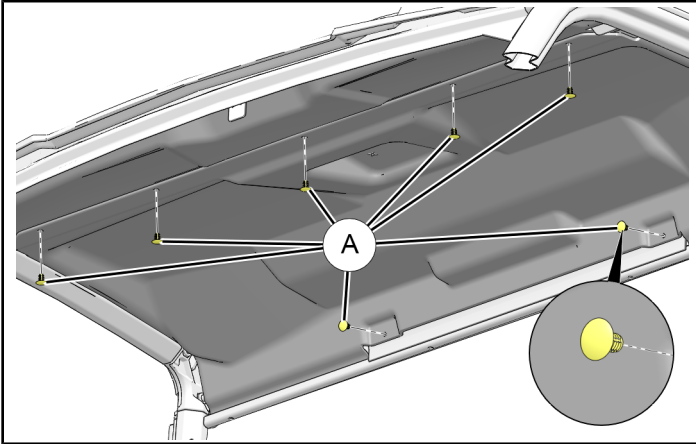

- c. If overhead light is installed against liner, remove it. Otherwise, remove two each screws **(B)** and washers **(C)**. Retain hardware.

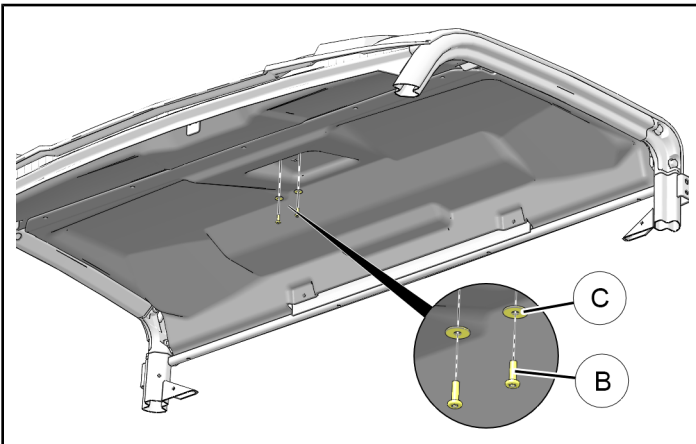

- d. Carefully pull LH and RH edges of liner from between ROPS and roof seal, then remove rear edge of liner from roof support channel **(D)**.

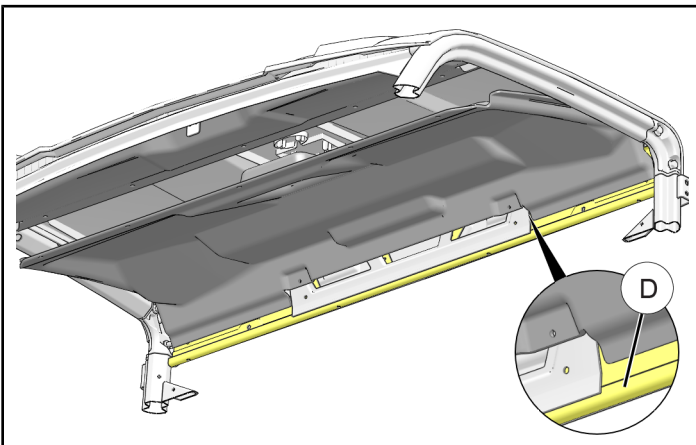

4. Install door-side hinges.

- a. Identify upper **LH** door-side hinge **(21)**. Notice differences from upper **RH** door-side hinge **(22)**.

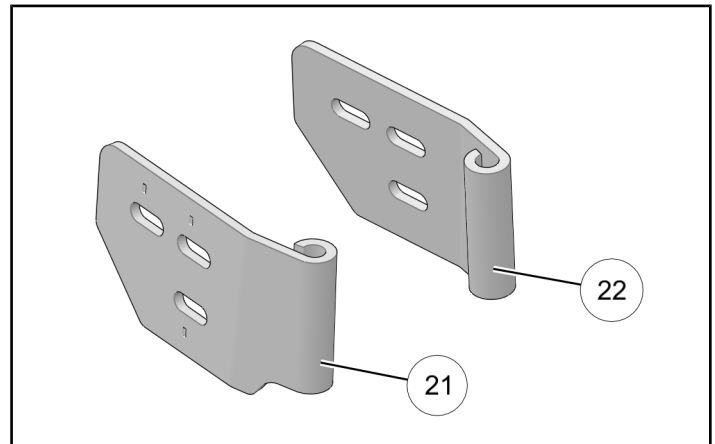

- b. Loosely install upper left door hinge **(21)** to left door **(1)** with three screws **(4)**.

Do not torque fasteners at this time.

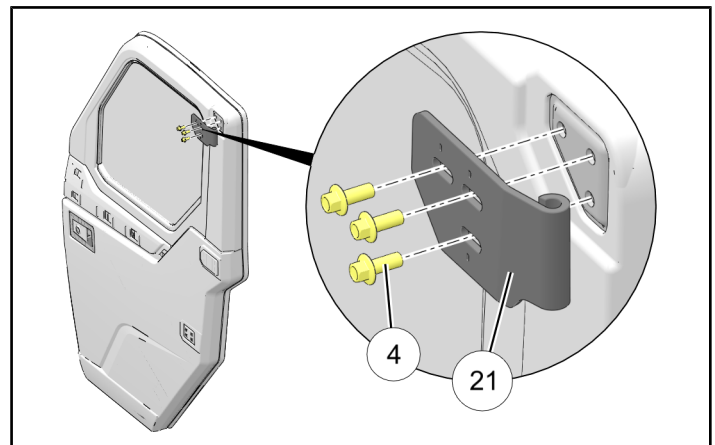

- c. Loosely install upper left door hinge **(20)** to left door **(1)** with three screws **(4)**.

Do not torque fasteners at this time.

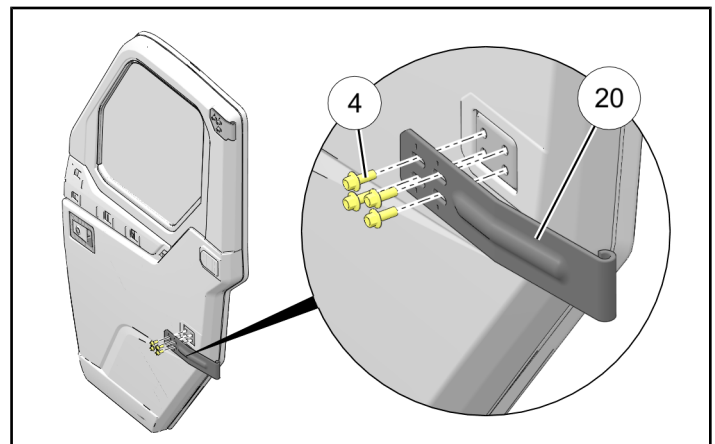

5. Install chassis-side hinges.

- a. Raise vehicle bed.

- b. Identify upper **LH** chassis-side hinge ⑤. Notice differences from upper **RH** chassis-side hinge ⑧.

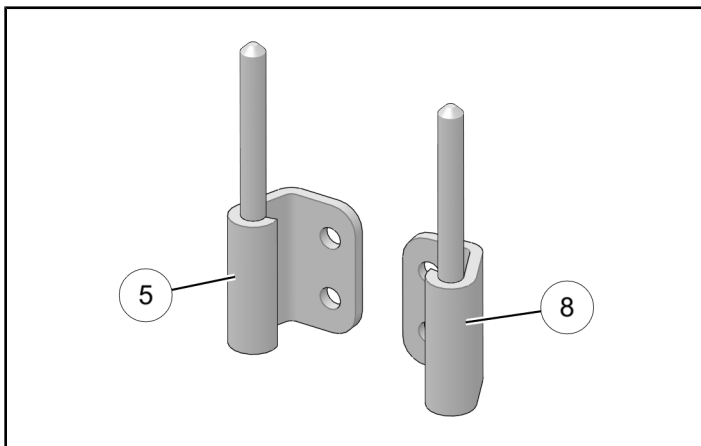

- c. Loosely install upper left chassis-side hinge ⑤ using two screws ④ and nut plate ⑥.

Do not torque fasteners at this time.

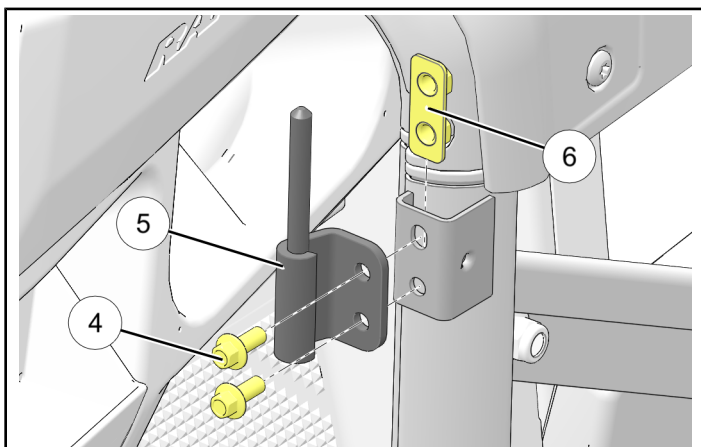

- d. Install lower LH chassis-side hinge ⑦ using two screws ④. Loosely tighten screws.

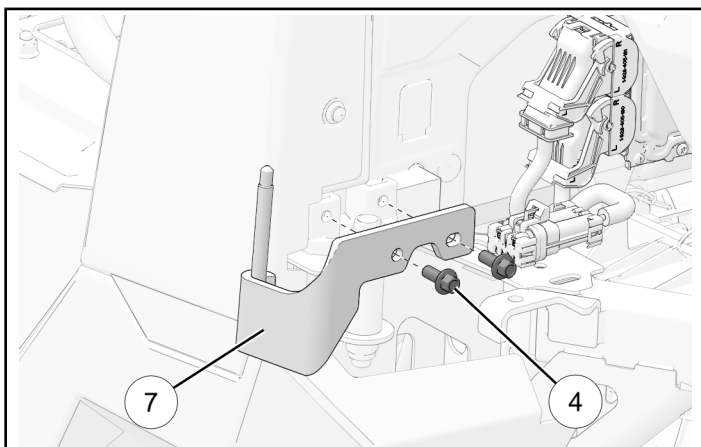

- e. Install nylon washer ③ to pins on upper and lower LH chassis-side hinges ⑤ and ⑦.

NOTICE

Washer acts as bearing surface to assist in smooth door operation.

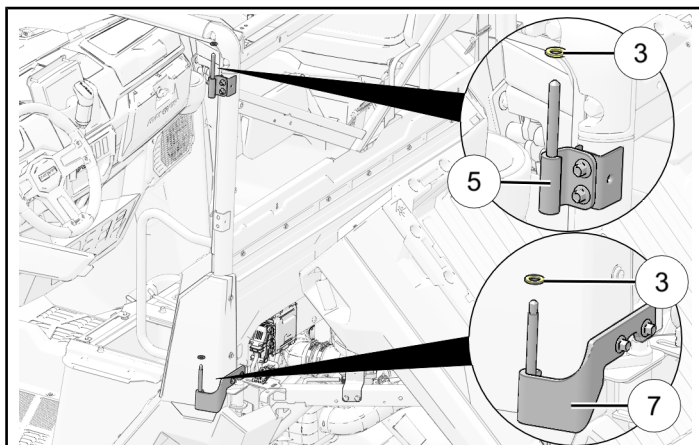

⚠ WARNING

Follow all chemical manufacturer instructions and safety precautions. Failure to follow all manufacturer instructions and precautions may result in severe injury or death.

- f. Grease pins on upper and lower chassis-side hinges ⑤ and ⑦ using Polaris All Season Grease (or equivalent).

6. Install door.

- a. Install door assembly ① on lower chassis-side hinge ⑦ first, then upper chassis-side hinge ⑤.

NOTICE

Lower hinge pin is longer than upper hinge pin to aid door installation.

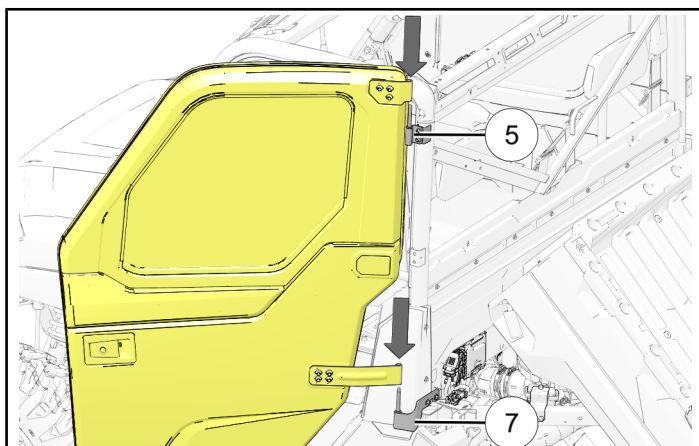

- b. Close and push door inward while centering door in ROPS/chassis opening, then loosely tighten all screws ④.

NOTICE

If necessary for height adjustment, remove one or both nylon washers ⑭.

TIP

Have one person hold and center the door, and a second person tighten the screws.

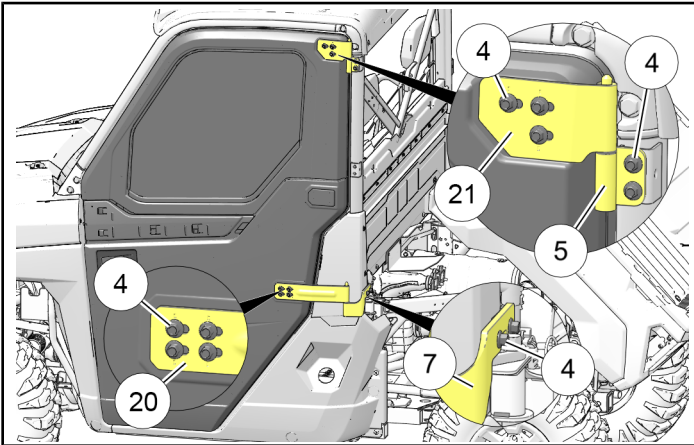

- c. Open and close door to ensure door is still centered in ROPS/chassis opening. Adjust as required.
- d. Torque all door-side and chassis-side hinge screws ④ to specification.

TORQUE

17 ft-lbs (23 N·m)

- e. Install the nut ⑮ on the pivot hinge. Torque to specification.

TORQUE

19 ft-lbs (26 N·m)

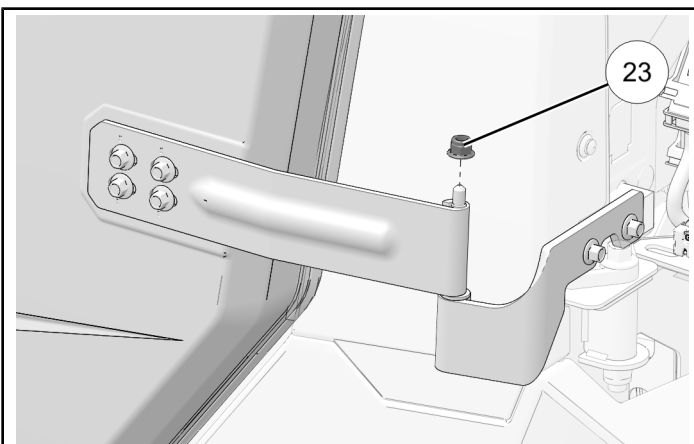

- f. Lower vehicle bed.

7. Install striker ⑩ to chassis using two screws ④. Center striker beneath screw heads, then loosely tighten screws.

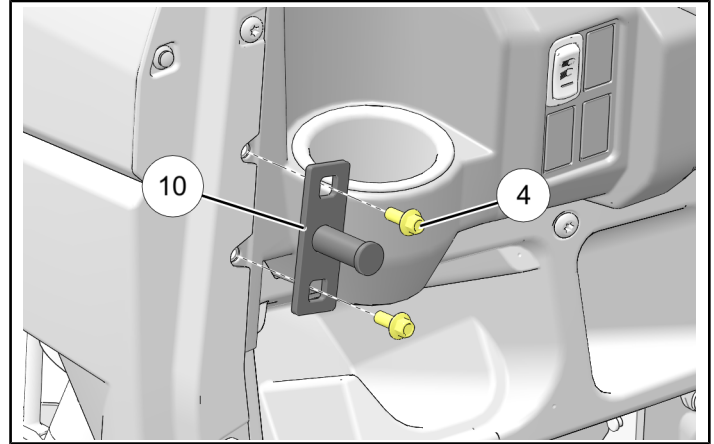

8. Install limiter strap ① retaining post to ROPS diagonal support using screw ⑬, spacer ⑫, and nut ⑪. Torque to specification, then secure strap to post.

TORQUE

7 ft-lbs (9 N·m)

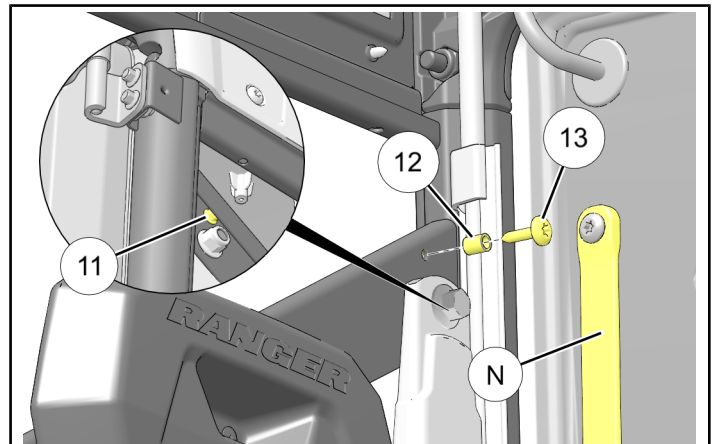

9. If not already installed, install accent panel ⑮ to door by inserting over tabs in door. Attach with screw ⑰. Torque to specification.

TORQUE

18 in-lbs (2 N·m)

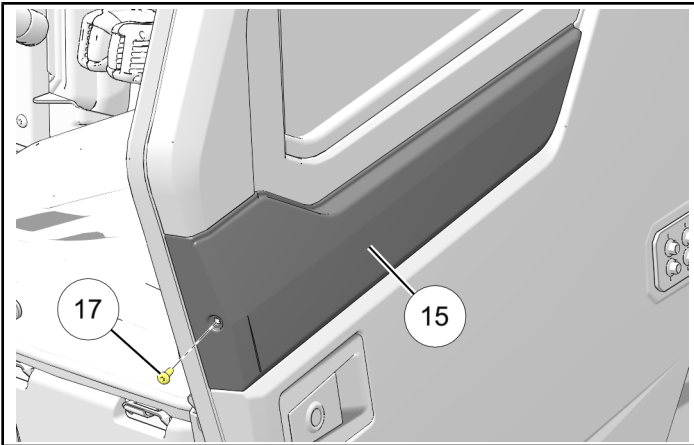

10. Repeat Steps 4–9 for RH door assembly ② using hinges ⑧ ⑨ ⑳ ㉑, and accent panel ⑯ (if not pre-installed).
11. Lower vehicle bed.
12. If installing CRANK Window Door Kit, then installation is complete.

POWER WINDOW CROSSOVER HARNESS INSTALLATION

Install crossover harness ⑭ as follows:

NOTICE

See page 5 for connector identification.

1. Remove cap from LH door connector ⑪, then join to LH window crossover connector 14A (identified as: **LH DOOR**).

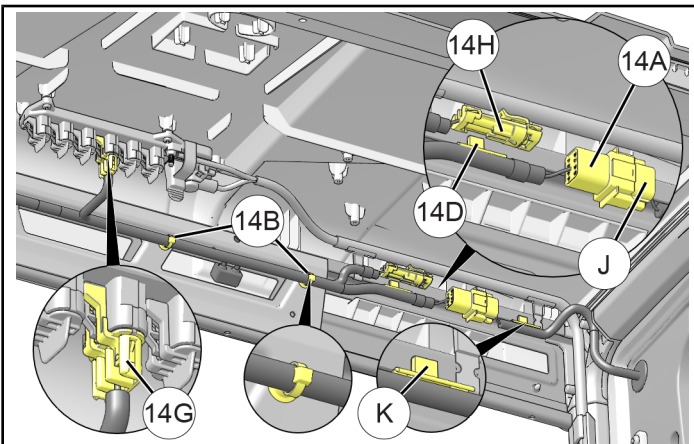

2. **OPTIONAL:** If installing Door Speaker Kit (PN 2882889 or equivalent), then remove cap from connector 14H (identified as: **LH DOOR SPEAKER**) and join to LH door speaker harness.
3. Open power cap on roof-mounted Pulse™ terminal block at any open location, then plug in connector 14G.
4. Secure LH side of harnesses to ROPS cross-member using edge clips ⑫ and 14D, and two routing clips 14B.
5. Remove cap from LH door connector ⑬, then join to RH window crossover connector 14C (identified as: **RH DOOR**).

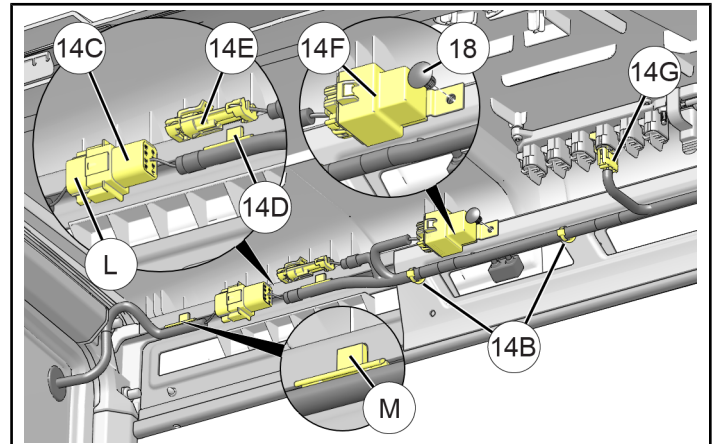

6. **OPTIONAL:** If installing Door Speaker Kit (PN 2882889 or equivalent), then remove cap from connector 14E (identified as: **RH DOOR SPEAKER**) and join to RH door speaker harness.
7. Secure relay 14F to ROPS cross-member using push dart ⑱.
8. Secure RH side of harnesses to ROPS cross-member using edge clips ⑭ and 14D, and two routing clips 14B.
9. Reinstall rear roof liner (if removed).

DOOR STRIKER ADJUSTMENT

1. Open door latch (to ensure upper and lower pawls ⑤ are fully opened), then slowly close door and observe striker pin ⑥ entering latch assembly.
Adjust striker ⑩ to achieve the following:
 - a. **HEIGHT** ⑥: Pin ⑥ should be centered vertically between upper and lower pawls. To adjust, loosen two screws ④, slide striker ⑩ up or down as required, then retighten screws.

- b. **DEPTH** ^(H): As required to achieve desired seal compression and door fairing. To adjust, loosen two screws ⁽⁴⁾, slide striker ⁽¹⁰⁾ inboard or outboard as required, then retighten screws.

Ensure depth adjustment is made with door at **FULL** closure as shown (second “click”), not at partial closure (first “click”).

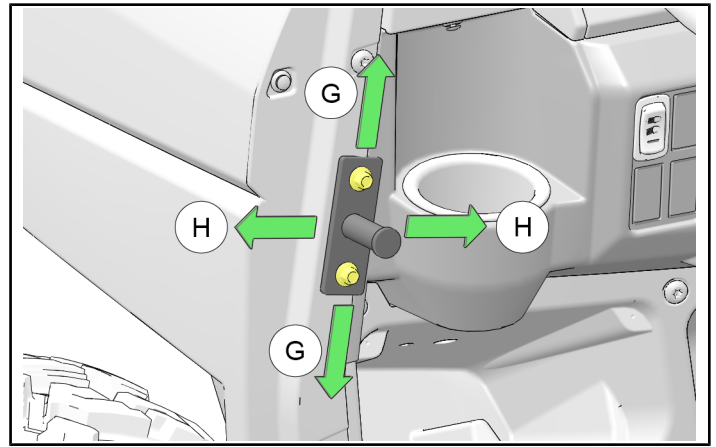
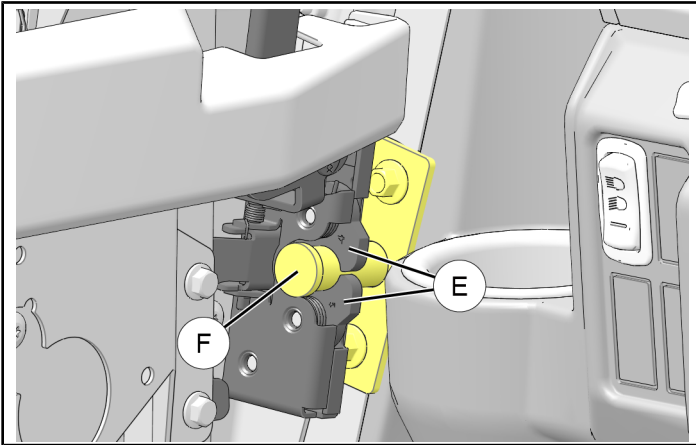

2. Torque striker screws ⁽⁴⁾ to specification.

| TORQUE |
|--------------------|
| 17 ft-lbs (23 N·m) |

FEEDBACK FORM

A feedback form has been created for the installer to provide any comments, questions or concerns about the installation instructions. The form is viewable on mobile devices by scanning the QR code or by clicking [HERE](#) if viewing on a PC.

