

POLY TIP-DOWN WINDSHIELD KIT



P/N 2883261; 2884139

MISSING OR DAMAGED PARTS

Before beginning assembly, inspect the kit and its component(s) to be sure all parts and tools are accounted for and not damaged. If missing parts or parts are damaged, please contact your Selling Dealer for assistance.

If your accessory was purchased online, please contact POLARIS® customer service at **1-800-POLARIS** (US & Canada only).

APPLICATION

Verify accessory fitment at www.polaris.com.

KIT CONTENTS

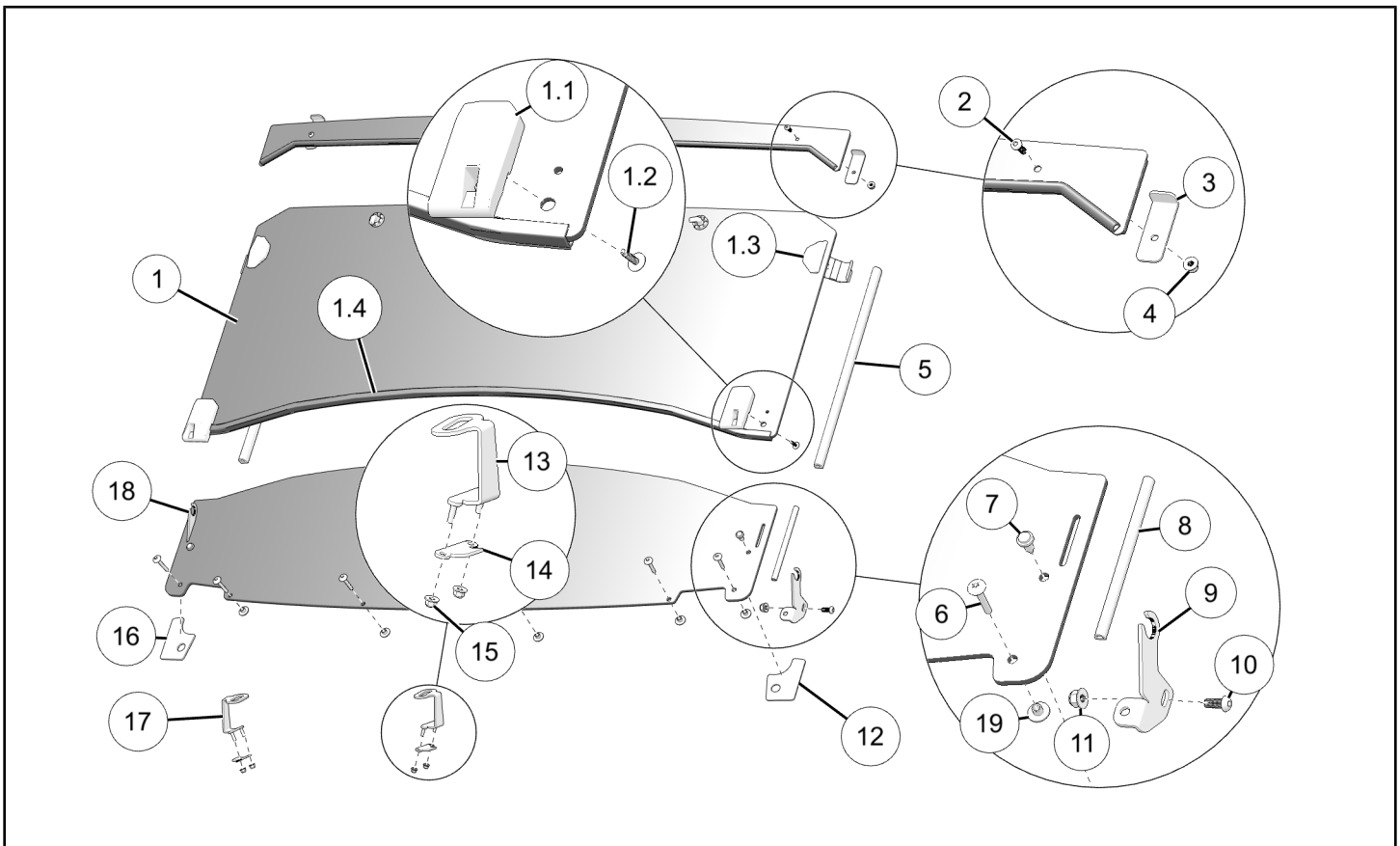

REF	QTY	PART DESCRIPTION	P/N AVAILABLE SEPARATELY	AVAILABLE SERVICE KIT
1	1	Windshield, Tip-Down, Poly (includes items 1.1–1.4 below)	2636974	n/a
1.1	1	– Hinge (includes one each Left and Right)	n/a	2207475
1.2	2	– Screw, Torx® Truss Head - 10–12 X 3/4	n/a	2207475
1.3	2	– Clamp Assembly	n/a	2208467
1.4	1	– Seal, 3/8 Inch Side Bulb with 0.177 inch Carrier (4.25 ft)	n/a	2207476

REF	QTY	PART DESCRIPTION	P/N AVAILABLE SEPARATELY	AVAILABLE SERVICE KIT
2	2	Screw, Socket Button Head, M6 x 1.0 x 20 mm	n/a	n/a
3	2	Bracket, Visor	n/a	2207475
4	2	Nut, Hex Flange, Locking, M6 x 1.0 mm	n/a	n/a
5	1	D-Seal, 0.625 x 0.625 mm, Adhesive (3 ft)	n/a	2207476
6	6	Screw, M6 x 1 x 40 mm	7519001	2211849
7	2	Rivet, Push Pin (Short)	n/a	n/a
8	1	D-Seal, 0.375 x 0.31 mm , Adhesive (1.17 ft)	n/a	2207476
9	1	Bracket, Hinge, Left	n/a	2207475
10	2	Nut, Hex Flange, Locking, M8 x 1.25 mm	n/a	n/a
11	2	Screw, Socket Button Head, M8 x 1.25 x 20 mm	n/a	n/a
12	1	Seal, Adhesive, Left	5814712	n/a
13	1	Bracket, Windshield Hold-Down, Left	n/a	2207475
14	2	Backer Plate, Windshield Hold-Down Bracket	n/a	2207475
15	4	Nut, Hex Flange, Locking, M4 x 0.7 mm	n/a	n/a
16	1	Seal, Adhesive, Right	5814713	n/a
17	1	Bracket, Windshield Hold-Down, Right	n/a	2207475
18	1	Bracket, Hinge, Right	n/a	2207475
19	6	Shoulder Washer	n/a	2211849

TOOLS REQUIRED

- Safety Glasses
- Cutting Tool
- Drill
- Drill Bit:
 - 1/4 in (6 mm)
- Pliers, Push Pin Rivet
- Socket Set, Hex Bit, Metric
- Socket Set, Hex Bit, Metric, Ball-End
- Socket Set, Metric
- Wrench Set, Metric

IMPORTANT

Your Poly Tip-Down Windshield Kit is exclusively designed for your vehicle. Please read the installation instructions thoroughly before beginning. Installation is easier if the vehicle is clean and free of debris. For your safety, and to ensure a satisfactory installation, perform all installation steps correctly in the sequence shown.

INSTALLATION INSTRUCTIONS

VEHICLE PREPARATION

GENERAL

1. Park vehicle on a flat surface.
2. Shift vehicle into PARK.
3. Turn key to OFF position and remove key.
4. Remove hood.

5. Make sure vehicle ROPS is at room temperature (≥68° F) for proper application of adhesive seals.

ACCESSORY INSTALLATION

1. Install windshield visor panel **A** to ROPS visor using two brackets **3**, screws **2**, and nuts **4**.

Make sure windshield visor panel is centered left to right, and gap is even along top, then tighten fasteners.

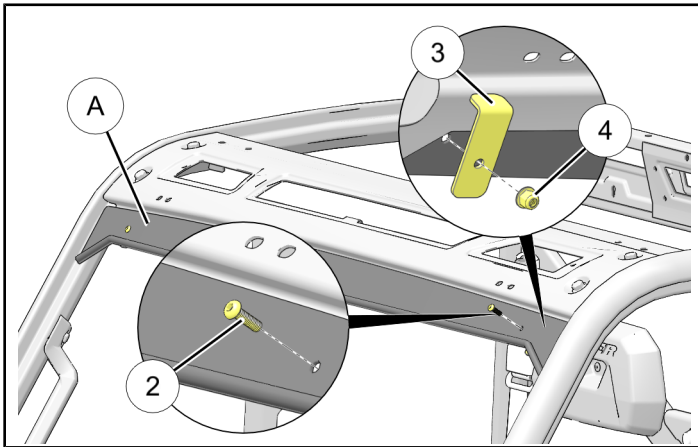

2. Remove and discard six screws **B** along forward edge of dash.

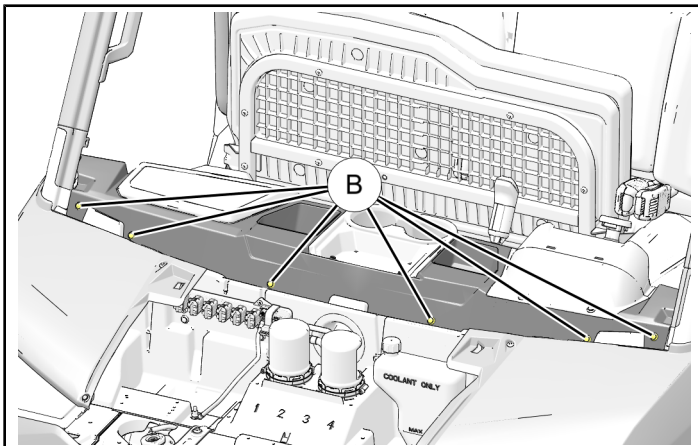

3. Install left seal **12** by cleaning installation surface as required, peel off adhesive backing, butt lower seal edge against upper dash and outboard seal edge against ROPS fitting. Press seal firmly into place.

Repeat for right side using seal **16**.

NOTICE

Left side shown; right side similar.

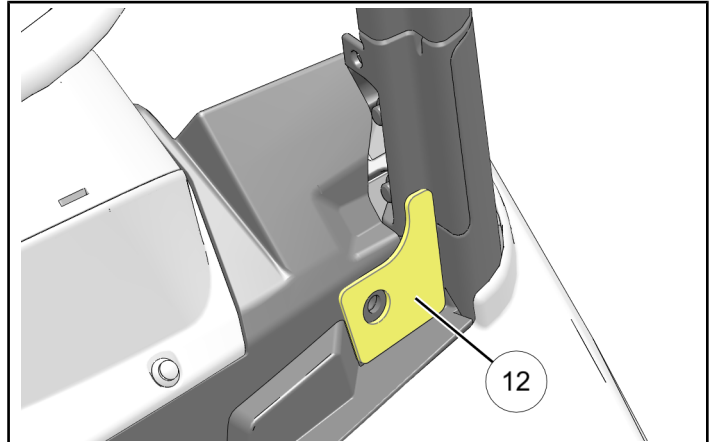

4. Loosely install left hinge bracket **9** to mounting ear on ROPS A-pillar fitting using one each screw **11** and nut **10**.

Repeat for right side using right hinge bracket **18**.

TIP

Temporarily block gap between ROPS fitting and upper dash with clean cloth or tape to prevent nut from accidentally falling behind dash.

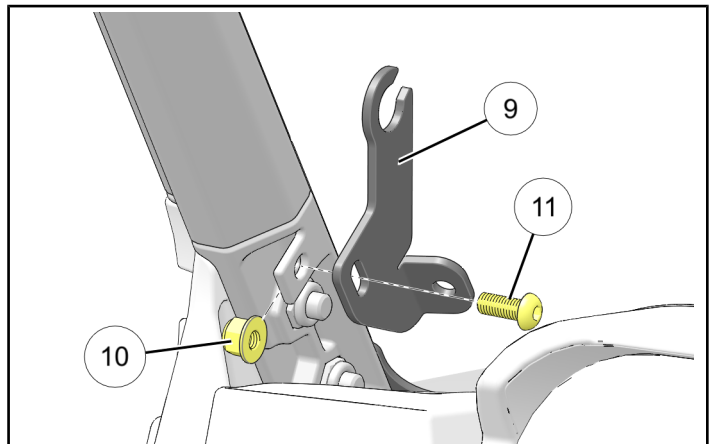

- Temporarily install windshield dash panel (C) over both hinge brackets (9) and (18), centering panel left to right, and aligning panel with six screw holes along lower edge. Mark location where panel UPPER edge (D) contacts ROPS. Repeat for opposite side, then remove panel.

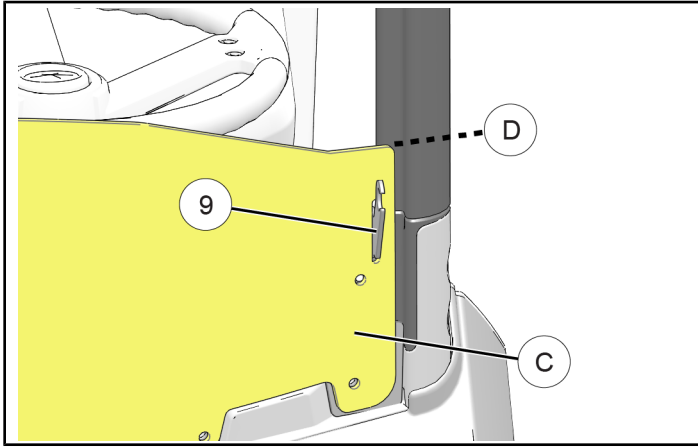

- Cut SMALLER D-seal (8) in half. Install seal by cleaning installation surface as required, peel off adhesive backing, align upper end of seal with mark (D), then press seal firmly into place. Trim as required. Repeat for opposite side.

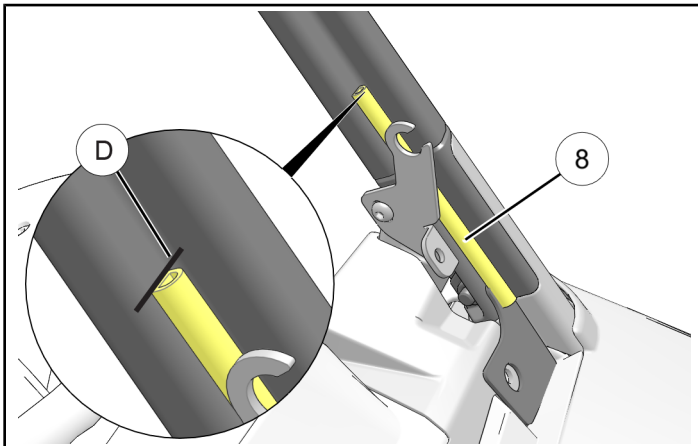

- Install six shoulder washers (19) on interior of windshield dash panel.

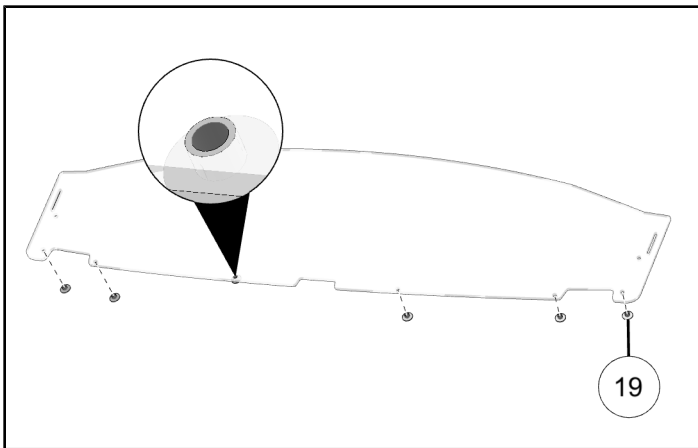

- Align lower windshield panel with screw holes on forward edge of dash. Install using six screws (6) through lower windshield panel into shoulder washers (19) and screw holes on forward edge of dash.

NOTICE

Make sure washer is in-between windshield and dash as shown, with shoulder engaged in windshield.

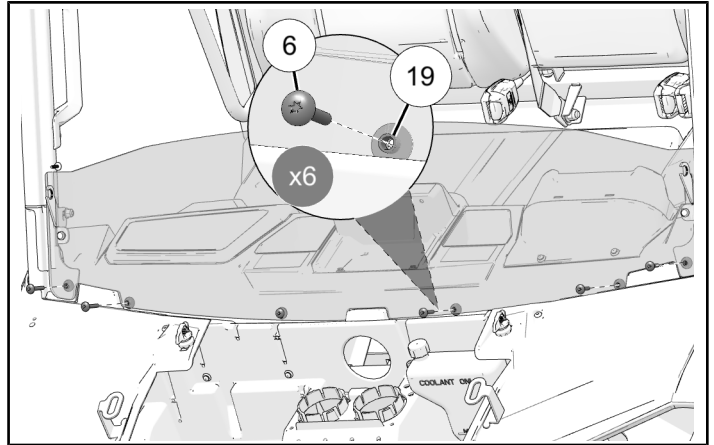

- Install windshield dash panel (C) over both hinge brackets (9) and (18), then secure with two SHORT push pin rivets (7).

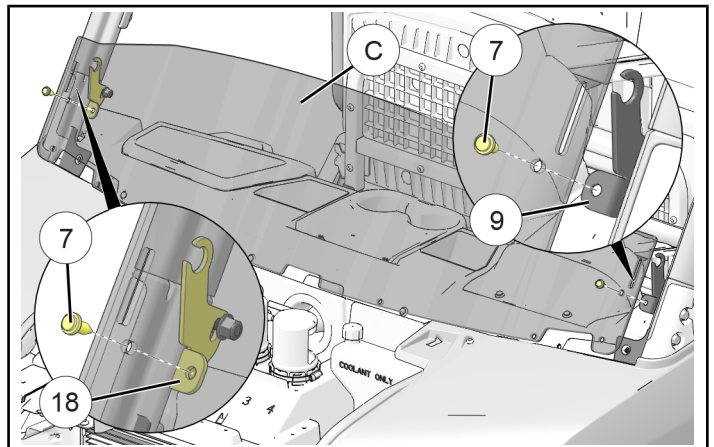

- Tighten screw (11) and nut (10) on each hinge bracket (9) and (18). See previous Step 4 for detail.

11. Cut D-seal ⑤ in half. Install seal by cleaning installation surface as required, peel off adhesive backing, apply to A-pillar between windshield visor panel ① and windshield dash panel ③, then press seal firmly into place. Trim as required. Repeat for opposite side.

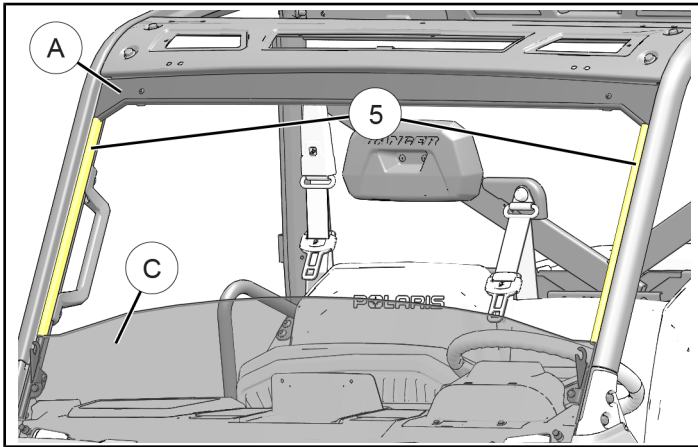

12. Position main windshield panel ⑩ as shown, then insert into hinge brackets ⑨ and ⑱.

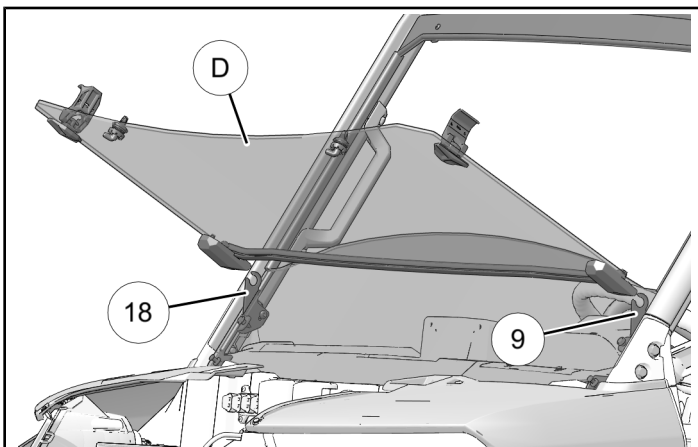

13. Open two clamps ⑥ and two knobs ⑦, tip main windshield panel ⑩ into ROPS, then lock clamps ⑥ to A-pillars and knobs ⑦ to windshield visor panel ①.

Adjust hinge brackets ⑨ and ⑱ as required to center windshield in ROPS opening.

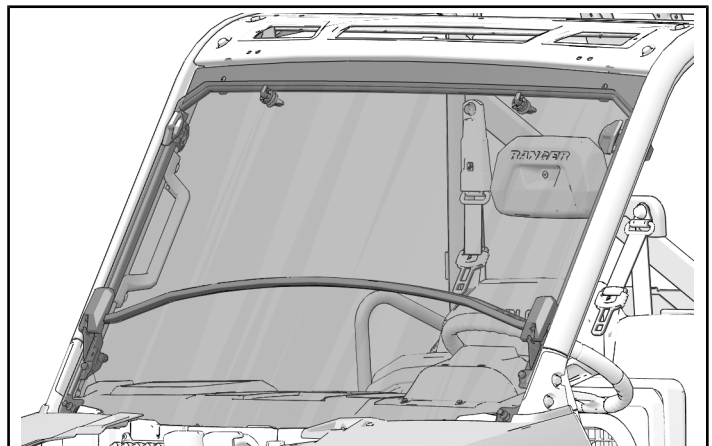
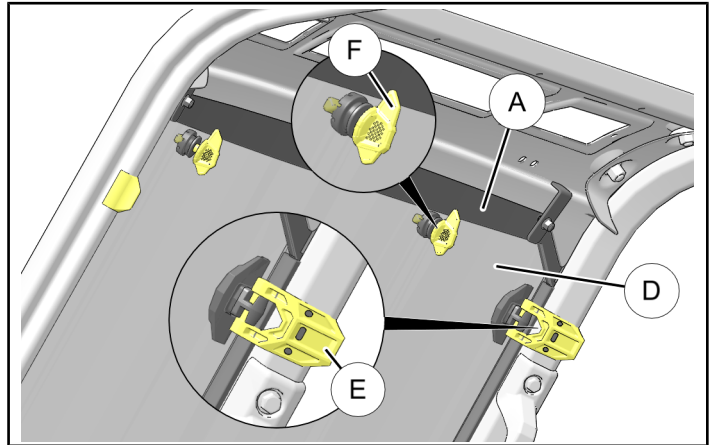

14. Install hold-down brackets.

- a. Lock left and right hold-down brackets ⑬ and ⑰ to knobs ⑦ on windshield.

Make sure lock lever at bottom of each knob is centered in bracket slot (left to right, and front to rear). Lock lever must be able to freely pass through slot when knob is unlocked.

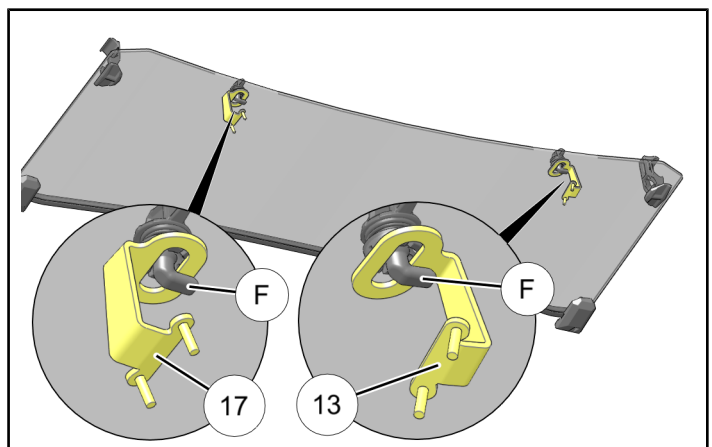

- b. Slowly tip windshield down, gently laying bracket studs against fenders.

Make sure installed bracket will be flush with ridge in fender as shown in next step, detail ⑥, then mark centerpoint of each stud ⑧ on fender.

Drill two 1/4 inch (6 mm) holes through fender at marked locations. Repeat for opposite side.

IMPORTANT

Control drill depth to prevent damage to underlying structure or components.

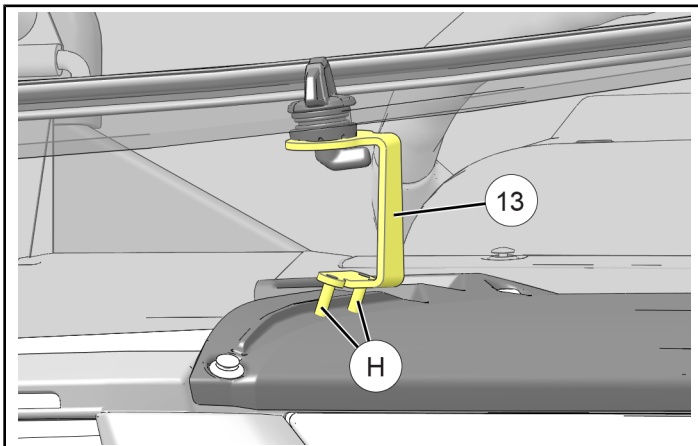

- c. Install left hold-down bracket ⑬ to fender using one backer plate ⑭ and two nuts ⑮. Repeat for right side using right hold-down bracket ⑰.

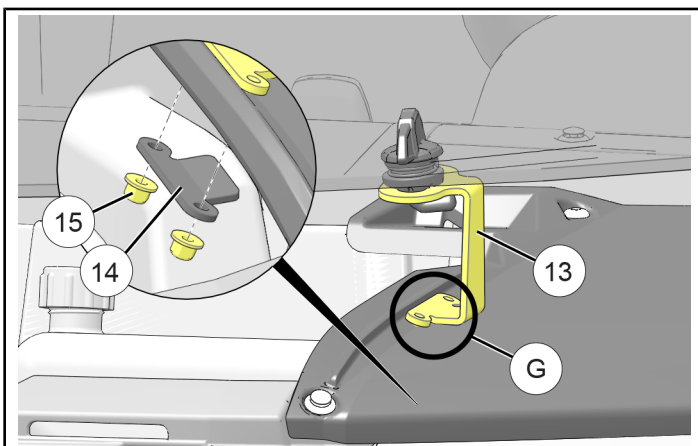

- d. Verify windshield locks and unlocks freely. Adjust as required.

15. Reinstall hood.

⚠ WARNING

If transporting vehicle in non-enclosed trailer then vehicle must FACE FORWARD, and windshield must be CLOSED (upright) and LOCKED to ROPS. Otherwise, windshield must be removed.

Failure to comply may allow airflow, vibration, or other factors to separate windshield from vehicle and cause an accident, resulting in serious personal injury or death.