

3500 WINCH KIT



P/N 2881671

APPLICATION

RZR XP 1000 All Model Years, 900 MY15 and Newer

NOTE

You must order power cables separately to connect your battery to the vehicle bus bar.

- MY14/15 2 Passenger models: 2879862
- MY14/15 4 Passenger models: 2880055
- MY16 2 Passenger models: 2881551
- MY16 4 Passenger models: 2881646

BEFORE YOU BEGIN

Read these instructions and check to be sure all parts and tools are accounted for. Please retain these installation instructions for future reference and parts ordering information.

KIT CONTENTS

This kit includes:

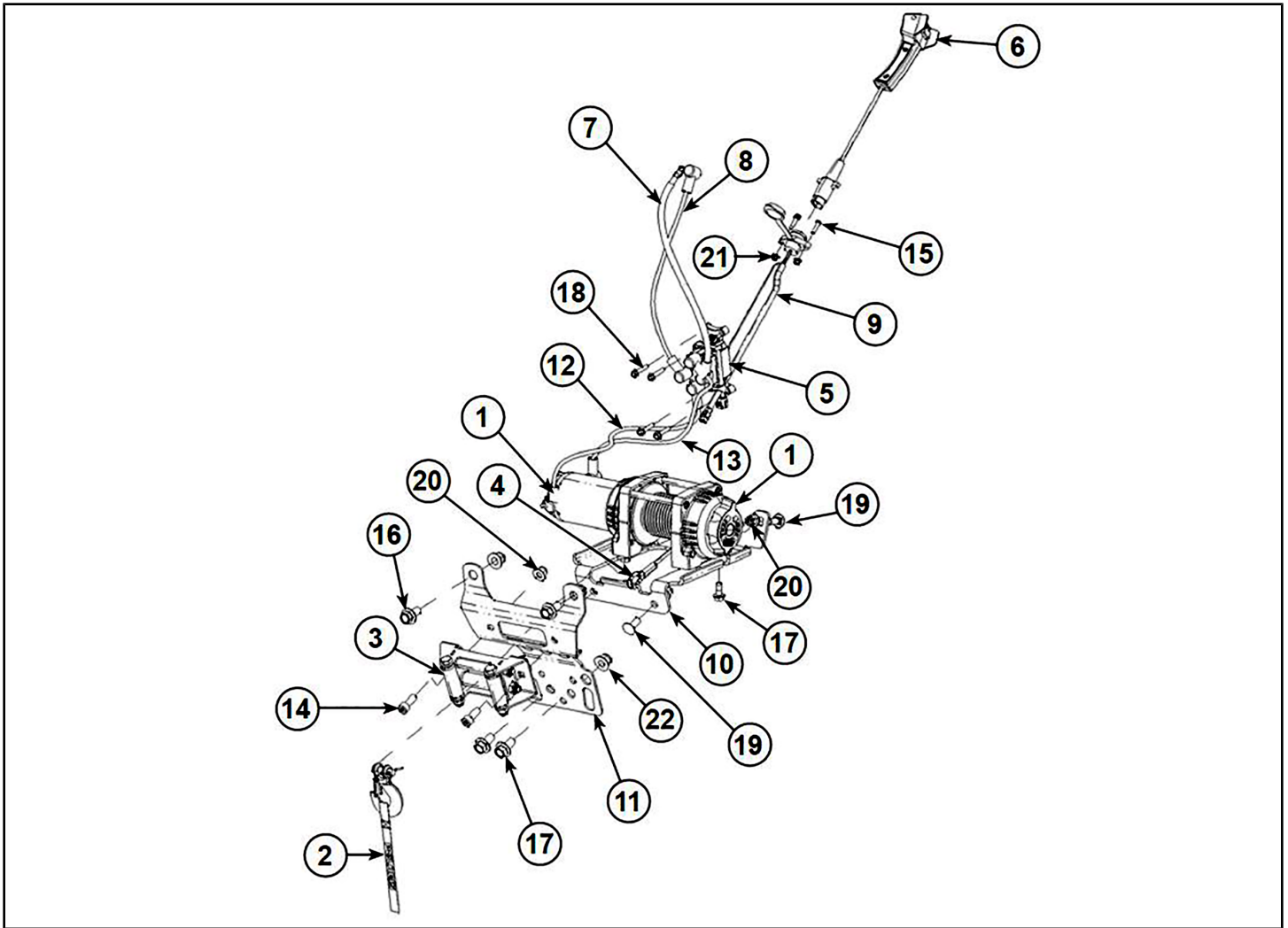

REF	QTY	PART DESCRIPTION	PART NUMBER
1	1	Winch-Polaris, 3.5	2204688
2	1	Hook-Latch, Winch	2411836
3	1	Roller-Fairlead, Winch	2411848
4	1	Cable-Winch, Steel, 3/16"	2878890
5	1	Contactora Winch	4015095
6	1	Remote-Switch, Winch	4013466
7	1	Power Cable, Winch, Black, 6 GA	4013470-375
8	1	Power Cable, Winch, Red, 6 GA	4013471-375
9	1	Remote Socket-Winch, Long	4014228
10	1	Mount Bracket-Winch	5257962
11	1	Fairlead Mount Bracket	5257963
12	1	Cable-Winch, Yellow, 6 GA	4013468-480
13	1	Cable-Winch, Blue, 6 GA	4013469-400
14*	2	Screw-SH-M10 X 1.5 X 25	-

REF	QTY	PART DESCRIPTION	PART NUMBER
15*	2	Screw-TXPH-M5 X 0.8 X 20	-
16*	4	Screw-HXFL-M12 X 1.75 X 25	-
17*	4	Screw-HXFL-M8 X 1.25 X 20	-
18*	4	Screw-HXFL-M6 X 35	-
19*	6	Screw-RHCAR-M10 X 1.5 X 25	-
20*	6	Nut-M10 X 1.5	-
21*	2	Nut-M5 X 0.8	-
22*	4	Nut-HXFL-M12 X 1.75	-
	1	Winching Guide	9923644
	1	Instructions	9926743
		Internal Cam Service Kit (includes internal cam for freespool handle to connect winch to a replaceable handle, purchase handle separately)	2205497
		Service Handle (includes freespool handle and screw)	2205265

Items marked (*) are included in Hardware Kit PN – 2205119.

TOOLS REQUIRED

- Standard and Metric Socket Set (2X)
- Drill and Drill Bit Set
- Phillips Screwdriver
- 1 1/16" Hole Saw or Drill
- Torque Drivers

IMPORTANT

Your 3500 WINCH KIT is exclusively designed for your vehicle. Please read the installation instructions thoroughly before beginning. Installation is easier if the vehicle is clean and free of debris. For your safety, and to ensure a satisfactory installation, perform all installation steps correctly in the sequence shown.

ASSEMBLY TIME

Approximately 45 minutes

INSTALLATION INSTRUCTIONS

1. Place vehicle in "PARK". Turn key to "OFF" position and remove from vehicle. Remove front and rear seats. Disconnect cable (A) (black negative, red positive) from battery.

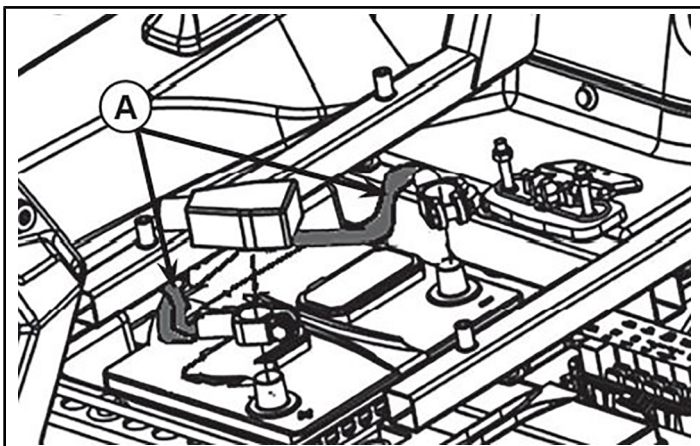

2. Remove the hood from the vehicle by twisting the two knobs (B) and pulling up.

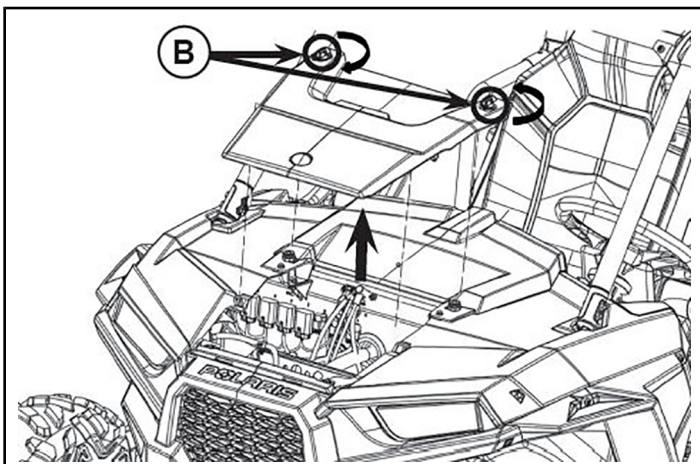

3. Remove the shift lever cap by using a flat screwdriver to remove the cap (C) of the shift handle (D). Remove the handle screw with a T25 Torx bit retaining it for reuse and pull up to remove the handle from the shift lever weldment.

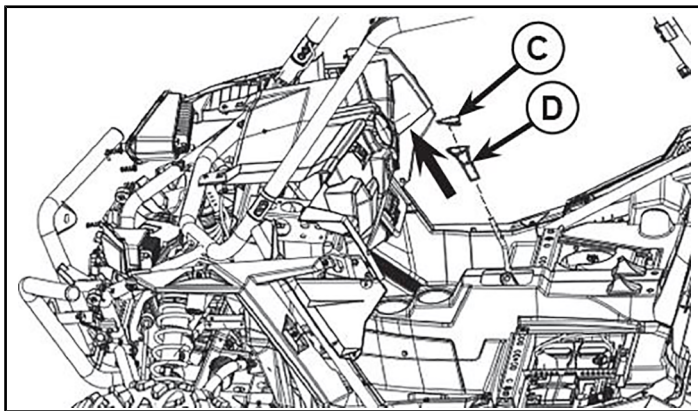

4. After removing shift lever cap and shift handle, take off the center console by removing the two screws (PN 7519650) (E) and the four tuff lock rivets (PN 7661855).

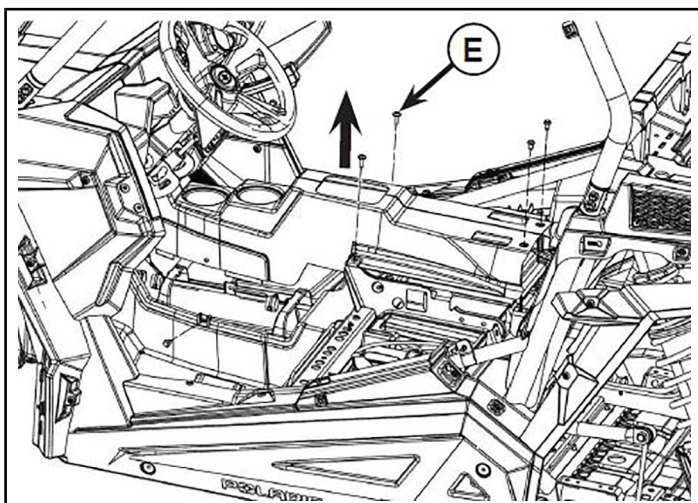

5. Route the cable (Not included with this kit see Page 1) having red (G) and black (F) wires from bus bar (H) to the battery. Clip the harness to specified locations.

NOTE

The red and black wires are supplied with the kit.

IMPORTANT

Do not connect the wire to the battery terminal at this step.

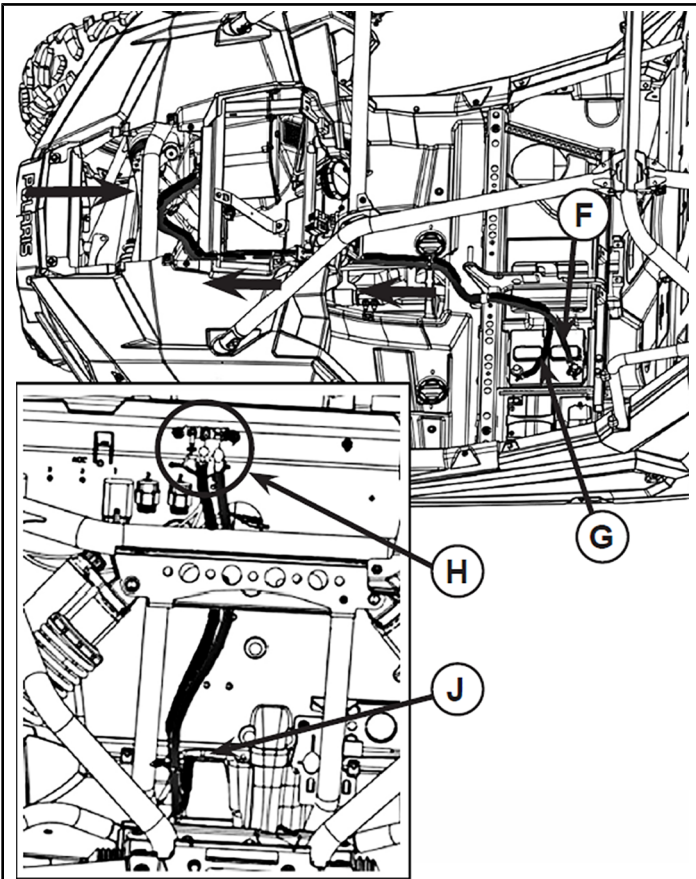

6. Detach the plastic plate by removing two screws (PN 7518980) (K).

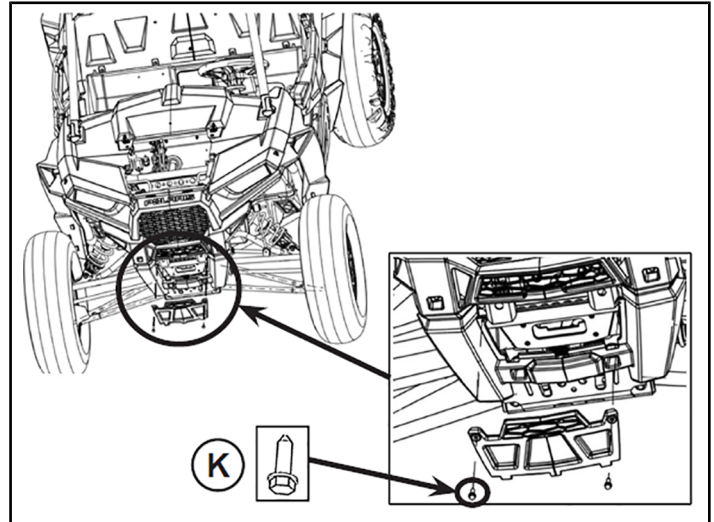

7. Take off the front fascia by removing six hexagonal screws (PN 7518529) (M) and four screws (PN 7519650) (L).

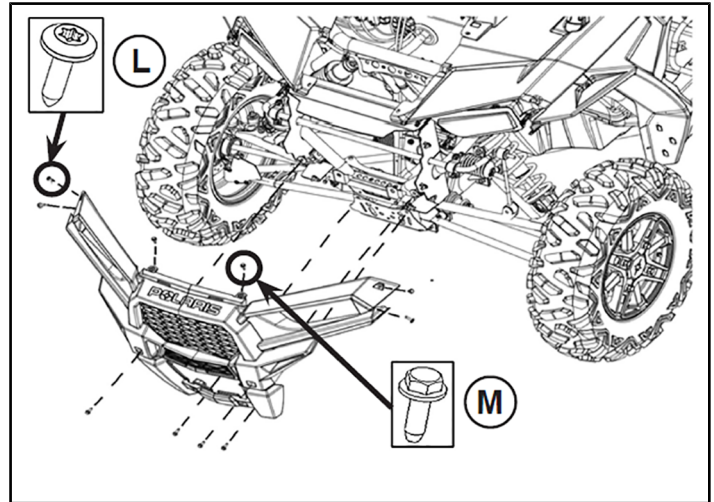

8. Mount the winch plate onto the vehicle with four screws ⑱ and lock nuts ⑳.

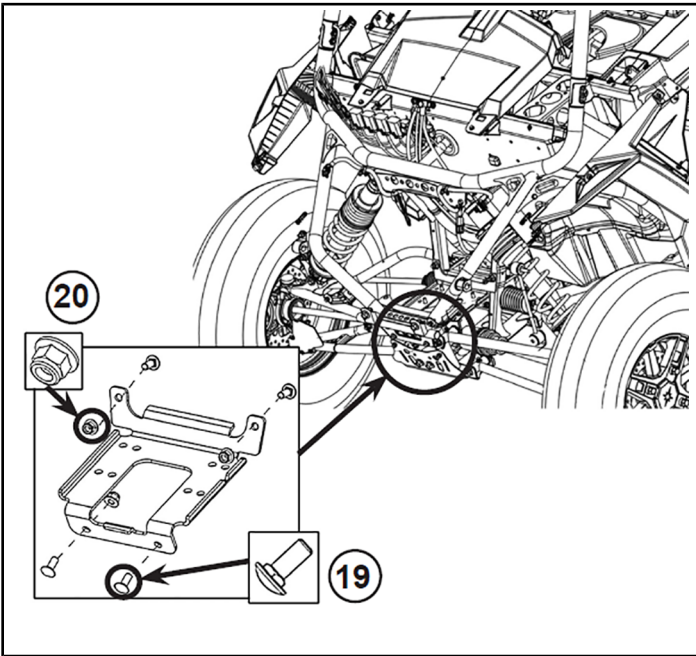

9. Connect the wires to the winch before installing it onto the vehicle.

NOTE

Connect blue wire ⑬ to the blue terminal and yellow wire ⑫ to the yellow terminal (color coding is already provided on winch).

10. Slide winch ① from left to right direction on the plate.

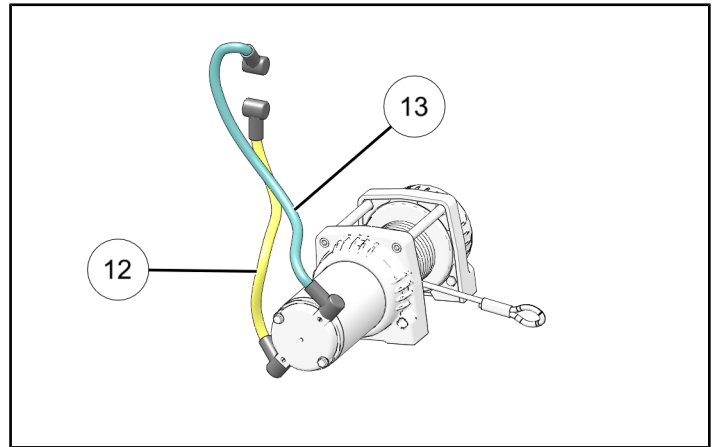
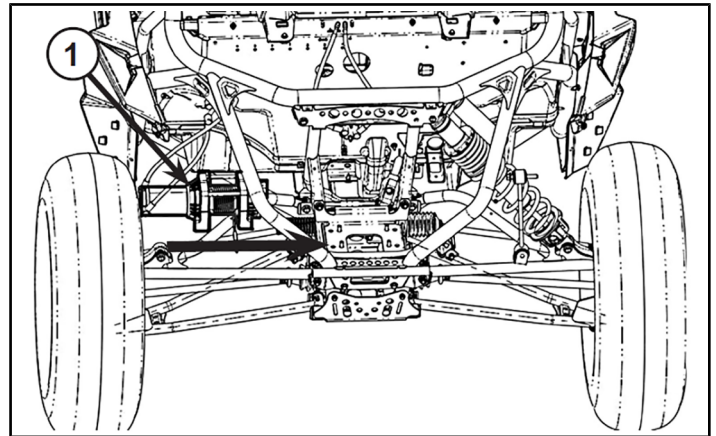

11. Mount and fix the winch ① onto the plate with four screws ⑰.

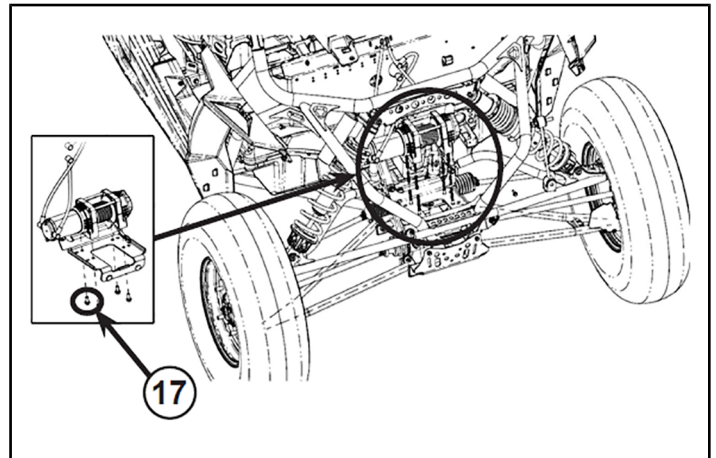

12. Lead mounting

Mount the roller fair lead (3) onto the front plate bracket (11) with two screws (19) and nuts (20).

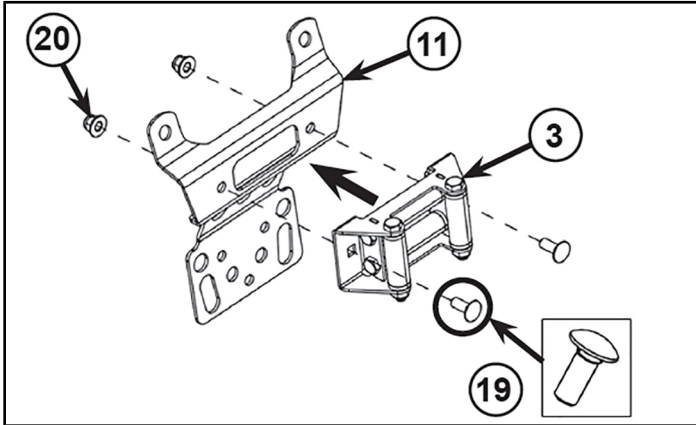

13. Front Plate Bracket installation

Install the front plate bracket with roller fair lead as subassembly on the vehicle with the four bolts (16) and nuts (22).

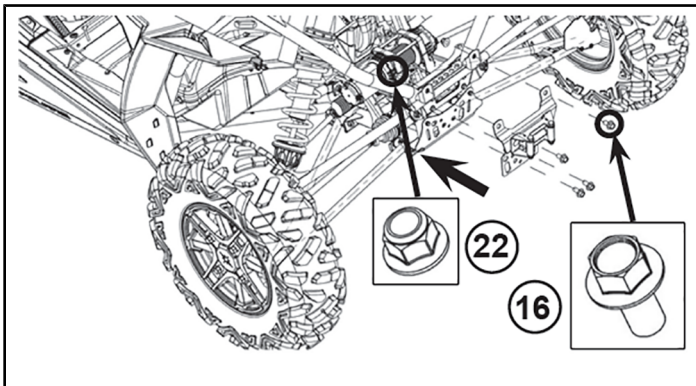

14. Cable installation

Twist the knob (N) on the winch and insert the cable through front plate bracket and roller fair lead to move the cable freely.

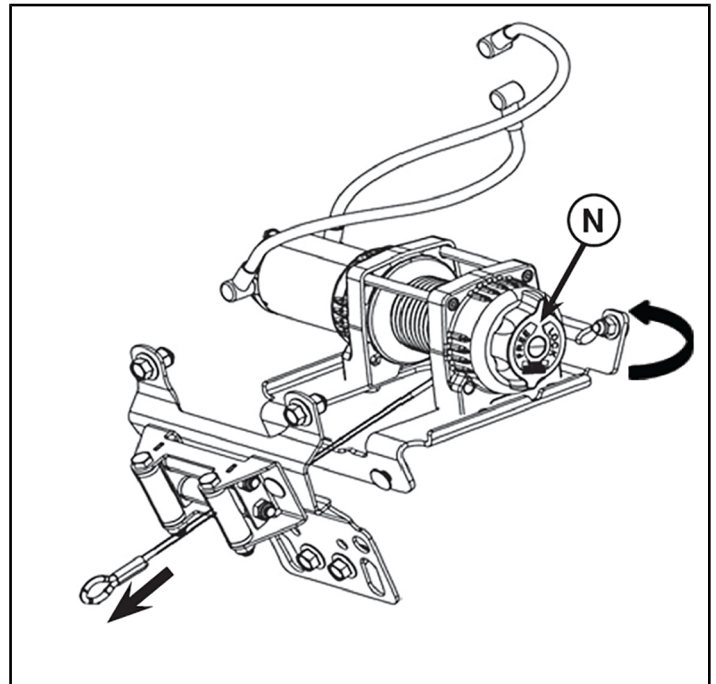

15. Hook attachment

Attach the hook (2) with the cable by inserting the clip through it.

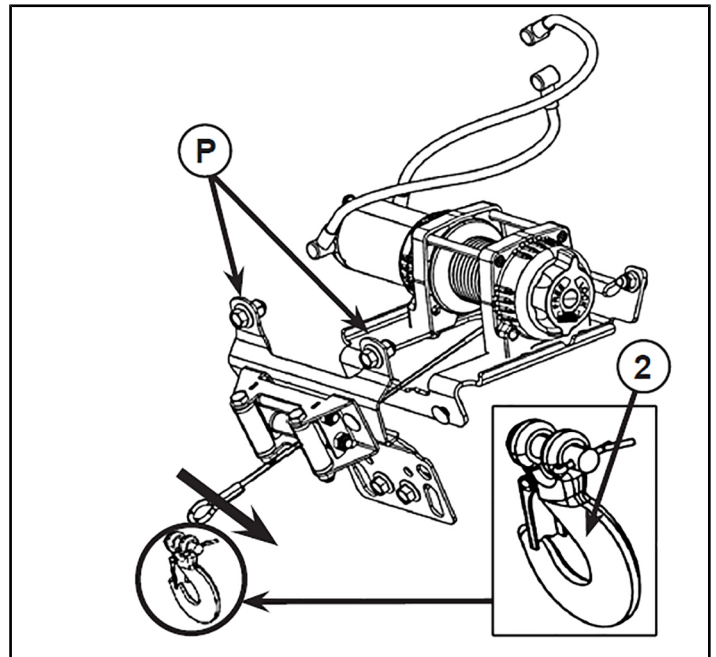

Ref	Description
P	Attachment Point to Vehicle

16. Mount the winch contactor on the firewall with the four bolts ⑱ at the specified drilled holes.

NOTE

Ensure that the yellow color code on the contactor is on top.

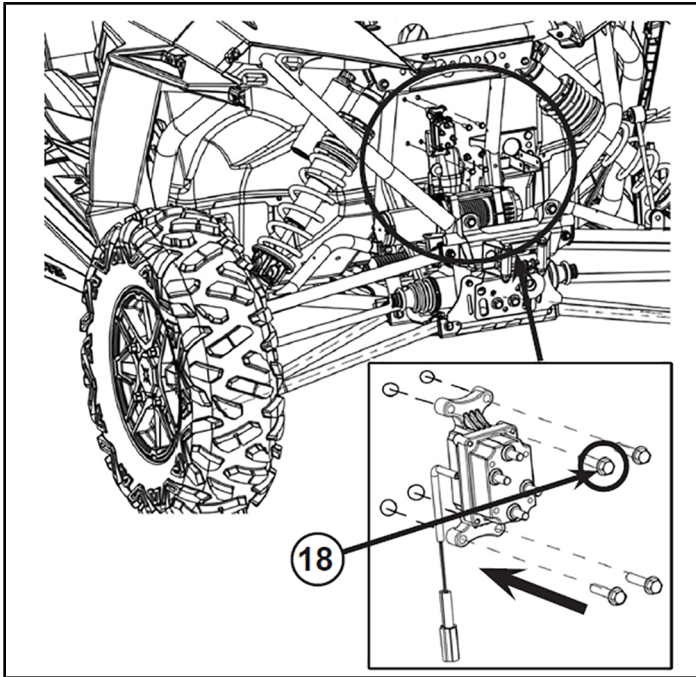

17. Connect the blue ⑬, yellow ⑫, red ⑧ and black ⑦ wires to the contactor terminals and put the caps.

NOTE

Color coding for terminals will be on contactor.

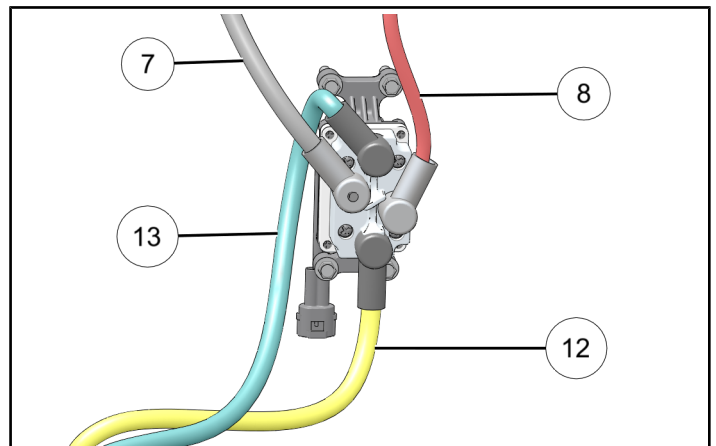
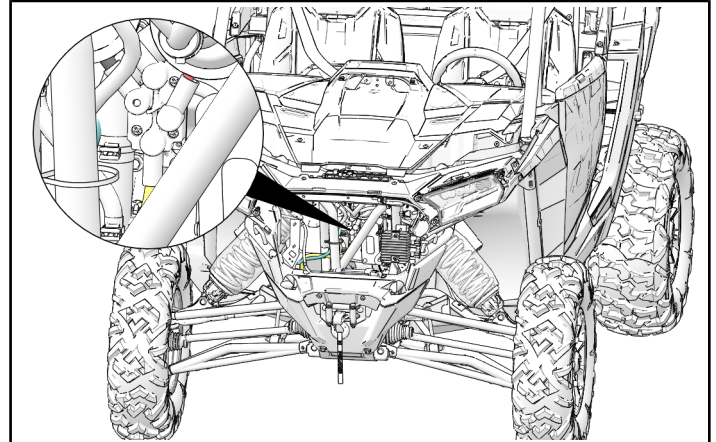

18. Hook up the negative (black) ⑦ and positive (red) ⑧ terminals to the bus bar.

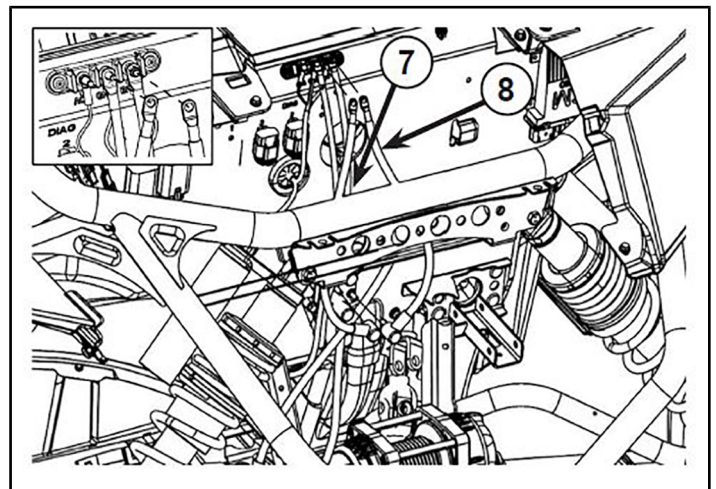

19. Feed the socket wires (Q) from inside of cab through the grommet in the firewall.

NOTE
Socket position may change as per requirement.

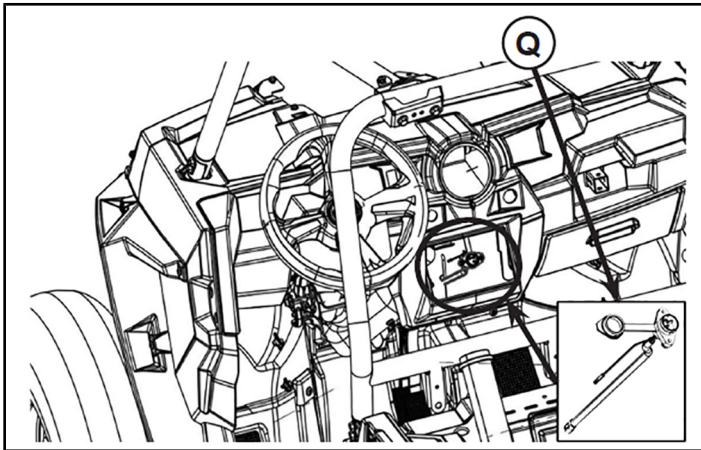

20. Plug in the socket wire connector to the contactor connector (5).

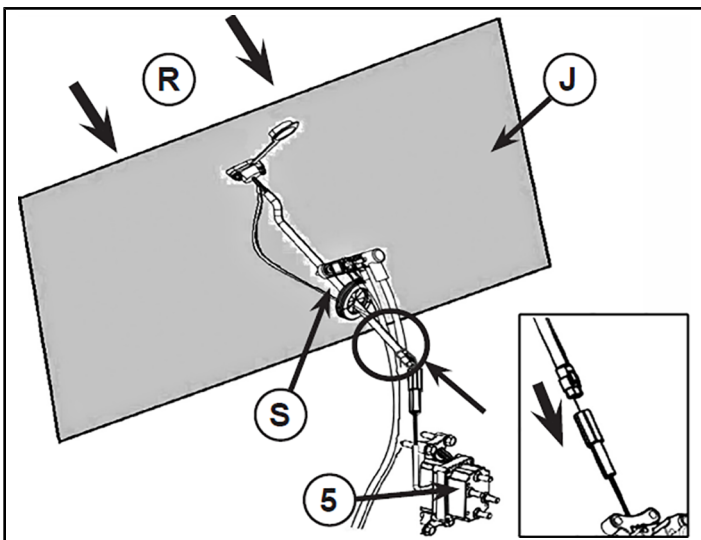

Ref	Description
R	Cabin
J	Firewall
S	Grommet

21. Connect the red (8) socket wire to the accessory bus bar (H).

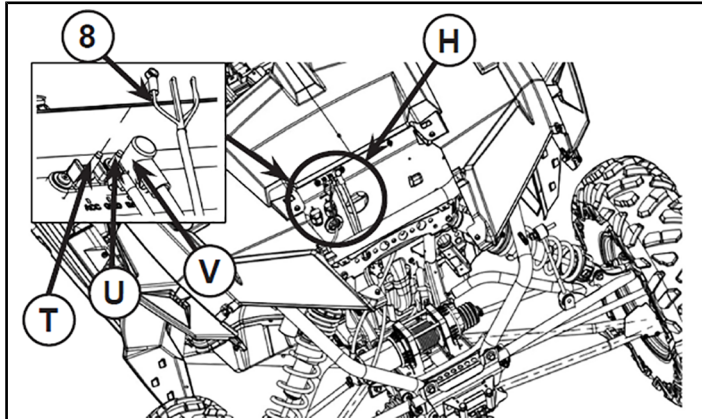

Ref	Description
V	Battery
U	GND
T	ACC

22. Cut out a hole in the din box for mounting the socket.

NOTE
Follow the instruction on the back of the din for the cutout.

NOTE
You may move the location of this hole (W) if necessary, just check their lengths before drilling holes.

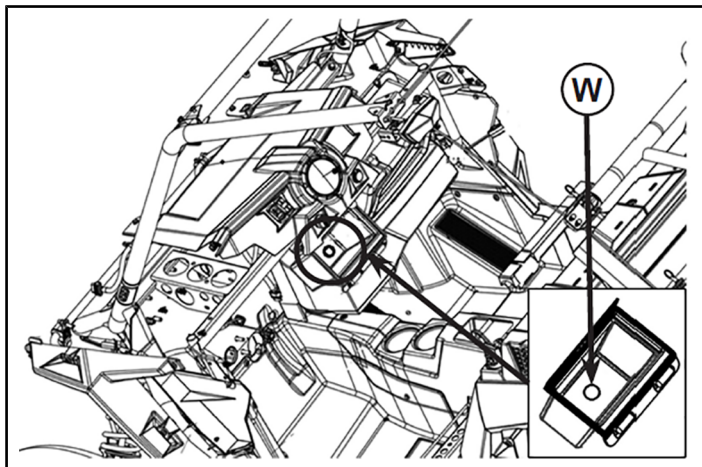

23. Drill the mounting holes to the specified location around the cut out of the socket on the back of din box.

NOTE
Use 1/4" drill bit.

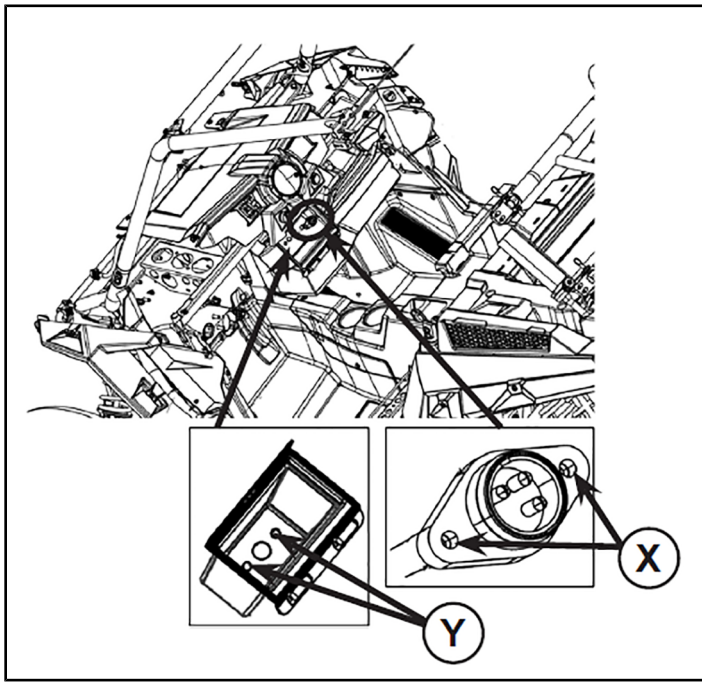

24. Attach socket ⑨ onto the din box (Z) with two bolts ⑮ and two nuts ⑰, at specified position.

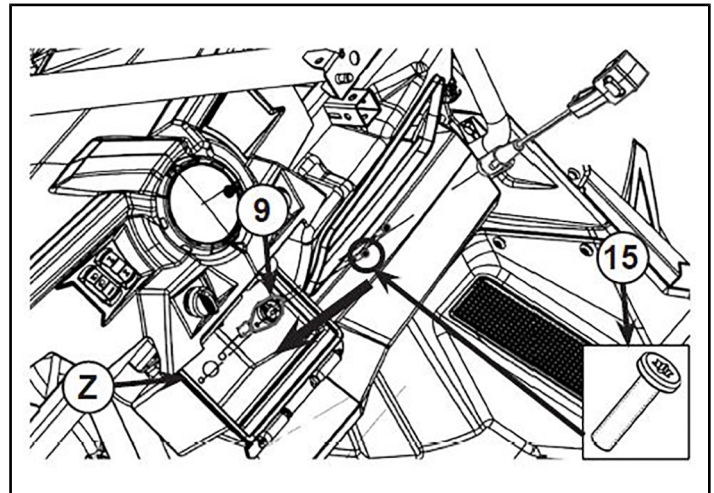

Ref	Description
X	Mounting hole in socket
Y	Hole in din box

25. Install the remote with the socket which is attached to the din box.
26. Connect the negative and positive cable to the battery which was disconnected in Step 1.
27. Attach the front fascia, center hood, center console, shift lever housing with cap and finally install the seat to its position which were disconnected in Steps 7, 2, 4, 3 and 1 respectively.