

PROSPECTOR TRACK MOUNT KIT

RZR S 900 / GENERAL / GENERAL 4

P/N 2880649

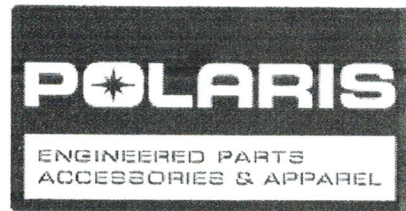

Application

MY15 AND NEWER RZR S 900 / GENERAL / GENERAL 4 MODELS

Before you begin, read these instructions and check to be sure all parts and tools are accounted for. Please retain these installation instructions for future reference and parts ordering information.

FRONT ANCHOR BRACKET:

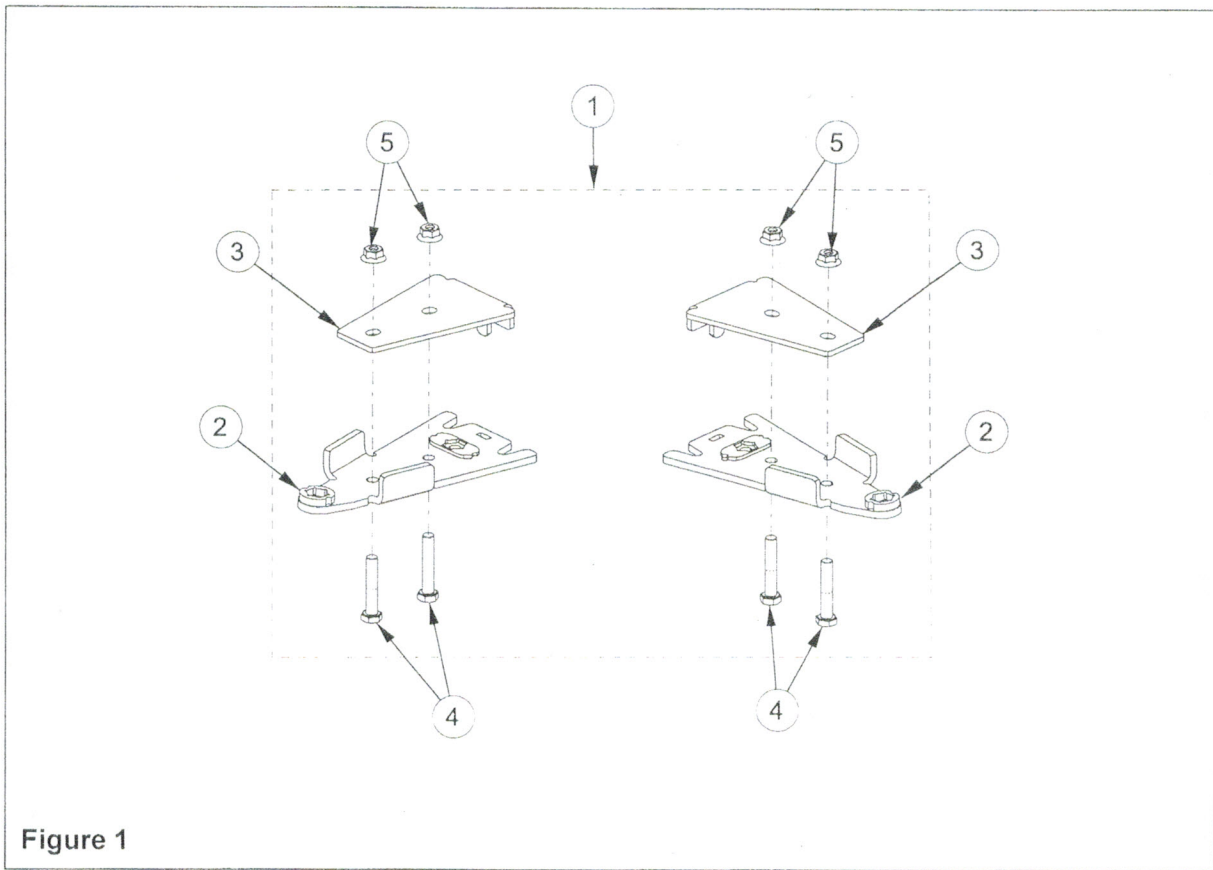
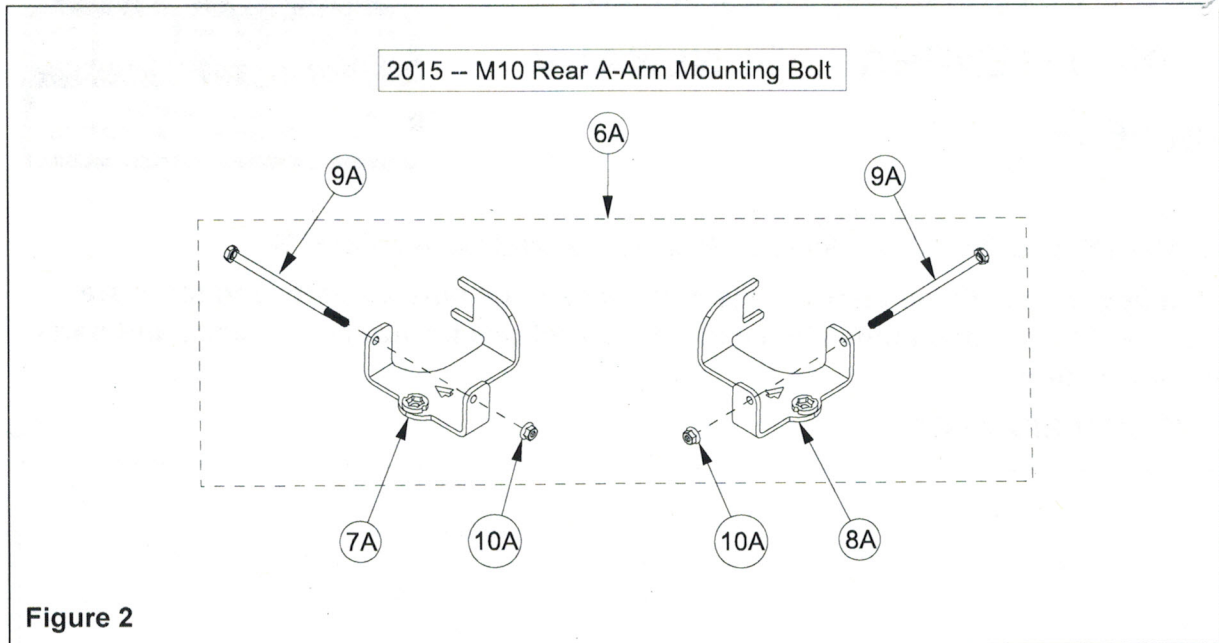

Figure 1

Kit Contents:

| <u>Ref</u> | <u>Qty</u> | <u>Part Description</u> | <u>Part Number</u> |
|------------|------------|--|--------------------|
| 1 | 1 | Front Bracket Kit | 2205703 |
| 2 | 2 | Anti Rotation Front Anchor Bracket | - |
| 3 | 2 | Front Bracket Cover | - |
| 4 | 4 | Hex Bolt-HCS, M10-1.5X55 , 8.8, ZP, DIN931 | - |
| 5 | 4 | Nylon Nut-FNN, M10-1.5, 8, ZP, DIN6926 | - |

REAR ANCHOR BRACKET:



Kit Contents:

| <u>Ref</u> | <u>Qty</u> | <u>Part Description</u> | <u>Part Number</u> |
|------------|------------|--|--------------------|
| 6A | 1 | Rear Bracket Kit | 2205706 |
| 7A | 1 | Rear Left Anchor Bracket | - |
| 8A | 1 | Rear Right Anchor Bracket | - |
| 9A | 2 | Hex Bolt-HCS, M10-1.5X180, 8.8, ZP, DIN931 | - |
| 10A | 2 | Nylon Nut-FNN, M10-1.5, 8, ZP, DIN6926 | - |

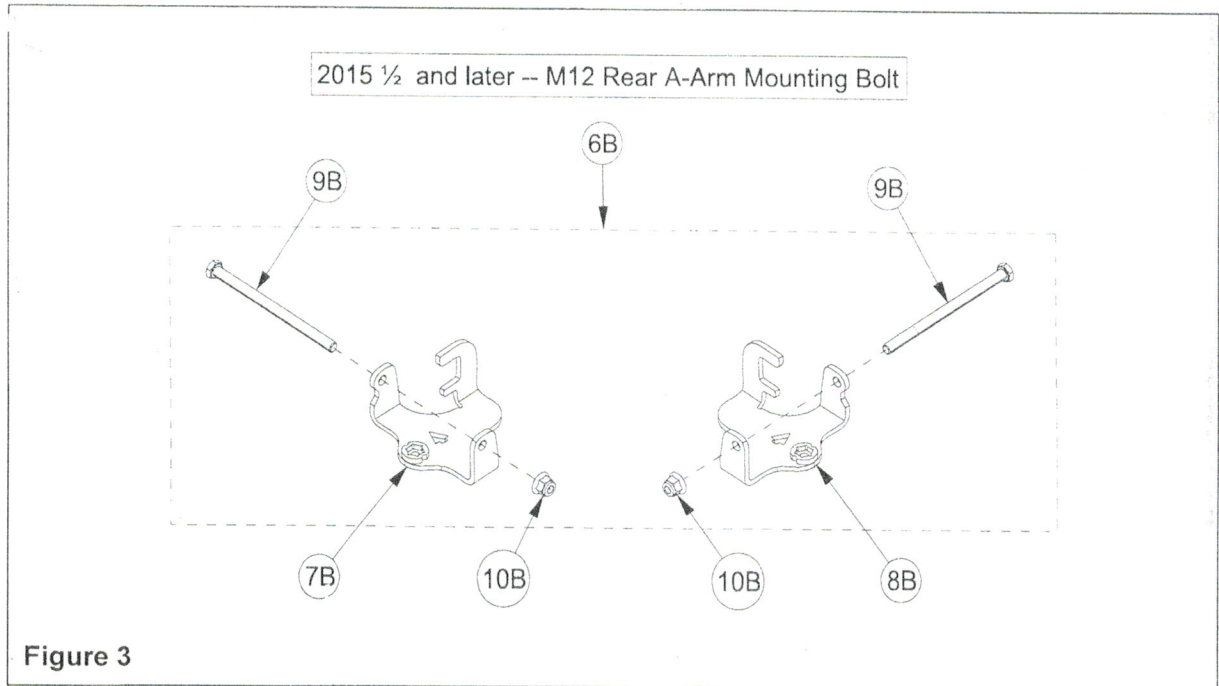

Kit Contents:

| <u>Ref</u> | <u>Qty</u> | <u>Part Description</u> | <u>Part Number</u> |
|------------|------------|---|--------------------|
| 6B | 1 | Rear Bracket Kit | TBA |
| 7B | 1 | Rear Left Anchor Bracket | - |
| 8B | 1 | Rear Right Anchor Bracket | - |
| 9B | 2 | Hex Bolt-HCS, M12-1.75X180, 8.8, ZP, DIN931 | - |
| 10B | 2 | Nylon Nut-FNN, M12-1.75, 8, ZP, DIN6926 | - |

STEERING LIMITER ASSEMBLY:

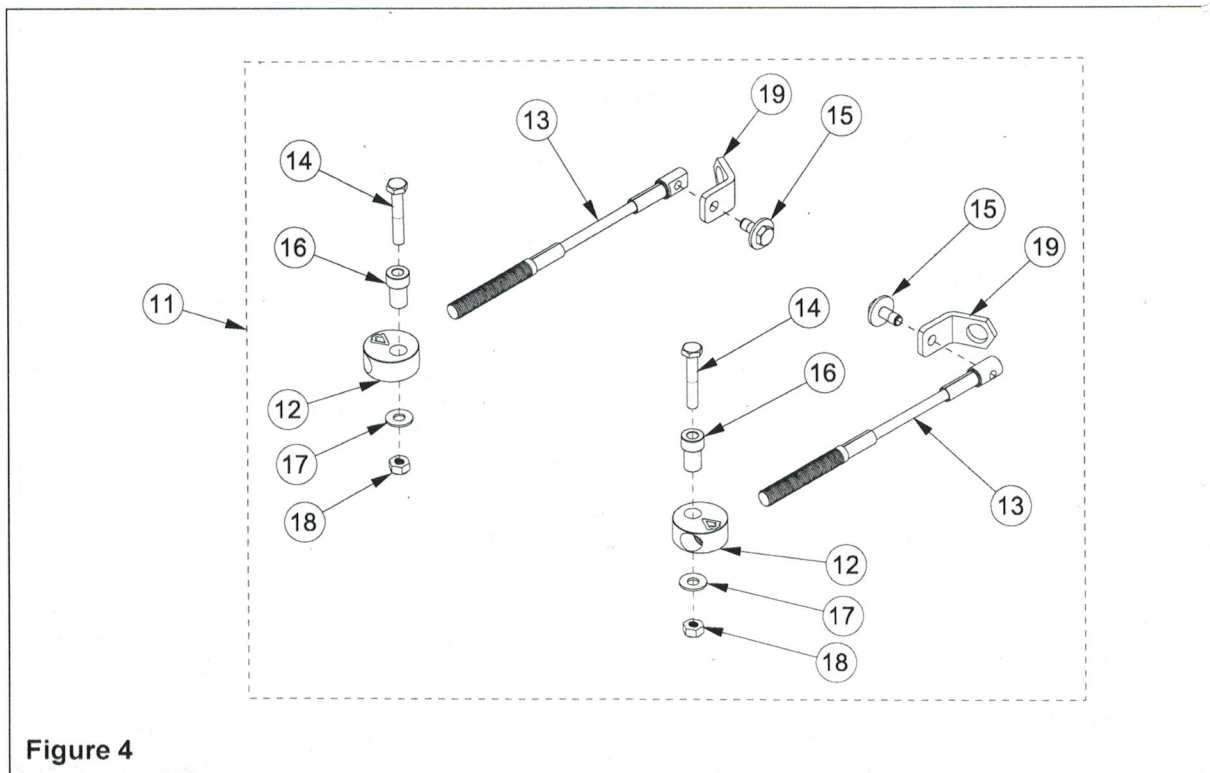

Figure 4

Kit Contents:

| <u>Ref</u> | <u>Qty</u> | <u>Part Description</u> | <u>Part Number</u> |
|------------|------------|---|--------------------|
| 11 | 1 | Steering Limiter Cable Assembly | 2205456 |
| 12 | 2 | Steering Limiter Mounting Disk | - |
| 13 | 2 | Steering Limiter Cable | - |
| 14 | 2 | Hex Bolt- HCS, M10-1.5X60, 8.8, ZP, DIN931 | - |
| 15 | 2 | Hex Bolt- HCSW, M10-1.5X25, 8.8, ZP, TL, DIN933 | - |
| 16 | 2 | Step Spacer | - |
| 17 | 2 | Washer-W, 7/16X1.0X0.072, 8, ZP, USS | - |
| 18 | 2 | Nylon Nut- NN, M10-1.5, ZP, 8, DIN982 | - |
| 19 | 2 | Support Plate | - |

WHEEL LUG NUT:

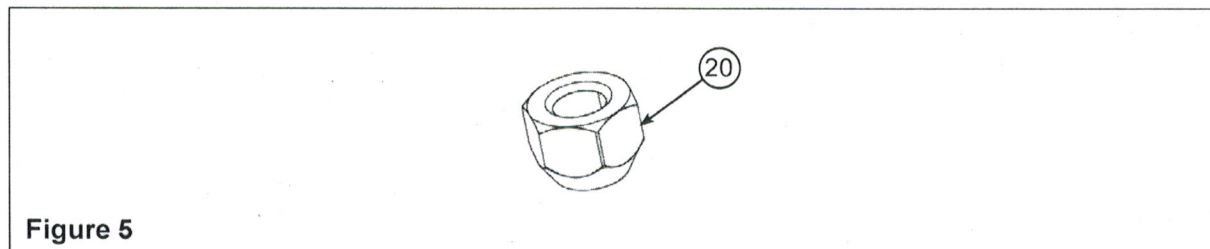

Figure 5

Kit Contents:

| <u>Ref</u> | <u>Qty</u> | <u>Part Description</u> | <u>Part Number</u> |
|------------|------------|-------------------------------------|--------------------|
| 20 | 16 | Wheel Lug Nut-LN, M12-1.5X14, 8, ZP | 2205458 |
| | 1 | Instructions | 9925547 |

BEFORE INSTALLING THE TRACK SYSTEMS, A BUSHING IN THE DRIVEN CLUTCH ASSEMBLY NEEDS TO BE REPLACED. PLEASE FOLLOW THE IMPORTANT PROCEDURE BELOW.

DRIVEN CLUTCH BUSHING REPLACEMENT PROCEDURE

1. Remove the left rear wheel.
2. Loosen the hose clamp attaching PVT intake hose to the outer clutch cover and disengage the hose from the outer clutch cover.
3. Remove the eight clutch cover screws (R) and remove the outer clutch cover from the vehicle. Figure 6.

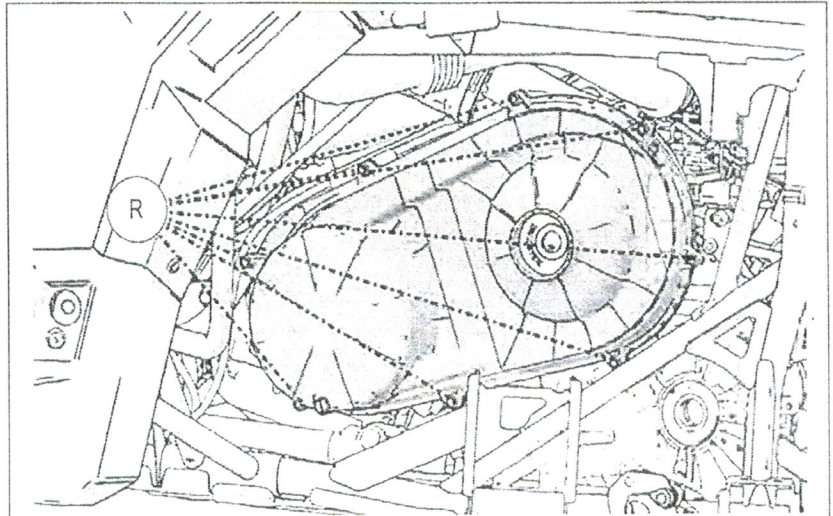

Figure 6

4. Maneuver the outer clutch cover outward as shown below to access the drive belt.
5. Mark the drive belt direction of rotation so that it can be installed in the same direction. Figure 7.

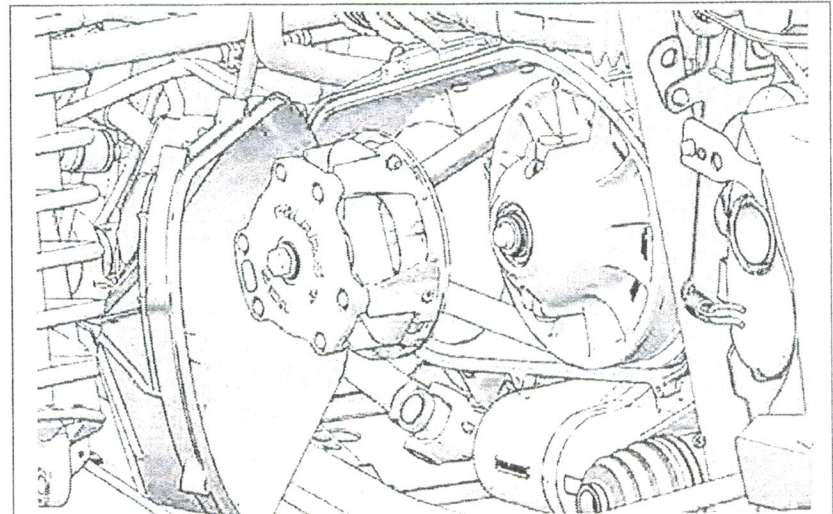

Figure 7

6. Insert clutch spreader tool (2878925) (S) into the driven clutch as shown (tool included with vehicle's tool kit).

NOTE: Make sure the tool is square with the moveable sheave surface of the driven clutch.

7. Rotate tool towards the clutch to open the sheaves.
8. Walk the belt out of the driven clutch and drive clutch. Remove the belt from the vehicle. Figure 8.

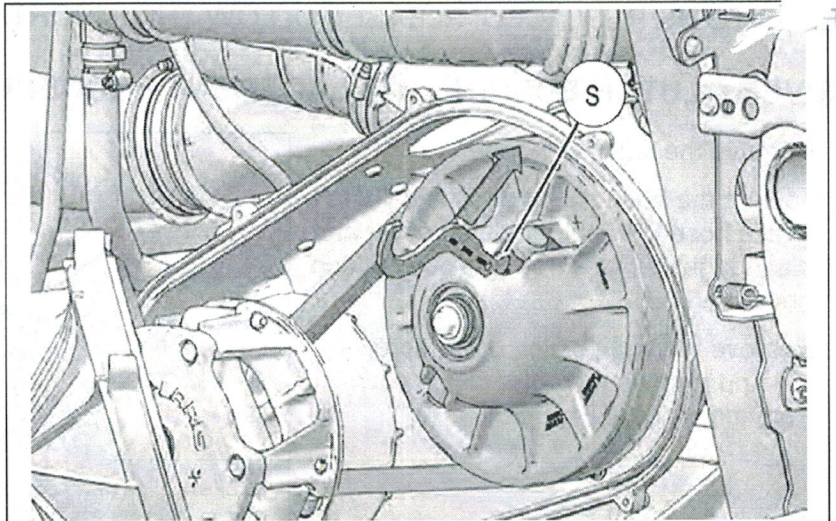

Figure 8

9. Remove the driven clutch retaining bolt (T) and washer (U) from driven clutch. Figure 9.

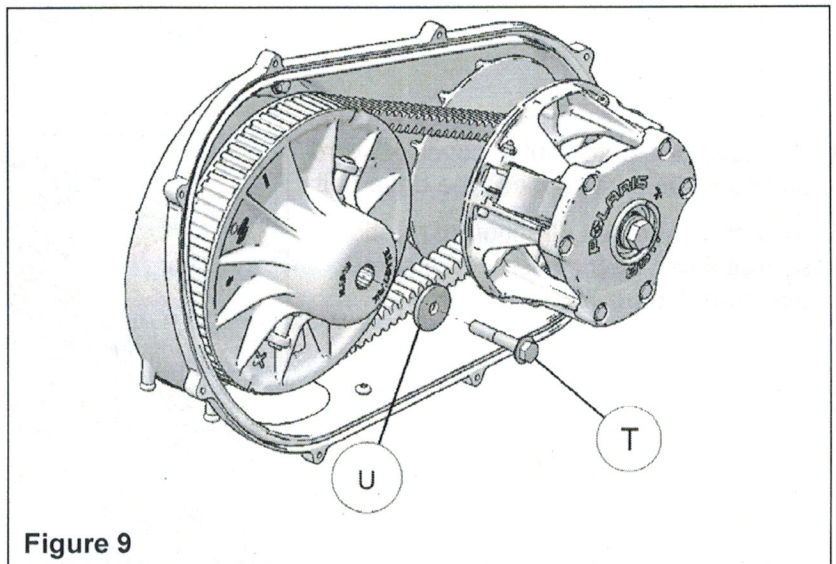

Figure 9

10. Remove shoulder sleeve (V) from driven clutch assembly as shown below. Figure 10.

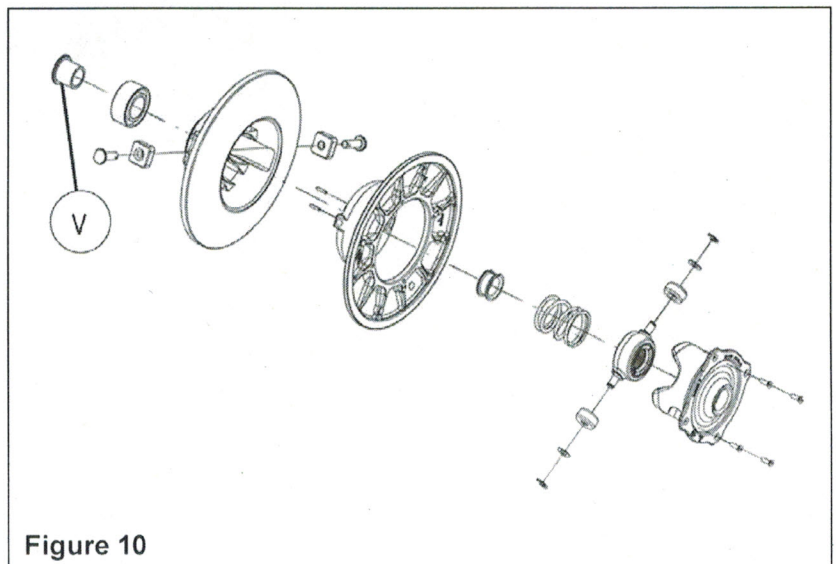
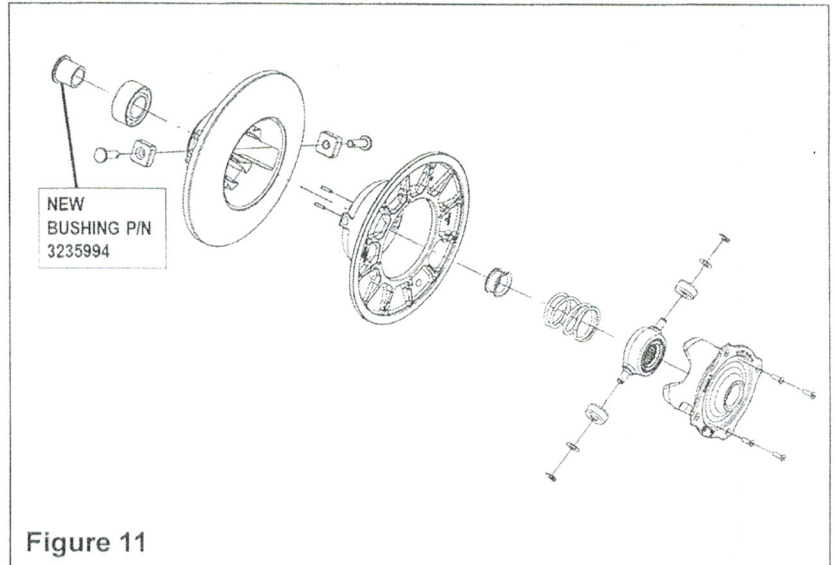
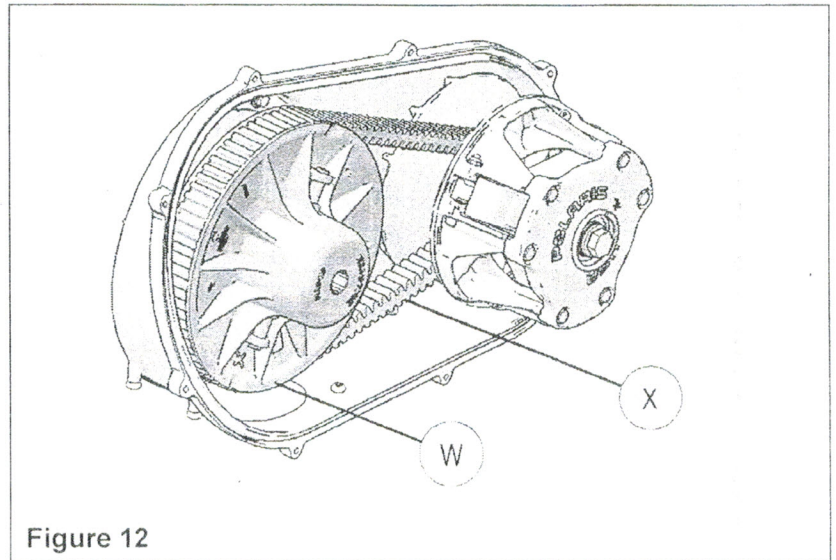

Figure 10

11. Replace with new bushing (P/N 3235994).
Ensure that clutch bushing is fully seated. Figure 11.



12. Install driven clutch assembly (W) and belt (X). Figure 12.



13. Re-Install driven clutch bolt (T) and Belleville washer (U). Belleville washer must be concave inward. Figure 13.

14. Torque driven clutch bolt to the specification below.

TORQUE: 65 ft. lbs. (47.9 Nm)

15. Re-install clutch cover by using eight screws (R).

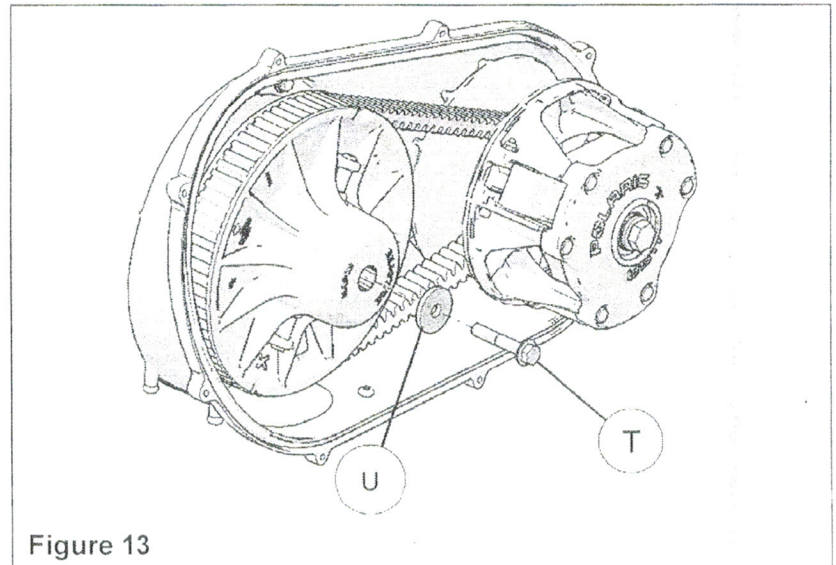

IMPORTANT: Please read carefully each part of this document as well as the User Manual prior to assembling, installing and using the track systems.

INSTALLATION INSTRUCTIONS:

CAUTION: Before beginning the installation, make sure you received all the components included in the parts lists of the preceding pages.

1. For installation purposes, directional arrows have been cut out of the main components in the anchor bracket kits. These arrows indicate the front of the vehicle relative to the component. Figure 14.

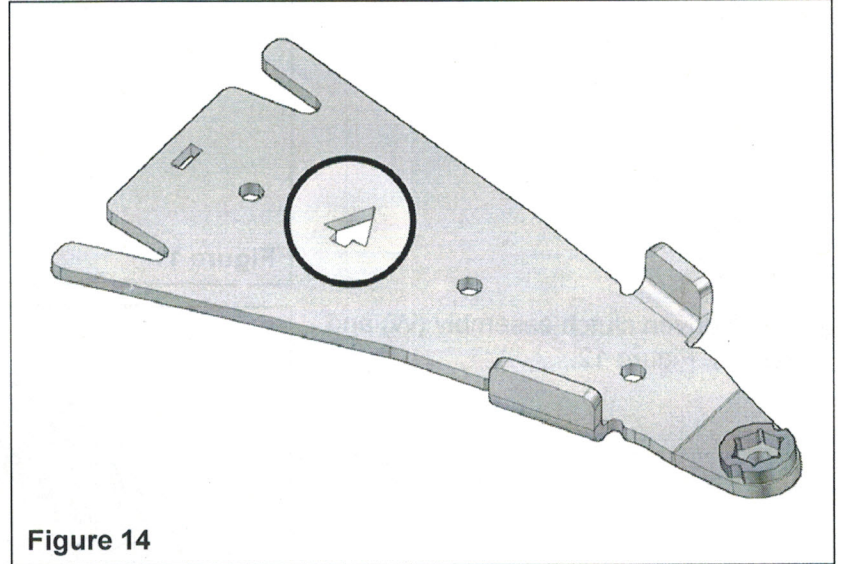

Figure 14

PREPARATION:

WARNING: Do not place any part of your body under the vehicle unless it is securely placed on appropriate stands. Severe injuries could occur if the vehicle collapses or moves. Do not use a lifting device as a secure stand.

1. Position the vehicle on a flat and level surface (or on a suitable lifting device), shift the transmission to neutral and turn off engine.
2. Identify and position each unit of the track system near the position indicated on the sticker affixed on the frame. Figure 15.

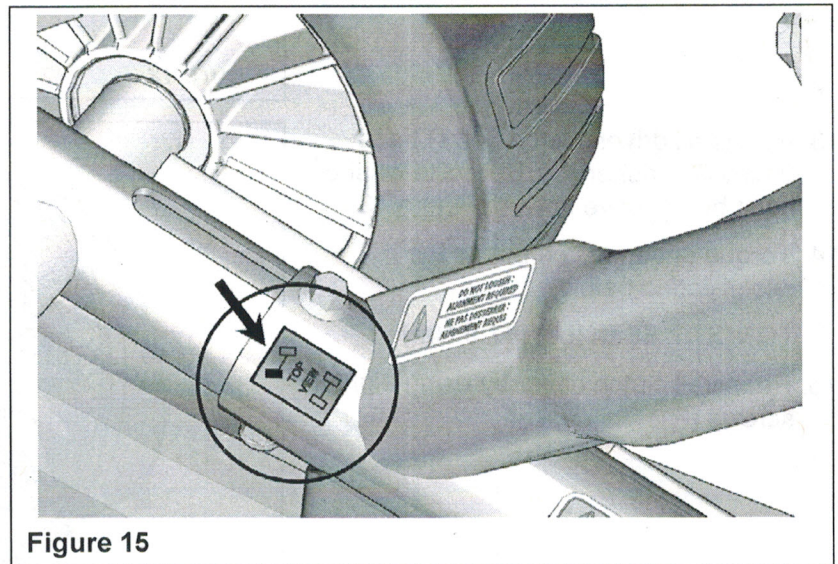

Figure 15