

DOOR KIT



P/N 2879962, 2880636, 2882247

APPLICATION

Verify accessory fitment at Polaris.com.

BEFORE YOU BEGIN

Read these instructions and check to be sure all parts and tools are accounted for. Please retain these installation instructions for future reference and parts ordering information.

KIT CONTENTS

Kit PN 2882247 LH side shown; RH side opposite.

Kit PNs 2879962 and 2880636 similar except as noted below.

This Kit includes:

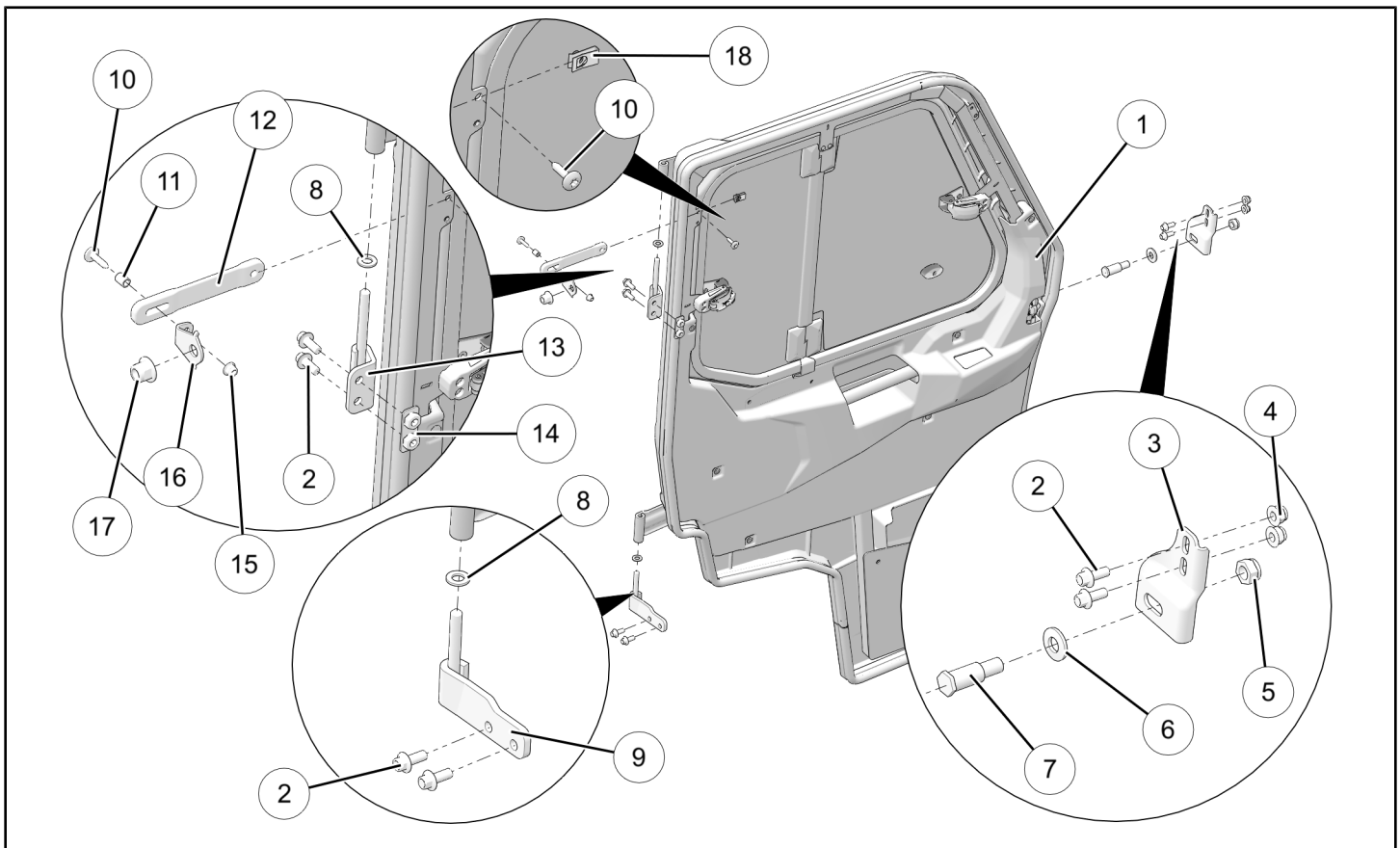

Kit PN 2882247 Only:

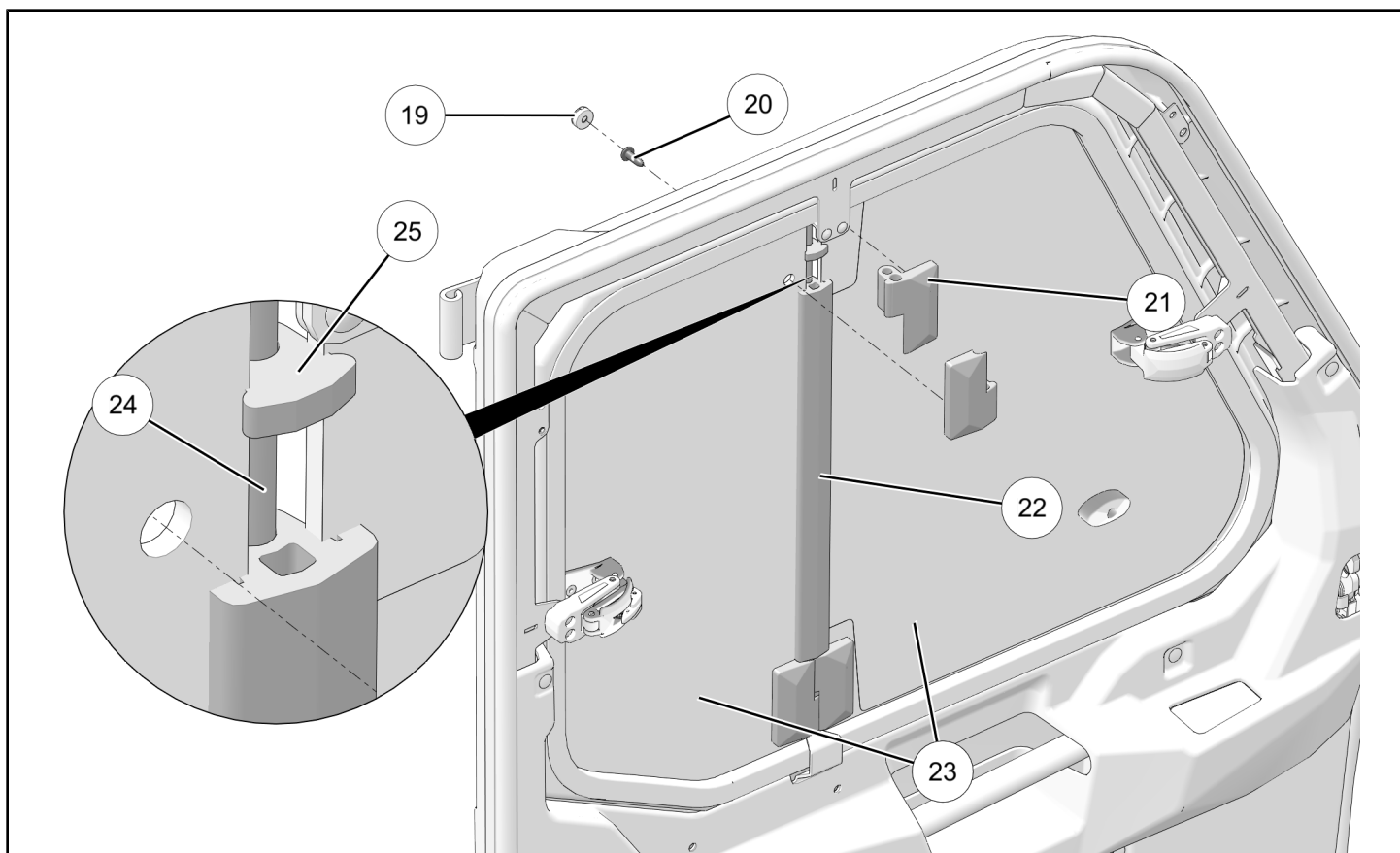

REF	QTY	PART DESCRIPTION	PART NUMBER	FOR DOOR KIT PN 2879962 AND 2880636 USE HARDWARE KIT PN:	FOR DOOR KIT PN 2882247 USE HARDWARE KIT PN:
1	1	Door Assembly, LH (Black, Hinged Window - Kit PN 2882247 only)	2636373	-	-
	1	Door Assembly, RH (Black, Hinged Window - Kit PN 2882247 only) (not shown)	2636374	-	-
	1	Door Assembly, LH (Poly, Sliding Window - Kit PN 2879962 only) (not shown)	2635378	-	-
	1	Door Assembly, RH (Poly, Sliding Window - Kit PN 2879962 only) (not shown)	2635379	-	-
	1	Door Assembly, LH (Camo, Sliding Window - Kit PN 2880636 only) (not shown)	2635660	-	-
	1	Door Assembly, RH (Camo, Sliding Window - Kit PN 2880636 only) (not shown)	2635661	-	-
2	12	Screw, Hex Flange - M8 X 1.25 X 20	7517838*	2205676	2207047
3	1	Door Bracket, Striker, LH	5258793*	2205676	2207047
	1	Door Bracket, Striker, RH (not shown)	5258794*	2205676	2207047
4	4	Nut, Hex Flange - M8 X 1.25	7547454*	2205676	2207047
5	2	Nut, Hex, Locking - M12 X 1.75	7540000*	2205676	2207047
6	2	Washer (Kit PN 2882247 only)	-	-	2207047

REF	QTY	PART DESCRIPTION	PART NUMBER	FOR DOOR KIT PN 2879962 AND 2880636 USE HARDWARE KIT PN:	FOR DOOR KIT PN 2882247 USE HARDWARE KIT PN:
7	2	Pin, Striker	7519358*	2205676	2207047
8	4	Washer - 10.25 X 19.00 X 2.0	5439712*	2205676	2207047
9	1 1	Hinge, Vehicle Side, Lower, LH Hinge, Vehicle Side, Lower, RH (not shown)	1020368* 1020369*	2205676 2205676	2207047 2207047
10	4	Screw, Torx® Truss Head - M6 X 1.0 X 25	7519650*	2205676	2207047
11	2	Spacer, M6	5139193*	2205676	2207047
12	2	Strap, Door Limiter	7081993*	2205654	-
13	1 1	Hinge, Vehicle Side, Upper, LH Hinge, Vehicle Side, Upper, RH (not shown)	1019785* 1019786*	2205676 2205676	2207047 2207047
14	2	Hinge Plate	5256140*	2205676	2207047
15	2	Nut, Hex Flange - M6 X 1.0	7547453*	2205676	2207047
16	2	Bracket, Door Limiter	5259649*	2205676	2207047
17	2	Nut, Hex Flange - M12 X 1.75	7547441*	2205676	2207047
18	2	Nut, Clip	-	-	-
19	4	Cap (Kit PN 2882247 only)	-	-	2207046
20	4	Screw, Torx® Truss Head, High/Low - #14 X 3/4 (Kit PN 2882247 only)	-	-	2207046
21	4	Hinge (Kit PN 2882247 only)	-	-	2207046
22	1	Seal, Center (Kit PN 2882247 only)	-	-	2207046
23	1 1	Glass, LH, Front and Rear (Kit PN 2882247 only) Glass, RH, Front and Rear (not shown) (Kit PN 2882247 only)	- -	- -	2207048 2207049
24	1	Pin, Hinge (Kit PN 2882247 only)	-	-	2207046
25	2	Seal, Hinge (Kit PN 2882247 only)	-	-	2207046
26	1	Cab Seal Kit (Kit PN 2879962 and 2880636 only) (not shown)	2880508	-	-
	1	Instructions	9926150	-	-

PNs marked (*) ONLY applicable to Kit PN 2879962 and 2880636.

TOOLS REQUIRED

- Safety Glasses
- Screwdriver Set, Torx®
- Socket Set, Metric
- Socket Set, Torx® Bit
- Torque Wrench
- Wrench Set, Metric

CONSUMABLES REQUIRED

- Grease, Polaris All Season (or equivalent)

ASSEMBLY TIME

Approximately 60 minutes

IMPORTANT

Your DOOR KIT is exclusively designed for your vehicle. Please read the installation instructions thoroughly before beginning. Installation is easier if the vehicle is clean and free of debris. For your safety, and to ensure a satisfactory installation, perform all installation steps correctly in the sequence shown.

INSTALLATION INSTRUCTIONS

NOTE

LH side shown; RH side opposite.

1. Shift vehicle transmission into "PARK". Turn key to "OFF" position and remove from vehicle.
2. Raise vehicle bed.
3. Install upper hinge ⑬ to ROPS using two screws ② and nut plate ⑭. Do not fully tighten screws.

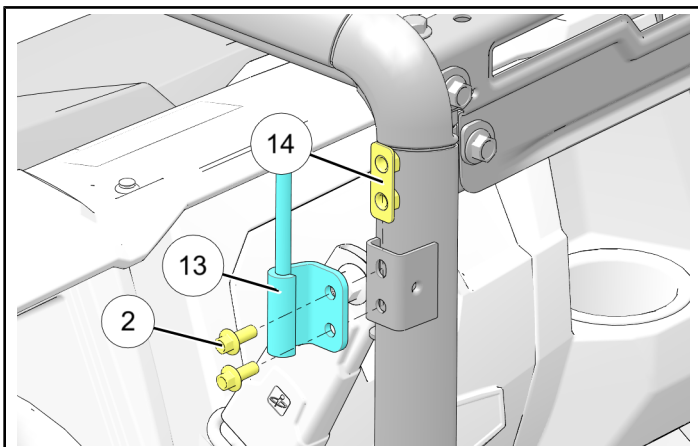

4. Install lower hinge ⑨ using two screws ② as shown. Torque to specification.

TORQUE

16 ft. lbs. (22 Nm)

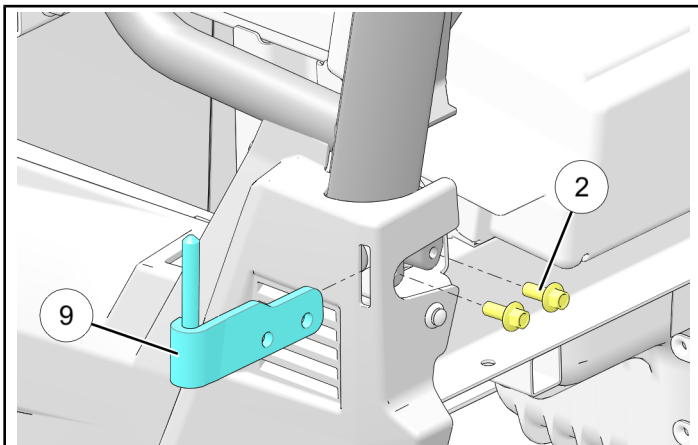

5. Install limiter strap and bracket.

- a. If not already pre-installed by factory, install nut clip ⑱ to upper rear corner of door frame, then install limiter strap ⑫ to frame using screw ⑩.

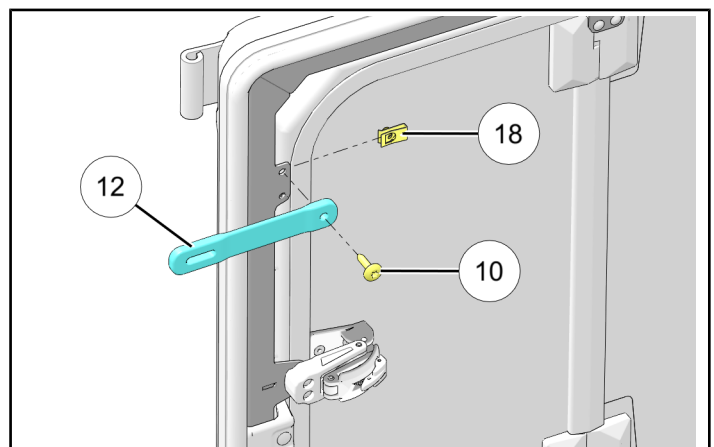

- b. Remove and discard existing nut ① from upper seat belt attach bolt. Nut will not be reused.

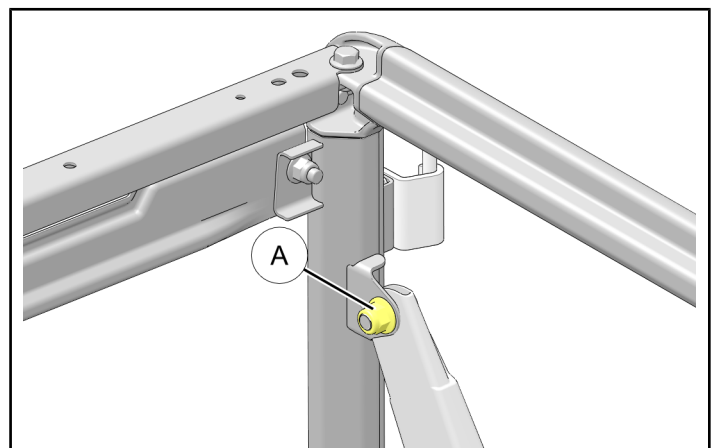

⚠ WARNING

Failure to torque seat belt fastener as directed will adversely affect restraint system integrity and may lead to severe injury or death in an accident.

- c. Install screw ⑩, spacer ⑪, and nut ⑮ to door limiter bracket ⑯. Then install limiter bracket assembly to seat belt attach bolt using NEW nut ⑰. Torque seat belt nut to specification.

TORQUE

40 ft. lbs. (54 Nm)

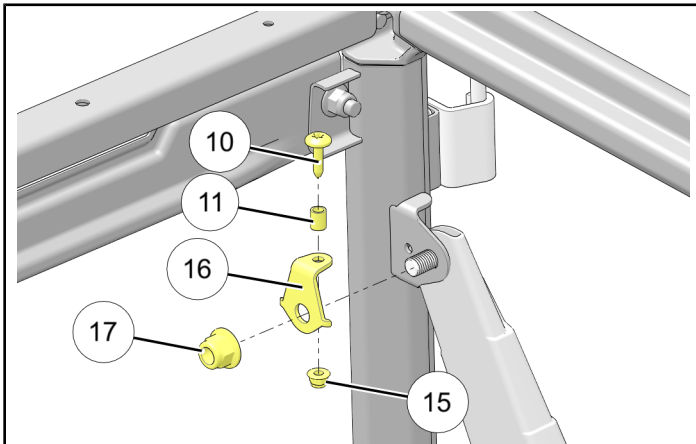

6. Install nylon washer ⑧ to upper and lower hinge pins ⑬ and ⑨.

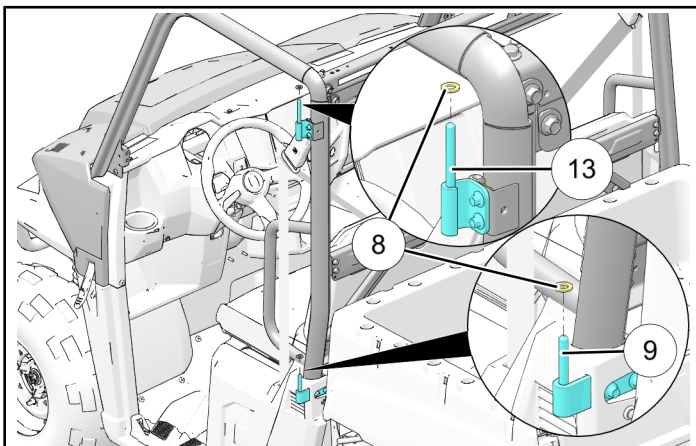

7. Install door.

⚠ WARNING

Follow all chemical manufacturer instructions and safety precautions. Failure to follow all manufacturer instructions and precautions may result in severe injury or death.

- a. Grease hinge pins using Polaris All Season Grease (or equivalent).

- b. Install door ① on upper hinge ⑬ first, then lower hinge ⑨.

NOTE

Upper hinge pin is longer than lower hinge pin to assist in door installation.

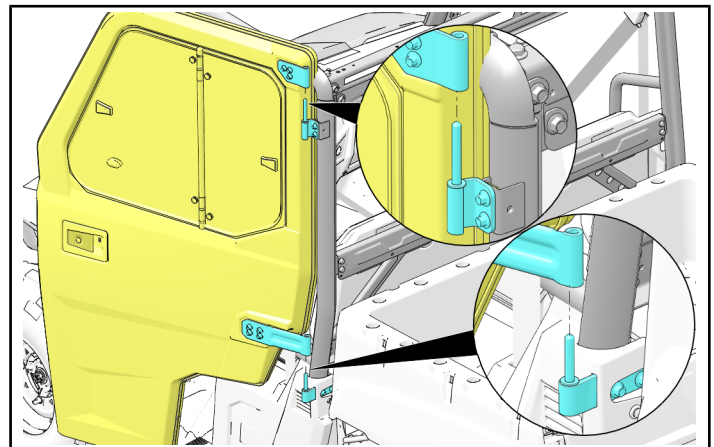

- c. Close and center door in ROPS by pushing door inward and upward.

If door alignment is satisfactory: Proceed to Step 8.

If door alignment is NOT satisfactory:

- i. Loosen DOOR SIDE upper and lower hinge screws as shown below, and VEHICLE SIDE upper hinge screws installed in Step 3. If applicable, open window for access.

NOTE

Door frame and/or door side hinges are slotted to permit adjustment.

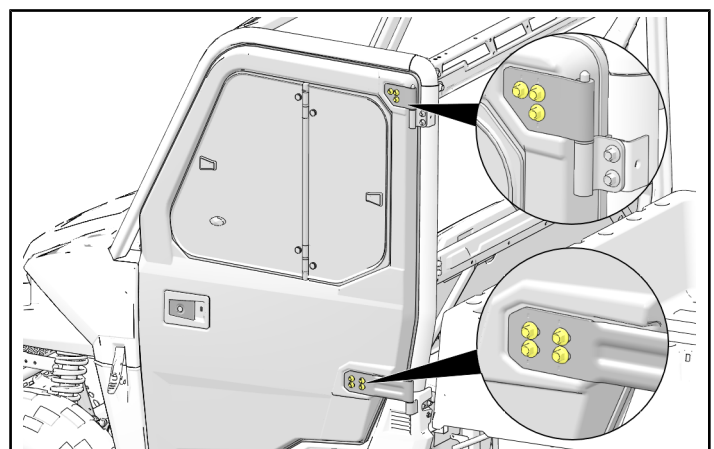

- ii. While holding door closed and centered in ROPS, tighten ALL hinge screws. Torque DOOR SIDE upper and lower hinge screws to specification.

TORQUE

DOOR SIDE hinge screws: 16 ft. lbs. (22 Nm)

NOTE

VEHICLE SIDE upper hinge screws will be torqued to specification in Step 9.

8. Install striker bracket and pin.

- a. Loosely install striker bracket ③ to lower A-pillar fitting using two each screws ② and nuts ④.

NOTE

Bracket has slots to permit adjustment.

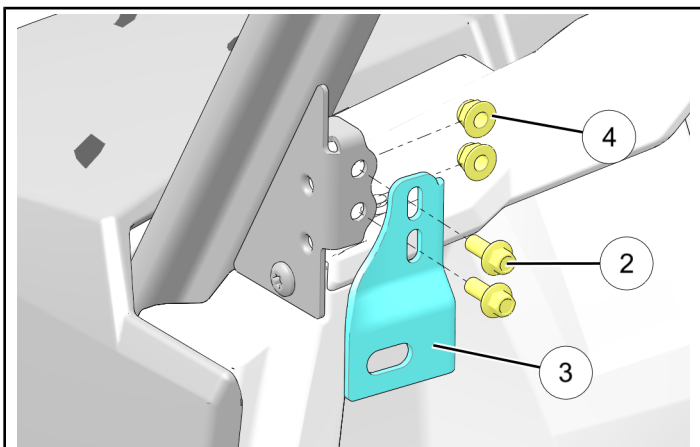

- b. Loosely install striker pin ⑦ and flat washer ⑥ to striker bracket ③ using nut ⑤. Position pin in middle of adjustment slot.

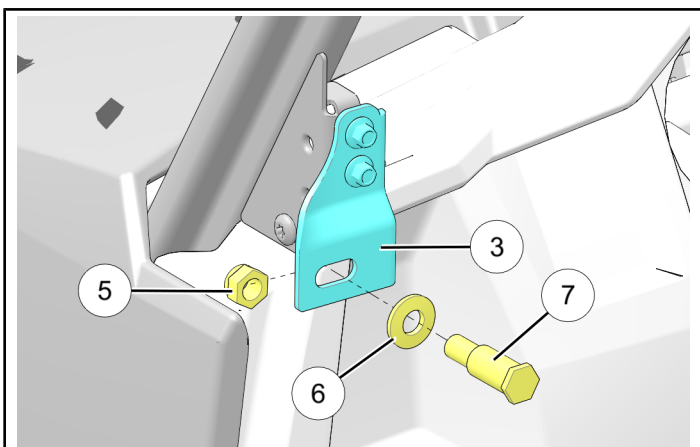

- c. Open latch on door (to properly position pawl), then slowly close door and observe engagement of striker pin ⑥ into door latch.

Adjust striker pin to achieve the following:

- i. HEIGHT ⑧: Pin shank should clear lower latch pawl and contact upper latch pawl. To adjust, loosen screws ②, move bracket ③ up or down as required, then re-tighten screws.
- ii. DEPTH ⑨: As required to achieve desired seal compression. To adjust, loosen nut ⑤, move striker pin inboard or outboard as required, then re-tighten nut.

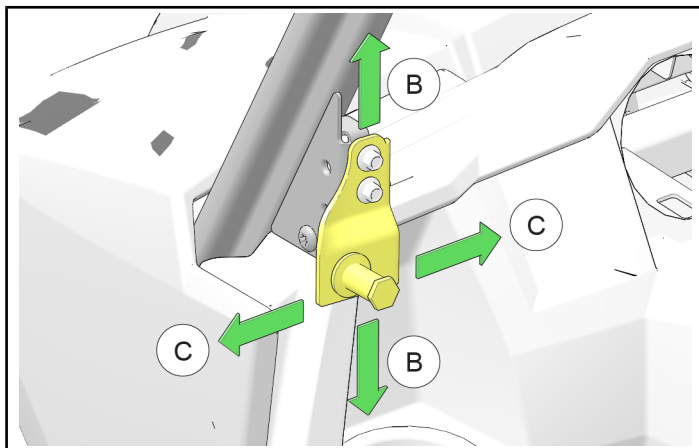

- d. Torque fasteners to specification.

TORQUE

Screws ②: 16 ft. lbs. (22 Nm)
Nut ⑤: 30 ft. lbs. (41 Nm)

9. With door closed and latched, loosen two screws ② securing VEHICLE SIDE upper hinge ⑬ (see Step 3), push hinge slightly upward to remove any gap between vehicle side hinge and door side hinge, then retighten screws. Torque to specification.

TORQUE

16 ft. lbs. (22 Nm)

NOTE

Removing gap assists in smooth door operation.

10. Secure limiter strap ⑫ to limiter bracket assembly ⑮. See Step 5.
11. Repeat Steps 3–10 for RH door.
12. Kit PNs 2879962 and 2880636 Only: Install Cab Seal Kit ⑳ per instructions included in that kit.
13. Lower vehicle bed.