

## LIGHT HARNESS KIT



**P/N 2879859**

## APPLICATION

Verify accessory fitment at [Polaris.com](https://www.polaris.com).

## BEFORE YOU BEGIN

Read these instructions and check to be sure all parts and tools are accounted for. Please retain these installation instructions for future reference and parts ordering information.

## KIT CONTENTS

This Kit includes:

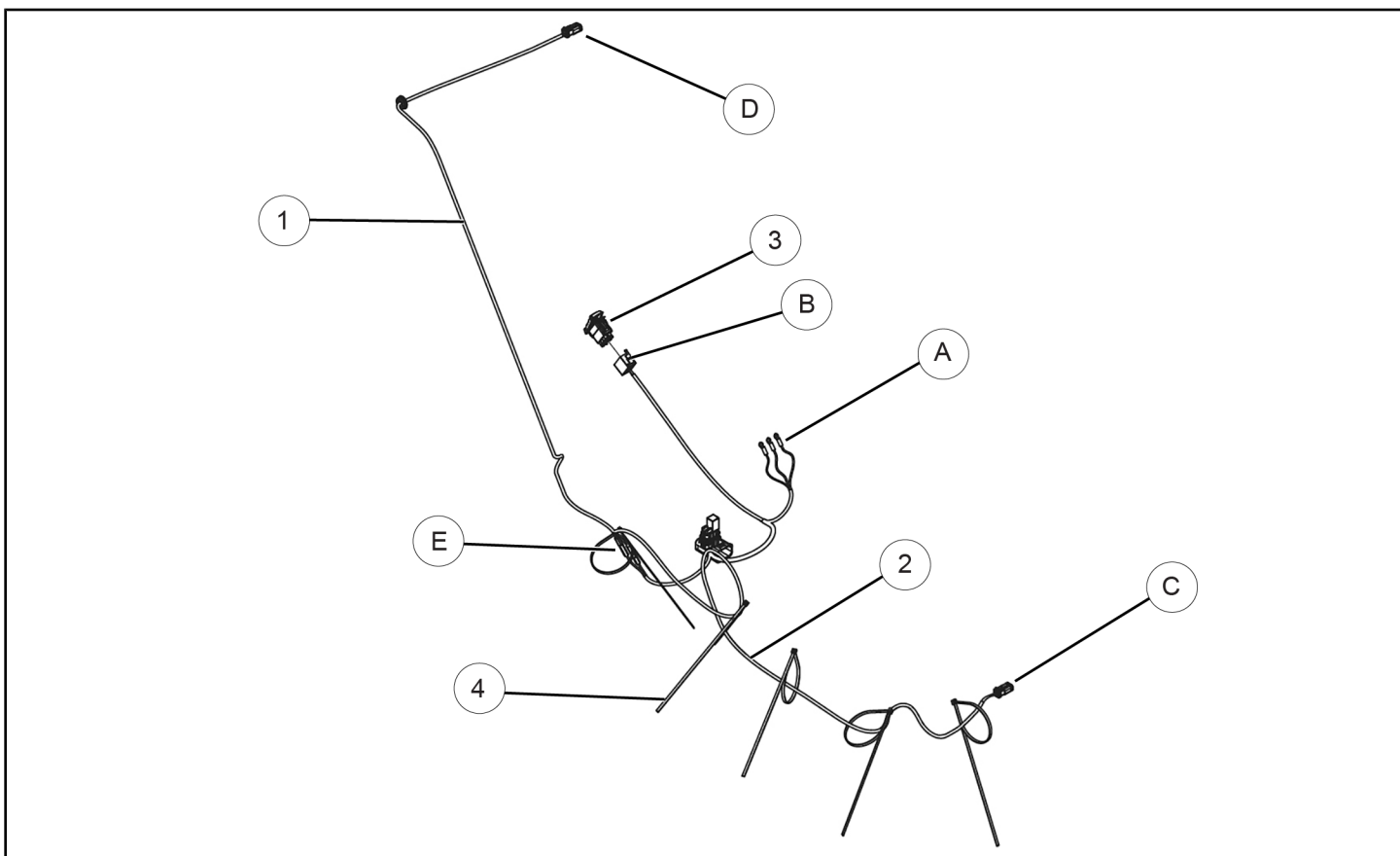

REF	QTY	PART DESCRIPTION	PART NUMBER
1	1	Light Harness Accessory, ROPS	2412616
2	1	Light Harness, DASH	2412608
3	1	Light Switch, Accessory	4014558
4	5	Cable Tie, 11"	7080492
	1	Instructions	9924593

**\*\*Balloons (A), (B), (C), (D), (E) represent specific ends of the harness that will be used throughout the installation process.\*\***

### NOTE

This kit contains parts for installation of the Light Bar Harness Kit PN 2879859 only. Full installation of this kit may also require the purchase of Bus Bar Harness Kit PN 2879862.

### IMPORTANT

Light Harness (PN 2879859) works only for Light.  
The Deluxe Harness Kit (PN 2879865) includes harness accessory, ROPS (PN 2412611) and DASH Harness Accessory (PN 2412612) and works for radio and two overhead lights.

The following are compatible Light Kits available for use with Light Hanress PN 2879859 and Deluxe Light harness PN 2879865:

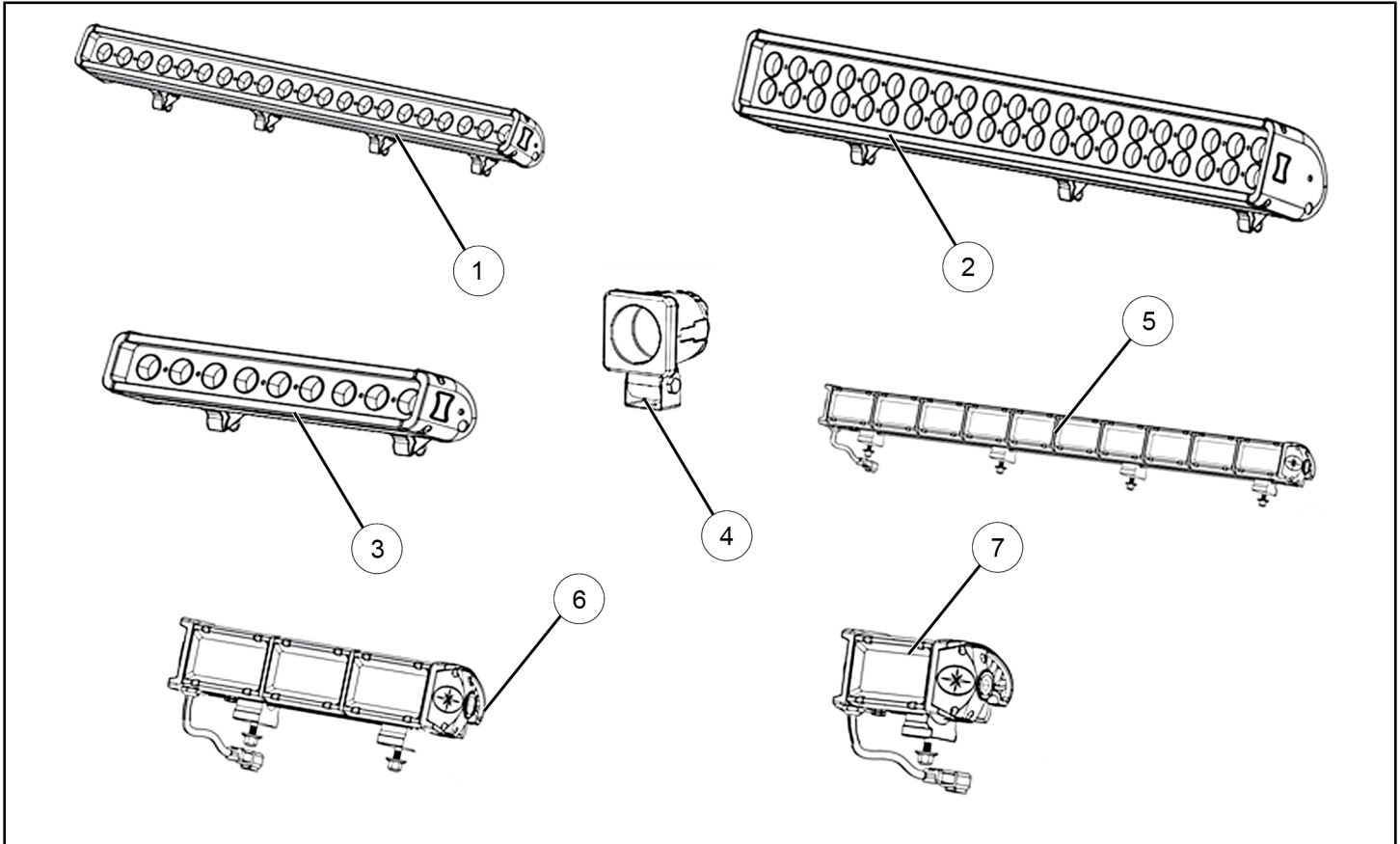

#### Kit PN 2879499: Light 27" Single Row LED Kit

REF	QTY	PART DESCRIPTION	PART NUMBER
1	1	Light 27" Single Row LED Kit	2879499
a	1	Light 27" Single Row LED	4014537
b*	4	Screw-HXFL-M6X1.0X60	-
c*	4	Nut-Nylock-M6X1.0	-
d*	4	Flat Washer-M6	-
e*	4	Upper Mount Rubber Clamp	-
f*	4	Upper Mount Aluminum Clamp	-

Items marked (\*) are included in Hardware Kit PN 2205207.

**Kit PN 2879858: Light 27" Dual Row LED Kit**

REF	QTY	PART DESCRIPTION	PART NUMBER
2	1	Light 27" Dual Row LED Kit	2879858
a	1	Light 27" Dual Row LED	4014536
b*	3	Screw-HXFL-M6X1.0X60	-
c*	3	Nut-Nylock-M6X1.0	-
d*	3	Flat Washer-M6	-
e*	3	Upper Mount Rubber Clamp	-
f*	3	Upper Mount Aluminum Clamp	-

Items marked (\*) are included in Hardware Kit PN 2205207.

**Kit PN 2879500: Light 12" LED Kit**

REF	QTY	PART DESCRIPTION	PART NUMBER
3	1	Light 12" LED Kit	2879500
a	1	Light 12" LED	4014538
b*	2	Screw-HXFL-M6X1.0X60	-
c*	2	Nut-Nylock-M6X1.0	-
d*	2	Flat Washer-M6	-
e*	2	Upper Mount Rubber Clamp	-
f*	2	Upper Mount Aluminum Clamp	-

Items marked (\*) are included in Hardware Kit PN 2205207.

**Kit PN 2879501: Light 2" LED Kit**

REF	QTY	PART DESCRIPTION	PART NUMBER
4	1	Light 2" LED Kit	2879501
a	1	Light 2" LED	4014539
b*	1	Screw-HXFL-M6X1.0X20	-
c*	1	Screw-HXFL-M6X1.0X35	-
d*	1	Lock Nut-M6X1.0	-
e*	1	Cast Steel Mount	-
f*	1	Stainless Steel Bracket-14GA	-

Items marked (\*) are included in Hardware Kit PN 2205209.

**Kit PN 2879502: Light 33" 10W LED Kit**

REF	QTY	PART DESCRIPTION	PART NUMBER
5	1	Light 33" 10W LED Kit	2879502
a	1	Light 33" 10W LED	4014540
b*	1	Screw-HXFL-M6X1.0X60	-
c*	1	Nut-Nylock-M6X1.0	-
d*	1	Flat Washer-M6	-
e*	1	Aluminum Flat Mount	-
f*	1	Aluminum Round Mount	-

Items marked (\*) are included in Hardware Kit PN 2205210.

**Kit PN 2879787: Light 11" 10W LED Kit**

REF	QTY	PART DESCRIPTION	PART NUMBER
6	1	Light 11" 10W LED Kit	2879787
a	1	Light 11" 10W LED	4014541
b*	1	Screw-HXFL-M6X1.0X60	-
c*	1	Nut-Nylock-M6X1.0	-
d*	1	Flat Washer-M6	-
e*	1	Aluminum Flat Mount	-
f*	1	Aluminum Round Mount	-

Items marked (\*) are included in Hardware Kit PN 2205210.

**Kit PN 2879744: Light 5" 10W LED Kit**

REF	QTY	PART DESCRIPTION	PART NUMBER
7	1	Light 5" 10W LED Kit	2879744
a	1	Light 5" 10W LED	4014542
b*	1	Screw-HXFL-M6X1.0X60	-
c*	1	Nut-Nylock-M6X1.0	-
d*	1	Flat Washer-M6	-
e*	1	Aluminum Flat Mount	-
f*	1	Aluminum Round Mount	-

Items marked (\*) are included in Hardware Kit PN 2205210.

## TOOLS REQUIRED

- Safety Glasses
- Drill
- Drill Bit: 1/4"
- Socket Set, Metric
- Socket Set, Torx® Bit
- Torque Wrench
- Wrench Set, Metric

## IMPORTANT

Your LIGHT HARNESS KIT is exclusively designed for your vehicle. Please read the installation instructions thoroughly before beginning. Installation is easier if the vehicle is clean and free of debris. For your safety, and to ensure a satisfactory installation, perform all installation steps correctly in the sequence shown.

## ASSEMBLY TIME

Approximately 30 minutes

### NOTE

Additional time may be required for optional steps, or to accommodate other installed accessories.

## INSTALLATION INSTRUCTIONS

### LIGHT HARNESS INSTALLATION

1. Shift vehicle transmission into "PARK". Turn key to "OFF" position and remove from vehicle.
2. Remove drivers seat.
3. Disconnect both battery cables (F). Disconnect the black negative (-) cable **FIRST**, then disconnect the red positive (+) cable from battery.

### ⚠ WARNING

**ALWAYS** disconnect black negative (-) cable from battery **FIRST**. Failure to comply will result in high current electrical arc, and may result in battery explosion, if tool touches grounded frame. Death or serious personal injury may occur.

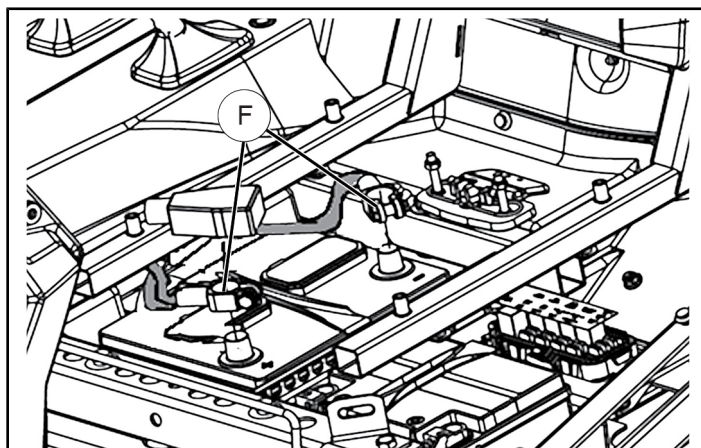

4. Rotate and pull the two knobs (G) to remove the hood from the vehicle.

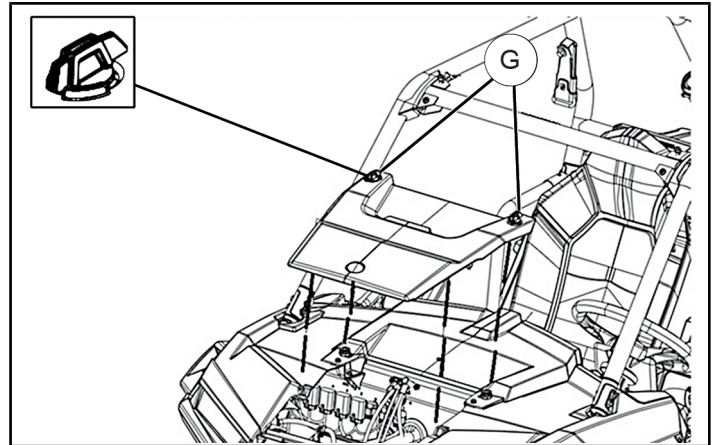

5. Route the ROPS harness accessory (1) (PN 2412616) through the hole in upper part of the right hand ROPS tube, so that other end of cable (E) comes out from coupler (H) welded to the tube

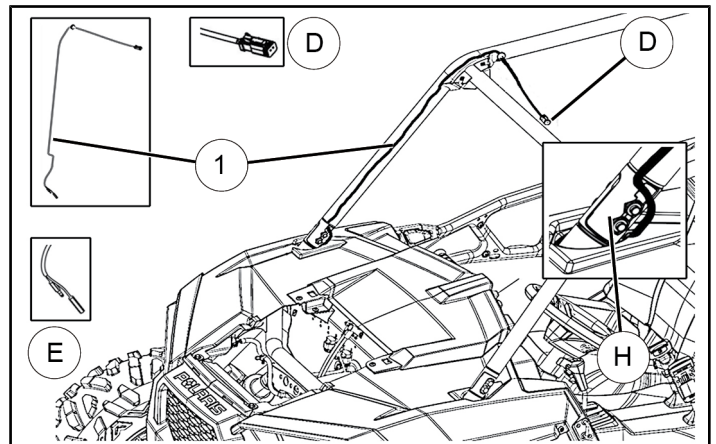



6. Route end ⑤ of harness accessory, ROPS (PN 2412616) coming out of the coupler through the slot provided in the right hand lower front fender.
7. Insert the relay of the light harness, DASH (PN 2412608) into the main firewall at position Acc 2. To do so you will need to drill a 1/4" (6mm) hole in position 2 as shown.

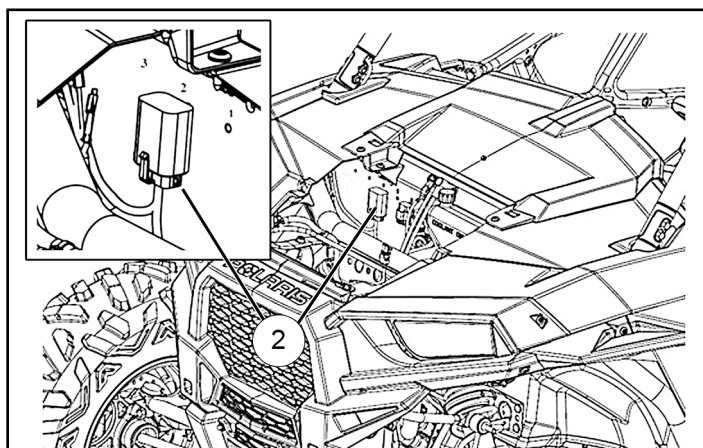

8. Connect end ⑤ of harness accessory ①, ROPS (PN 2412616) to end ⑥ of harness accessory ②, DASH (PN 2412608).

#### NOTE

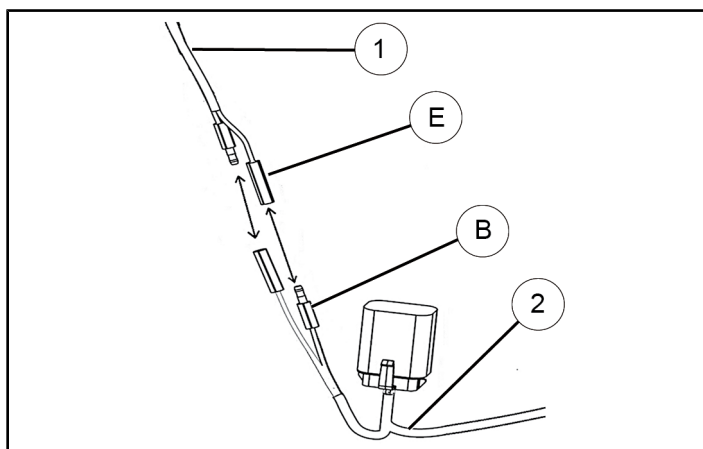

9. Install end ① of the DASH Harness ② (PN 2412608) to the bus bar terminals in the following order. The orange wire connects to the accessory terminal ①. The brown wire connects to the ground terminal ③. The red wire connects to the battery terminal ④.

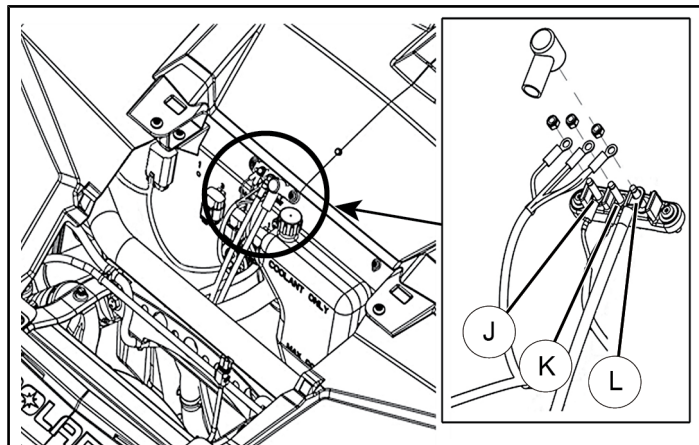

10. Remove the two M6 screws ⑤ and remove the upper panel ⑥ as shown.

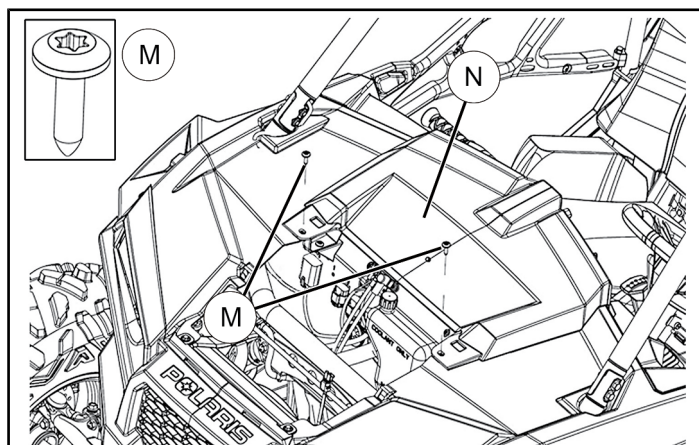

11. Cut one rectangular shape ⑦ to the specified highlighted area through scribe outline on backside of upper panel with a utility knife.

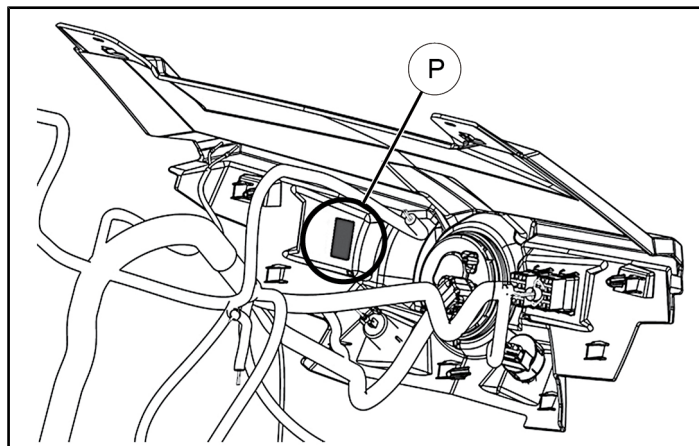

12. Route end ③ of the DASH Harness ② (PN 2412608) through the grommet ① provided on the main firewall ④.

13. Insert the connector through the upper panel slot.

#### IMPORTANT

Ensure the flange of the connector ⑤ is facing bottom side while inserting the connector.

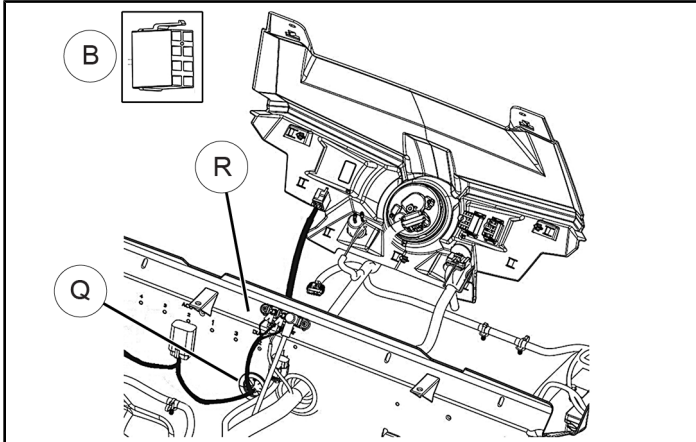

14. Connect the light switch ③ into the connector fitted on the dash control panel.

#### IMPORTANT

Ensure the orientation of the switch as per requirement.

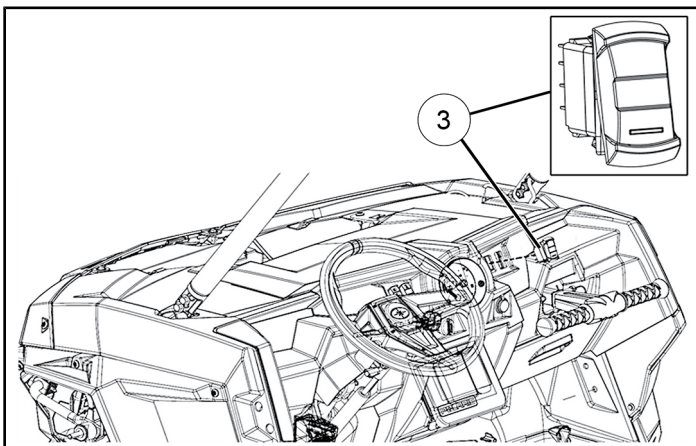

15. Install the upper panel removed in Step 10.

#### NOTE

Ensure that all the electrical connections are restored properly.

16. Reconnect the battery cables. Connect the red positive (+) battery cable **FIRST**. Then connect the black negative (-) cable to the battery.

#### ⚠ WARNING

When BOTH battery cables are disconnected **ALWAYS** reconnect AND tighten red positive (+) cable to battery **FIRST**. Failure to comply will result in high current electrical arc, and may result in battery explosion, if tool touches grounded frame. Death or serious personal injury may occur.

17. Attach the center hood, seat and upper trim removed at beginning of installation.

#### LIGHT BAR MOUNTING INSTRUCTIONS

1. Install the light ⑥ using four M6 hex nuts ⑦ to the specified location.

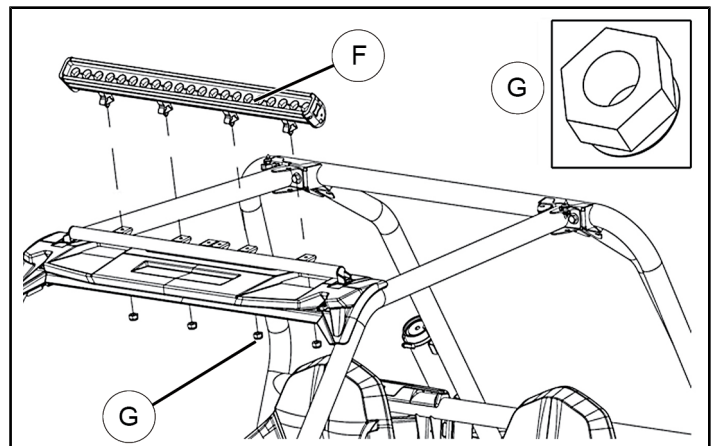

2. Connect the connector ⑧ (PN 2412616) to the light connector ⑨.

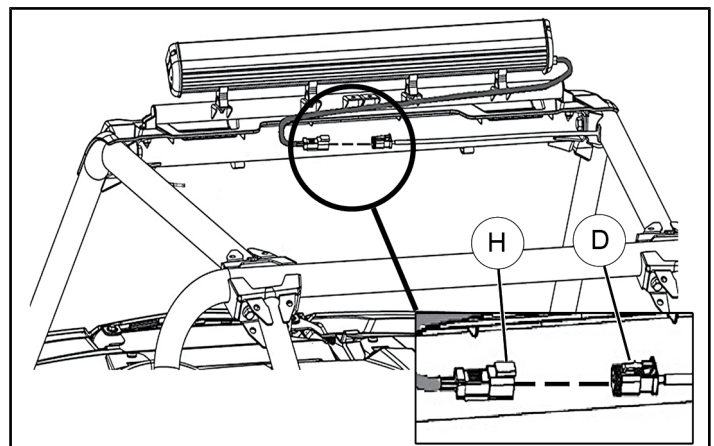

## INSTALLATION INSTRUCTIONS FOR ALUMINUM ROOF

1. Remove the four screws (F) and detach the aluminum roof (G) from the vehicle.

### NOTE

Retain the fasteners at their place for installing the aluminum roof later.

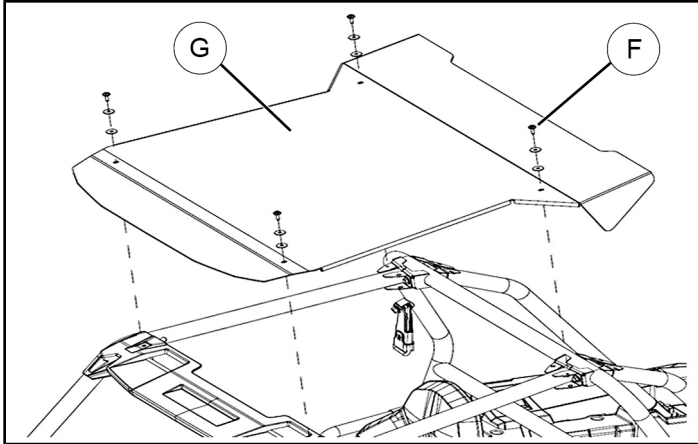

2. Drill the holes in the roof to mount the 27" light bar at specified locations (H).

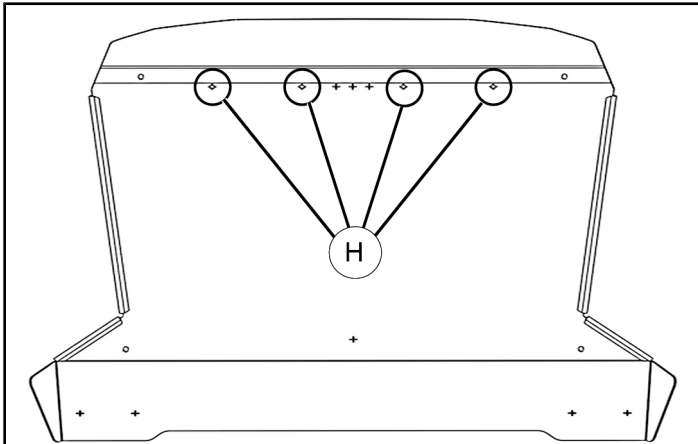

3. Install the light on the aluminum roof and tighten with four M6 nuts and washers as shown.

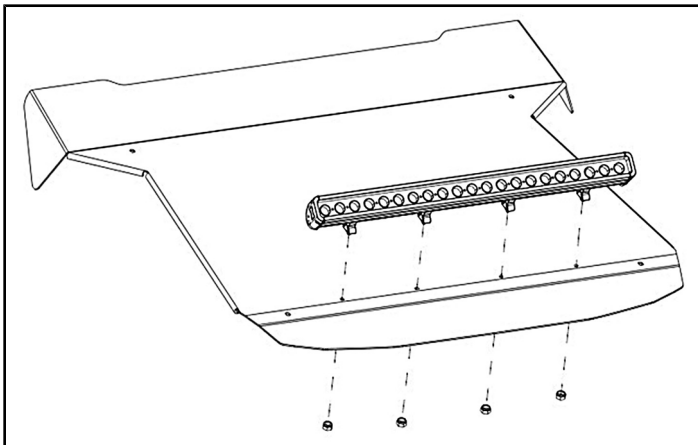

4. Reinstall the aluminum roof once the lights are attached.
5. Drill a hole (J) based on the size of light bar on RHS for harness routing using a 3/4" drill bit.

### NOTE

The harness on light bar has a sliding grommet between light and connector to route the harness through the aluminum roof.

### IMPORTANT

Drilled hole should not be into upper trim and if the hole is not per requirement route the harness around roof and ROPS.

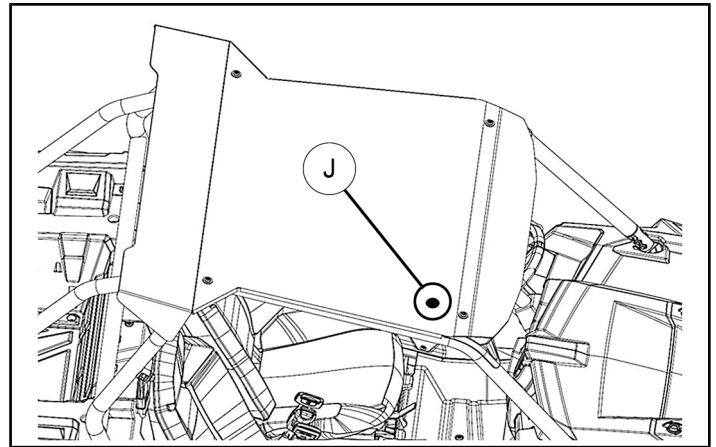

6. Connect the connector (D) (PN 2412616) to the light connector.

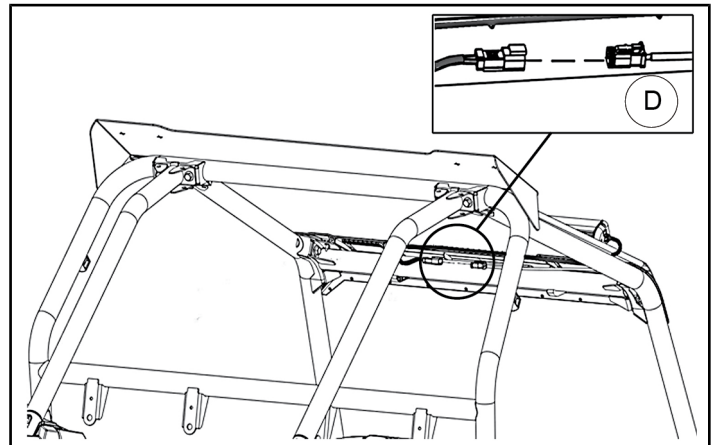



## INSTALLATION INSTRUCTIONS FOR POLY ROOF

1. Remove the two screws ⑥ and detach the poly roof ⑦.

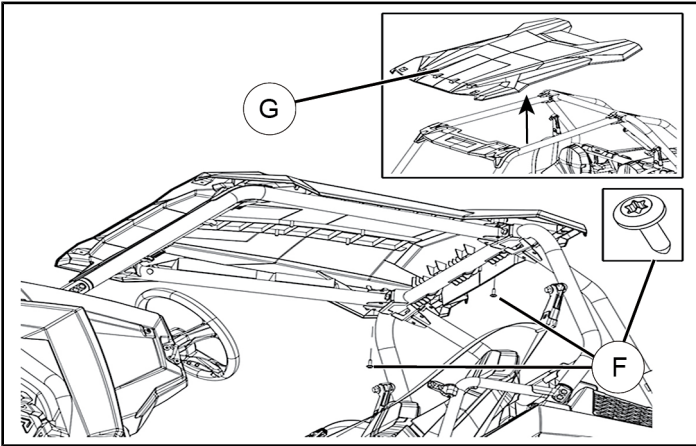

2. Drill the holes ⑧ in the roof to mount the light at specified locations.

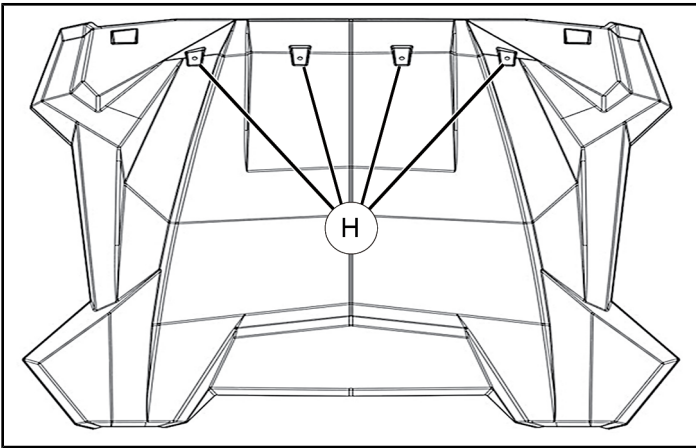

3. Install the light on the poly roof and tighten with four M6 nuts and washers.

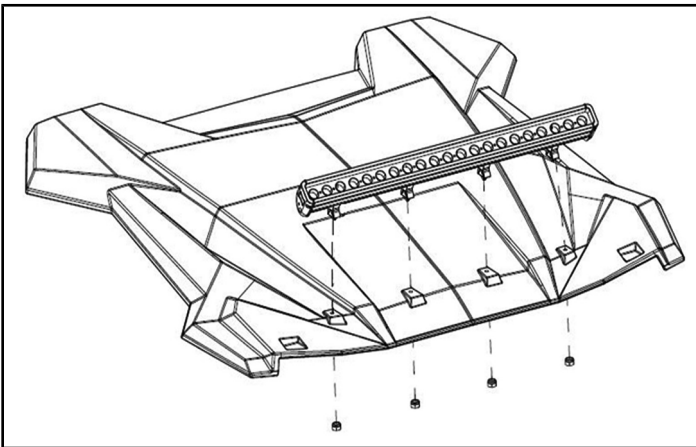

4. Reinstall the poly roof once the lights are attached.
5. Drill a hole ⑩ based on the size of light bar on RHS for harness routing using a 3/4" drill bit.

### NOTE

The harness on light bar has a sliding grommet between light and connector to route the harness through the roof.

### IMPORTANT

Drilled hole should not be into upper trim and if the hole is not per requirement route the harness around roof and ROPS.

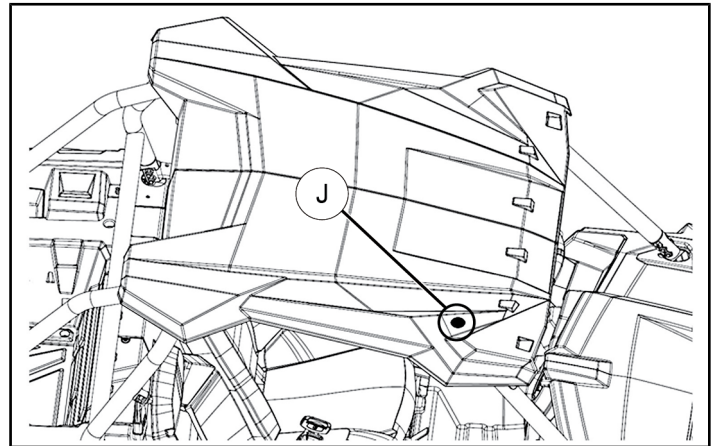

6. Connect the connector ① (PN 2412616) to the light connector.

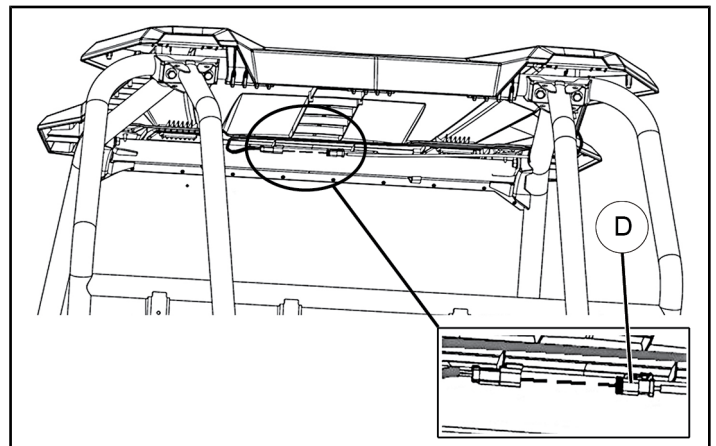

## FEEDBACK FORM

A feedback form has been created for the installer to provide any comments, questions or concerns about the installation instructions. The form is viewable on mobile devices by scanning the QR code or by clicking [HERE](#) if viewing on a PC.

### FEEDBACK FORM

