

# DRAGON HAND GUARDS



**POLARIS**  
The Way Out.®

**KIT P/N: 2876845 Red Hand Guards; 2876846 Black Hand Guards; 2876883 White Hand Guards; 2877122 Billet Mounts**

Before you begin, read these instructions and check to be sure all parts and tools are accounted for. Please retain these installation instructions for future reference and parts ordering information.

**Kit Includes:**  
Hand guards

Qty	Description
1	Right Hand Guard
1	Left Hand Guard

**Billet Mounts**

Ref No.	Qty	Description
1	1	Right Mount
2	1	Left Mount
3	2	Handlebar Clamps
4	2	Hand Guard Brackets
5	2	Allen Head Bolts (M6x1x15L)
6	10	Washers
7	2	Hex Bolts (M6x1x40L-8H)
8	2	Hex Nuts (M6x1)
9	4	Hex Bolts (M5x.8x20L)
	1	Instructions (P/N 9922015)

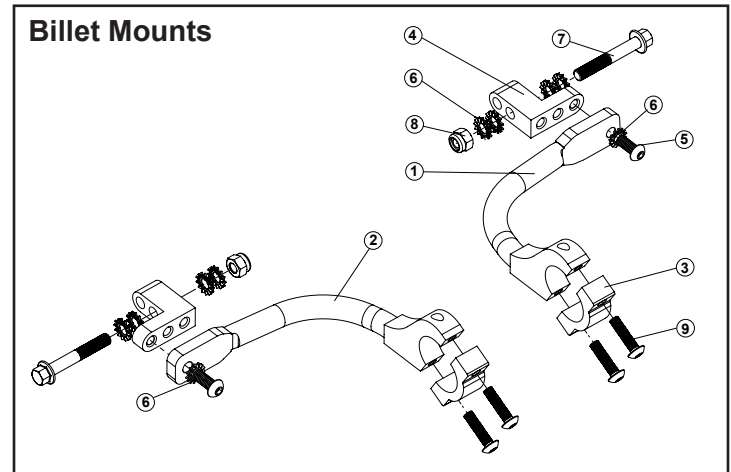

**Tools Required:**

- 4 mm Allen Wrench
- 5 mm Allen Wrench
- 8 mm Socket
- 10 mm Socket

**IMPORTANT:** For your safety, and to ensure a satisfactory installation, perform all installation steps correctly in the sequence as shown on the attached instructions.

**INSTALLATION INSTRUCTIONS**

1. Remove all parts from containers and separate parts for left hand guard, from the parts for right hand guard.
2. Assemble left hand guard to hand guard bracket with the provided M6x1.0x15 mm bolts, M6x1.0 nut and four washers as shown in Photo 1 using inner most hole on hand guard bracket.
3. Repeat Step 2 for the right side.

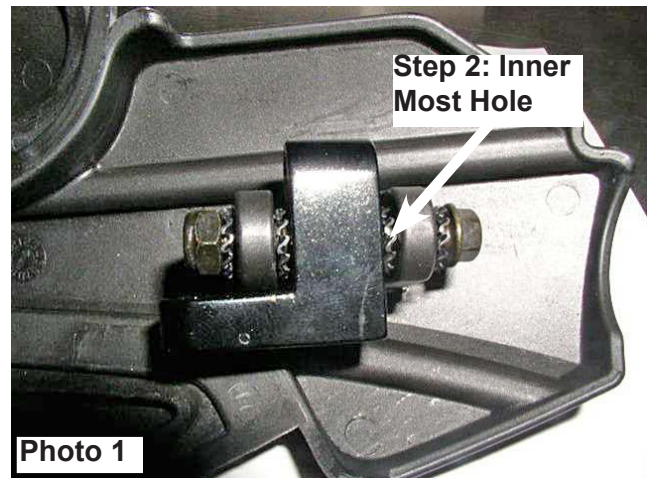

4. Attach the left hand guard and hand guard bracket assembly to the left billet handlebar mount arm with the provided M6x1.0 x 15 mm Allen head bolt (and washer) as shown in Photo 2 using the hole farthest from the L-shape of the hand guard bracket.

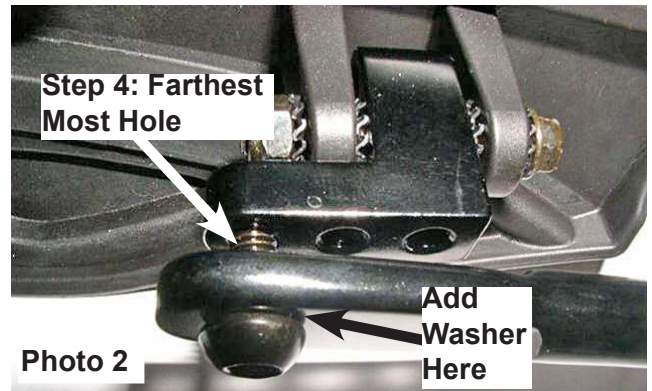

5. Repeat Step 4 for the right side.
6. Remove plastic wire retaining straps from both sides of the handle bar.
7. Install left hand guard assembly on the left side of the handlebar, making sure there are no wires under the clamping area of the hand guard assembly. Tighten fasteners only tight enough to lightly hold assembly in place. Photo 3.
8. Repeat Step 6 for right side.

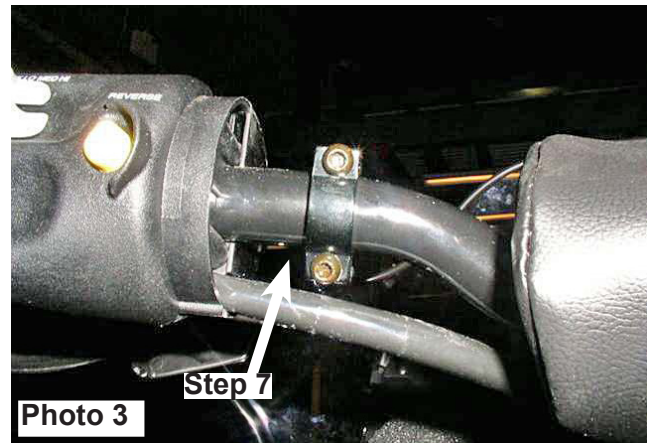

9. Position left hand guard assembly so the outer edge of the plastic guard is even with the outer edge of the handlebar. Photo 4.
10. Rotate assembly on handlebar to center plastic hand guard on the handlebar and tighten the billet hand guard arm clamp fastener securely.
11. Rotate the plastic hand guard on the hand guard bracket so plastic hand guard is straight and tighten fastener securely.
12. Repeat Steps 8-10 for the right side.



13. Install new plastic wire retainer straps on both sides of handle bar. Photo 5.
14. Recheck all fasteners for tightness.

