

EN DOOR KIT INSTALLATION MANUAL

DE MONTAGEEINLEITUNG TÜREN SET



For: Polaris Ranger 150 (2015-)

2889022



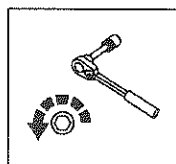

EN Regular fasteners
DE Originale montageteile
RU Штатный крепеж

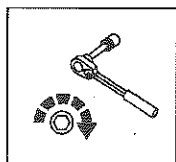

EN Regular fasteners
DE Originale montageteile
RU Штатный крепеж

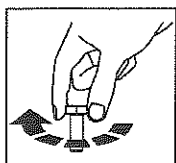

EN Screw several times
DE Für wenigen Umdrehungen befestigen
RU Вкрутить на несколько оборотов

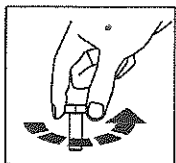

EN Loosen bolts
DE Bolzen lockern
RU Выкрутить на несколько оборотов

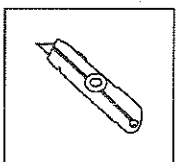

EN Office Knife
DE Büromesser
RU Канцелярский нож

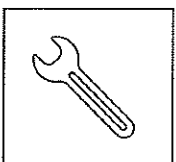

EN Wrench
DE Schraubenschlüssel
RU Гаечный ключ

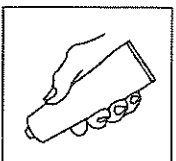

EN Grease
DE Schmierfett
RU Консистентная смазка

	EN Ratchet DE Ratsche RU Трещётка		S - 10; S - 13; S - 17		S - 4; S - 5
--	---	--	------------------------------	--	-----------------

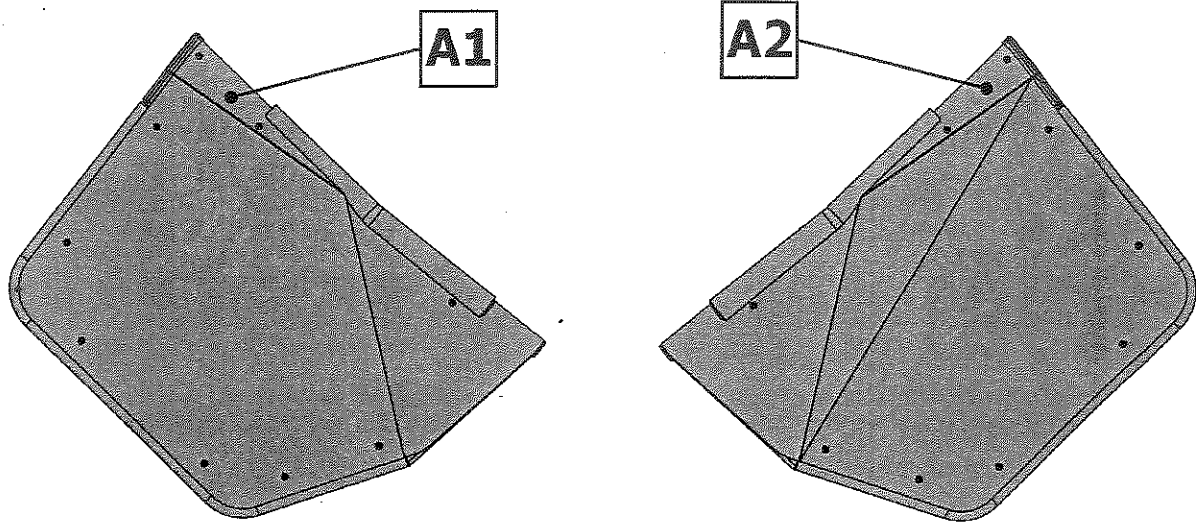

1 x2	2 x2	3 x2	4 x2	5 M10 x4	6 Ø6 x8
7 x2	8 UNC 3/8"x1 3/4" x4	9 Ø8 x4	10 x4	11 M6x16 x4	12 M6x40 x2
13 Ø6 x6	14 M6x25 x8	15 x2	16 x4	17 x2	18 x4
19 M8x40 x2	20 M8 x2	21 M10 x2			

PRE-INSTALLATION: LAY OUT COMPONENTS AND COMPARE TO LIST AND IMAGES. IMAGES MAY NOT PORTRAY THE FULL DETAIL OR EXACT SHAPE OF THE PARTS; HOWEVER, THEY REPRESENT PARTS THAT HAVE SAME OR SIMILAR FUNCTION.

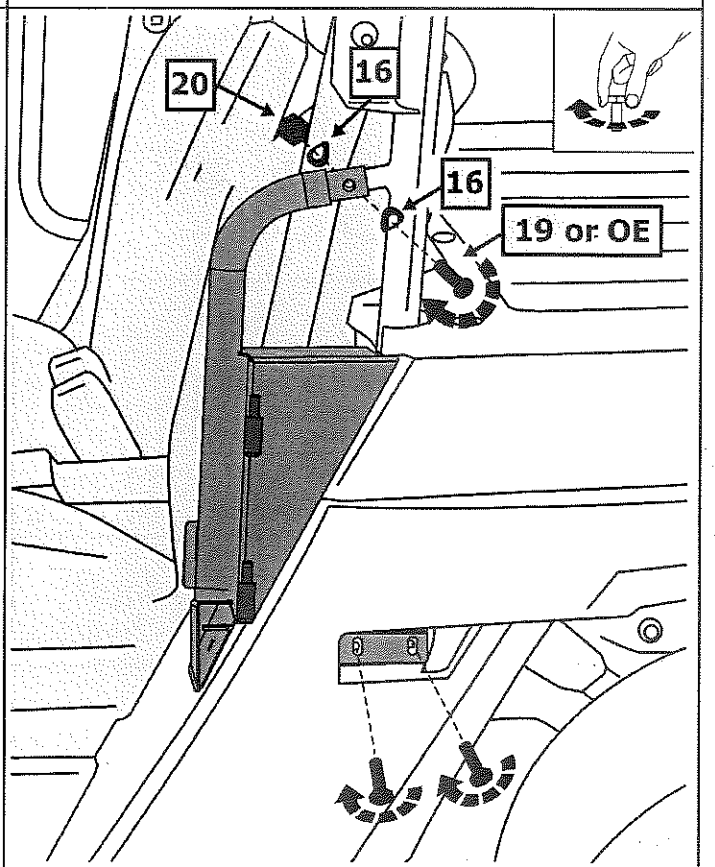
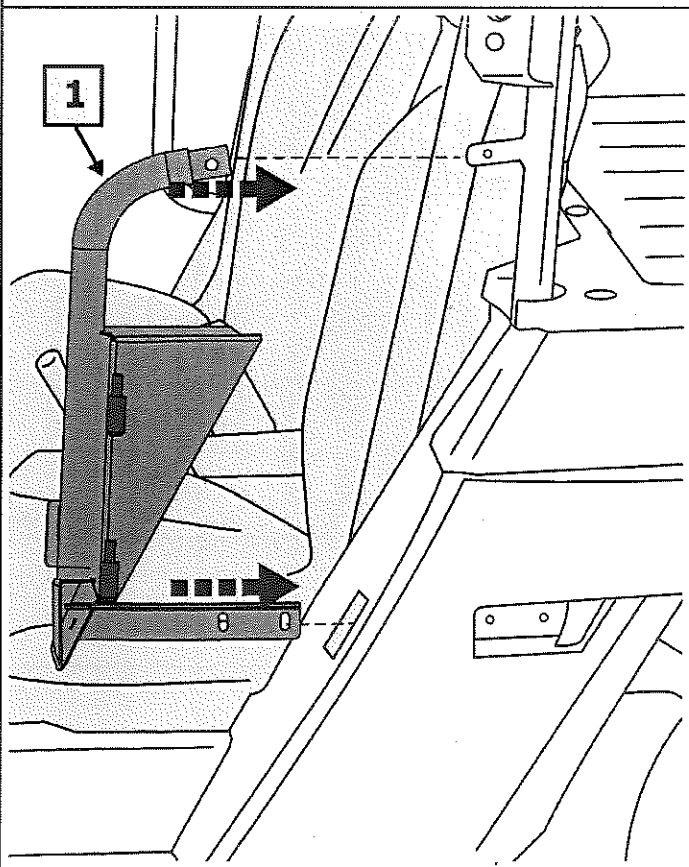
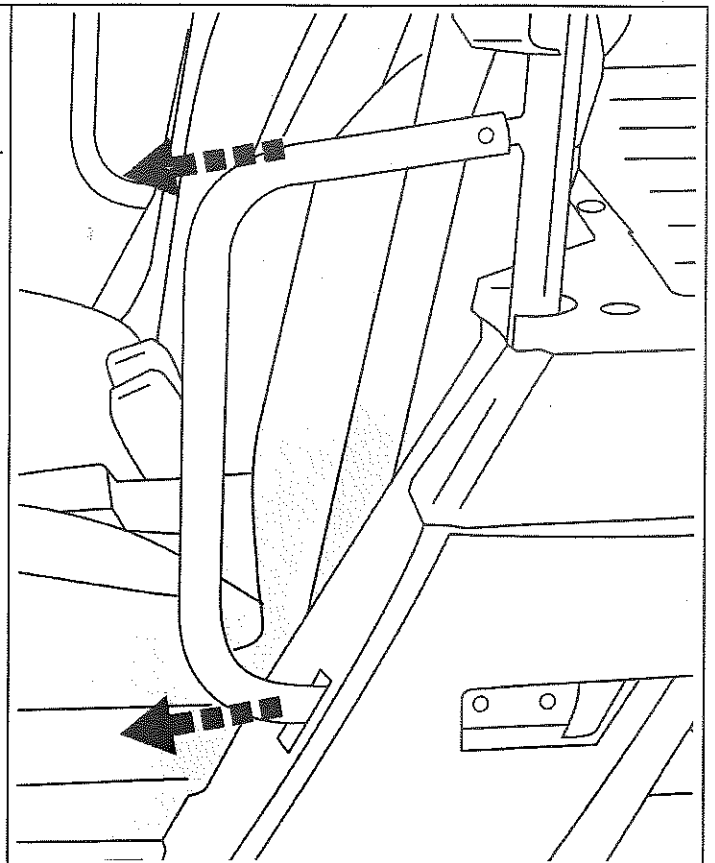
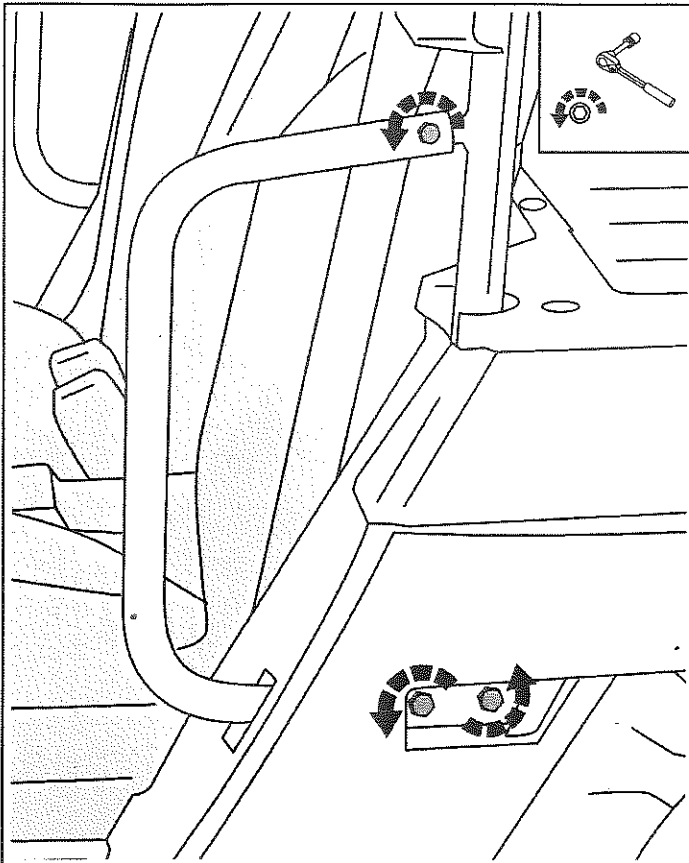

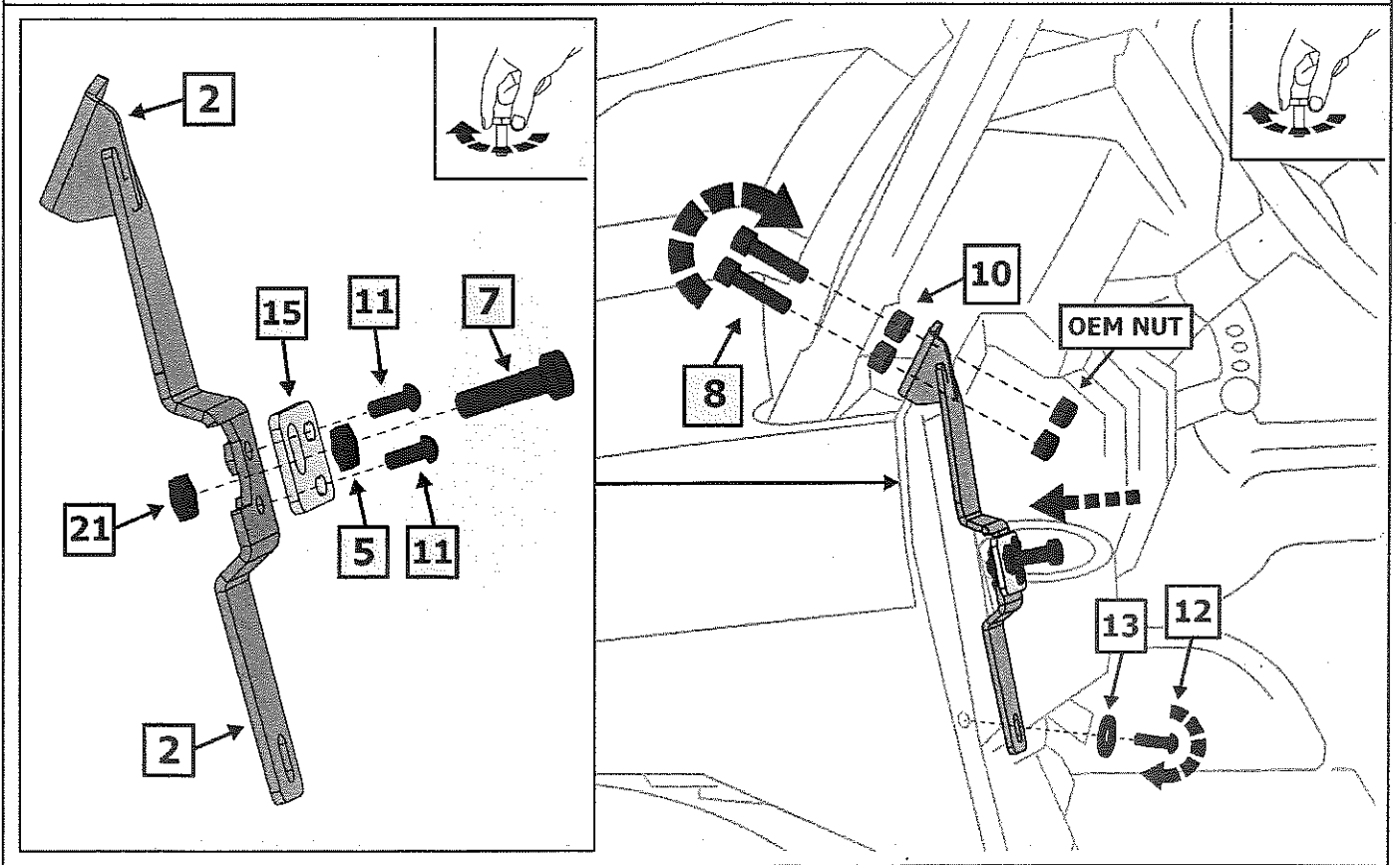
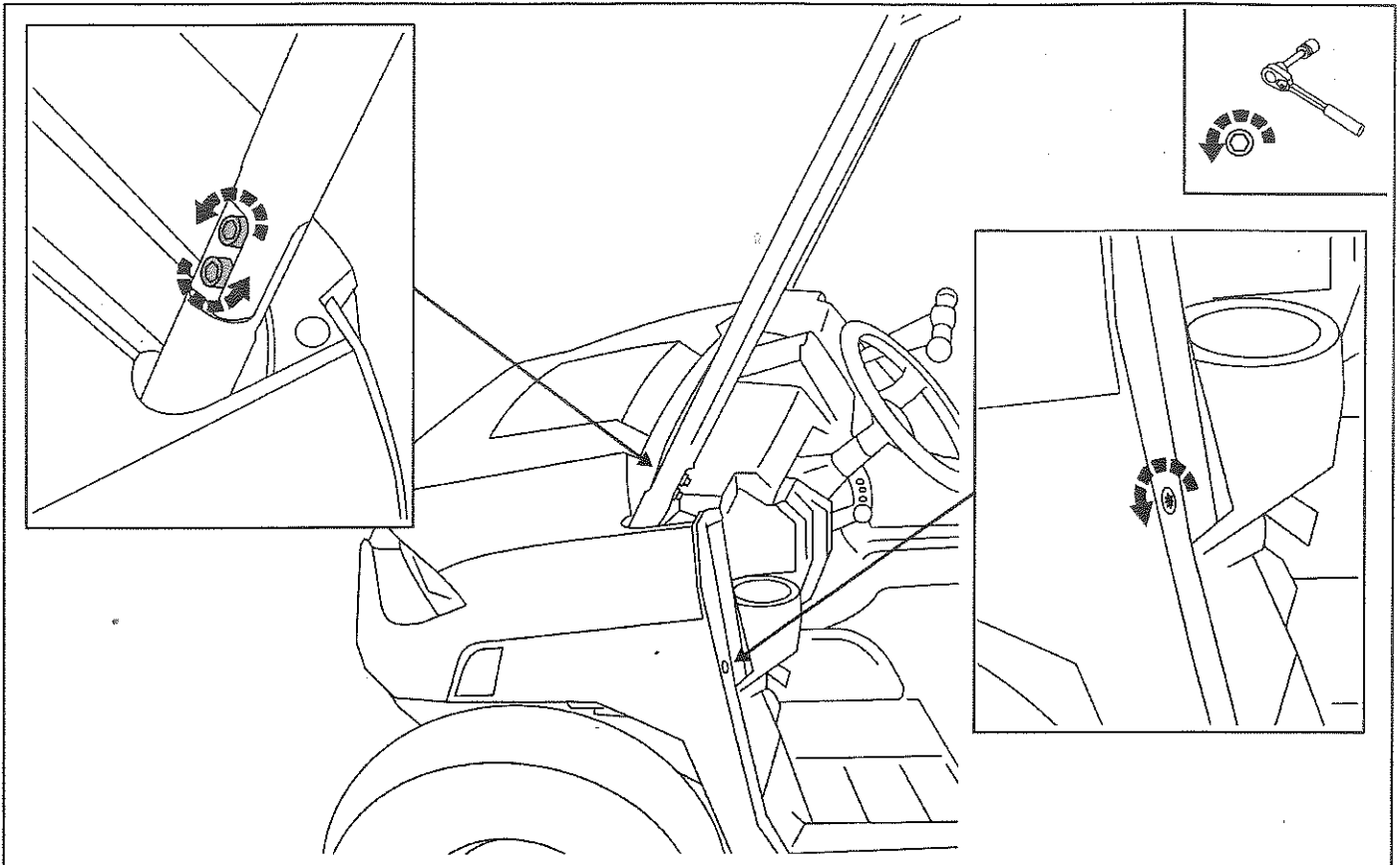

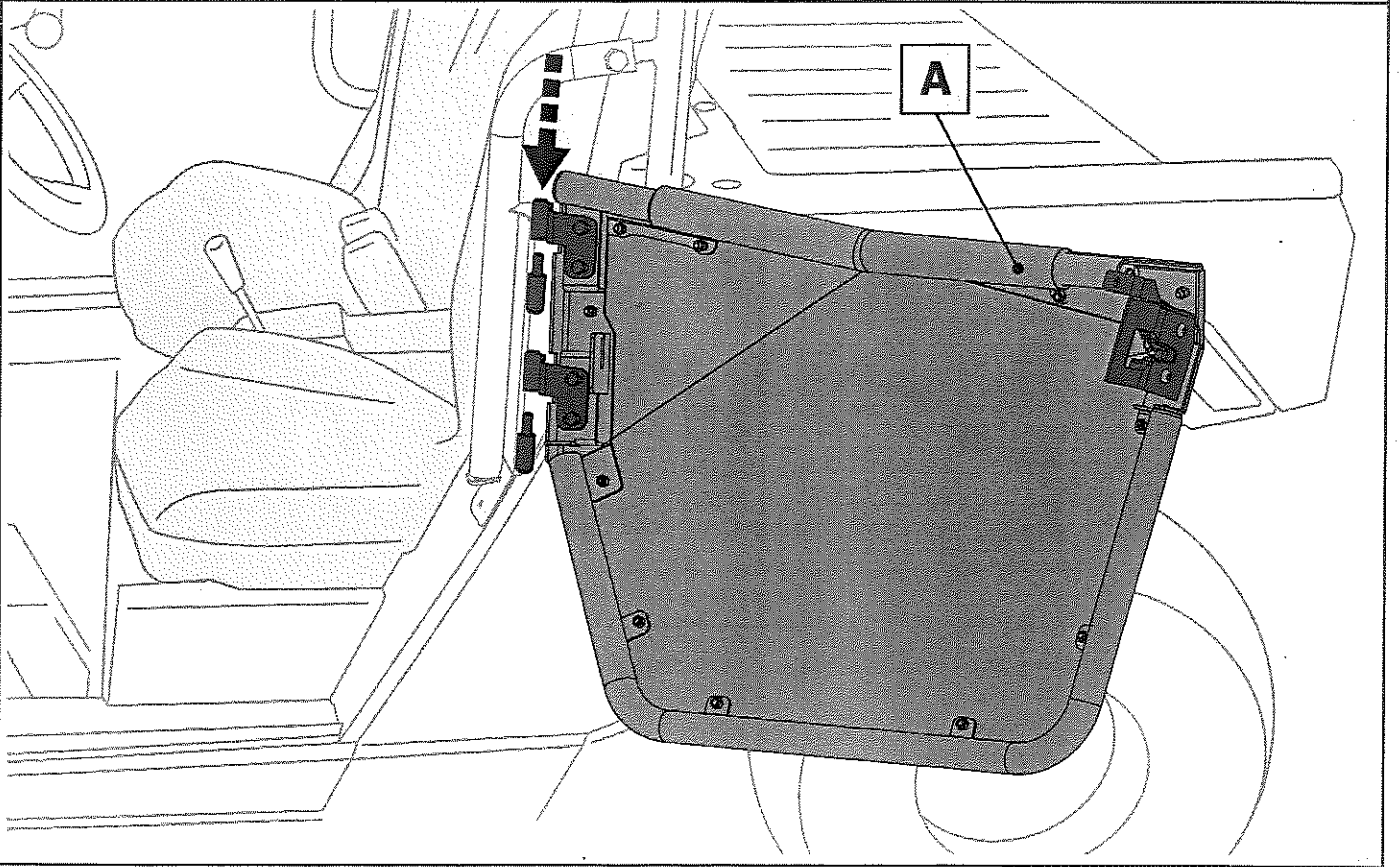
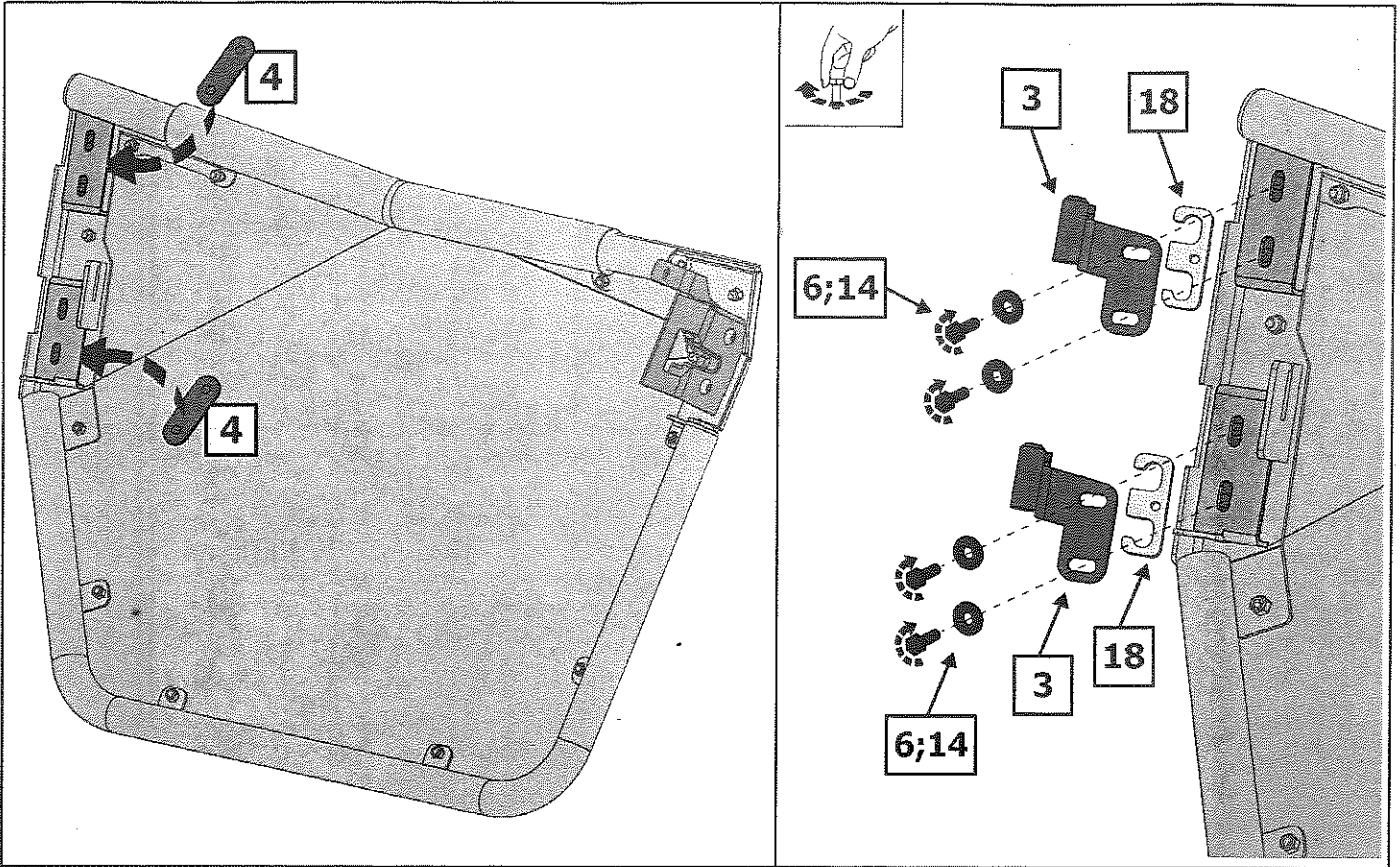

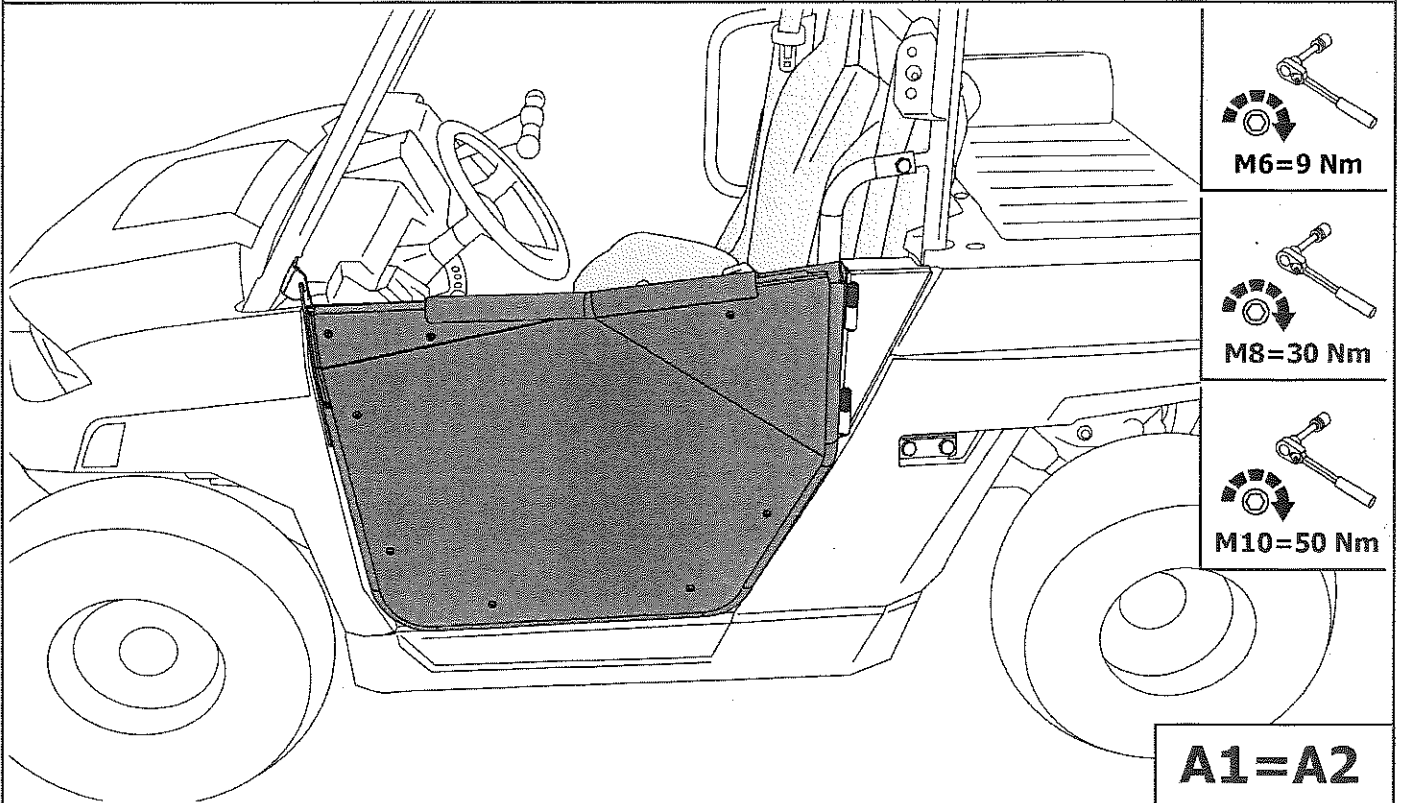
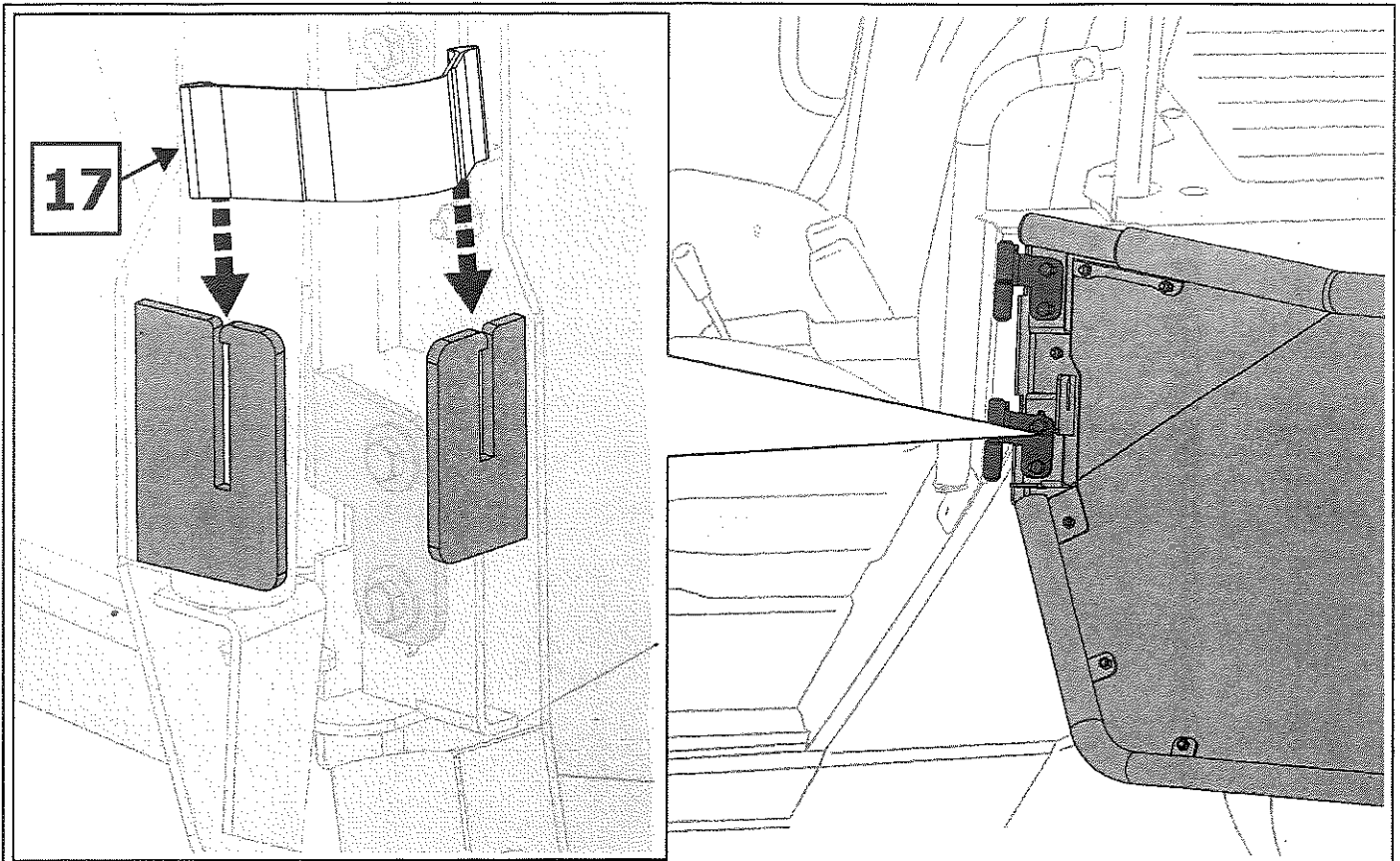

TIP: PERIODICALLY CHECK ALL HARDWARE AND RE-TIGHTEN IF NEEDED.