

# CREW ROOF HOLE TEMPLATE

KIT PN 2878755



**Application** Polaris Ranger

Before you begin, read these instructions and check to be sure all parts and tools are accounted for. Please retain these installation instructions for future reference and parts ordering information.

## Kit Components:

<u>QTY.</u>	<u>Part Description</u>	<u>Tools Needed</u>
1	Right Template	9/32 Drill Bit
1	Left Template	Power Drill
		Scissors

**IMPORTANT:** Your Polaris accessory kit is exclusively designed for your Polaris vehicle. Please read the installation instructions and operator's manual thoroughly before beginning. Installation of any item is easier if the vehicle is clean and free of debris.

**Approximate Installation Time:** 20 Minutes

## INSTALLATION INSTRUCTIONS

1. Cut out the right and left paper templates on the attached page.
2. Align the paper templates with the edge of the rear roof panel as shown below.
3. Mark the template holes onto the rear roof panel.
4. Remove paper templates, and drill holes using a 9/32" drill bit.
5. Refer to the crew roof installation instructions to install roof to vehicle.

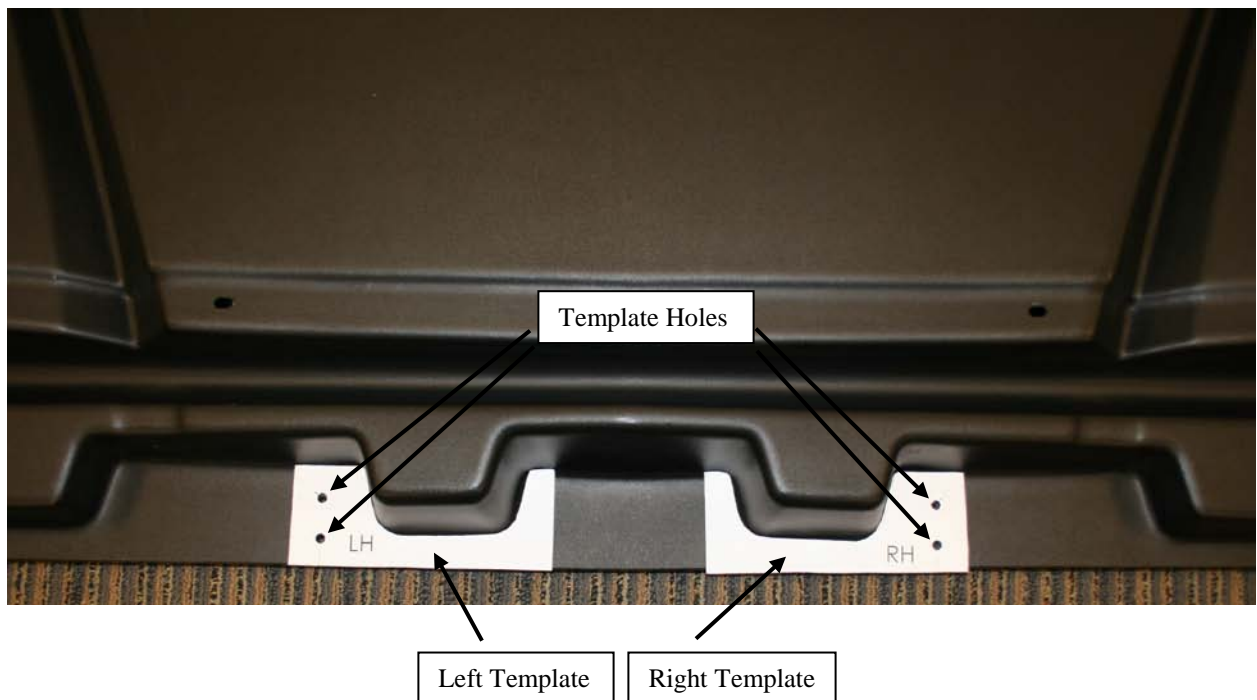

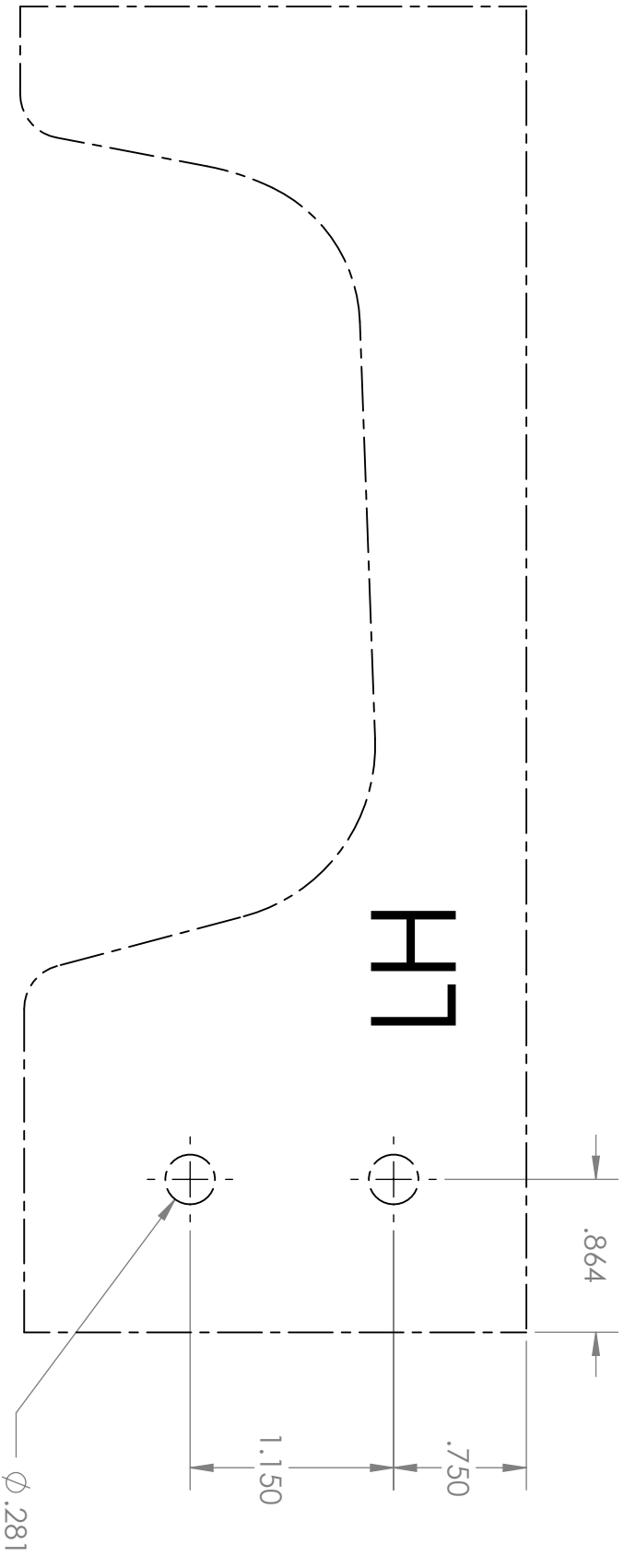
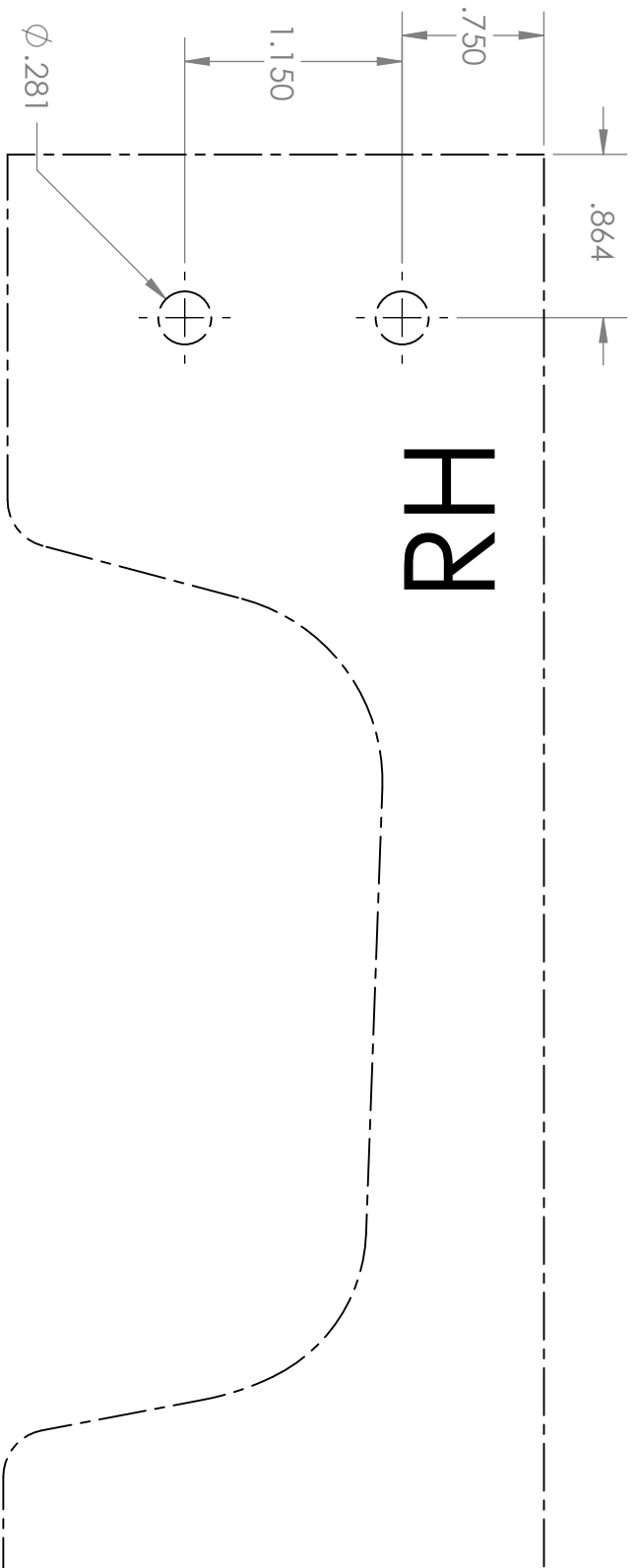

CUT ALONG DOTTED LINE AND USE AS TEMPLATE TO DRILL HOLES.